

NO.	PART NAME	PART #	REQ'D	MATERIAL
1	QUICK CONNECT ADAPTER 3" FLANGED CASTING	K3SBFC	1	ASTM A743 CF8M 316 SS

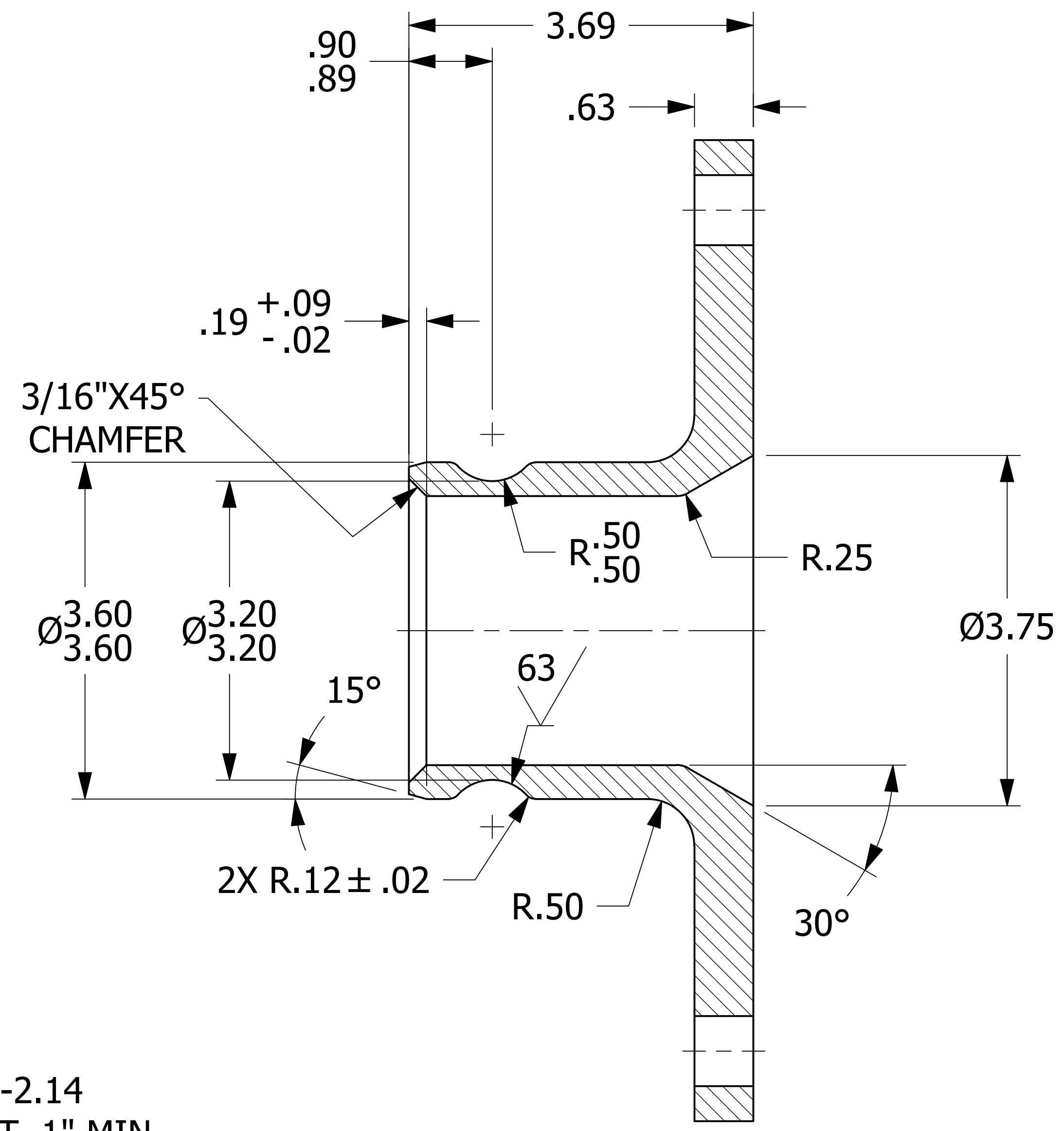
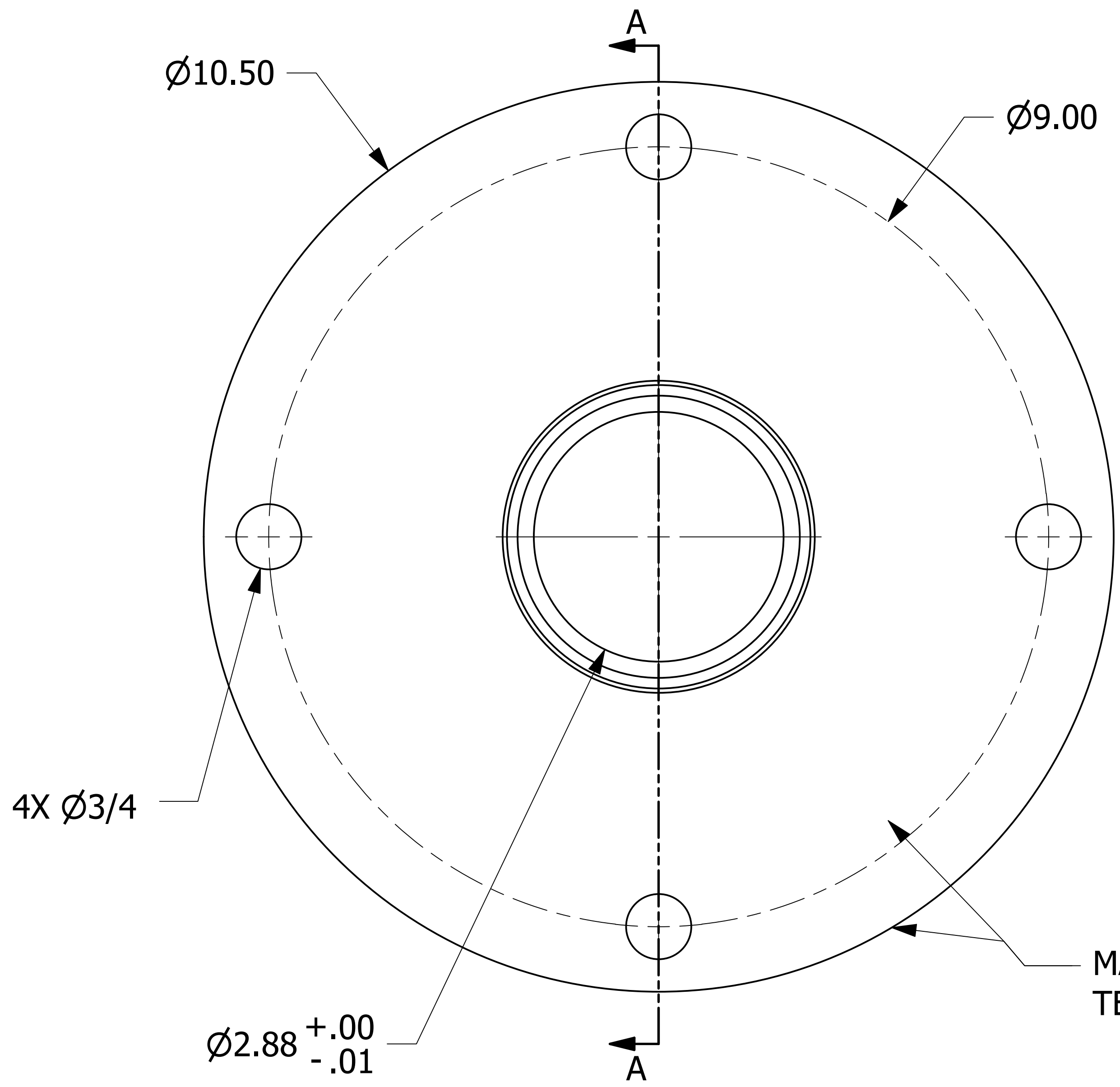

SECTION A-A

- NOTES:
- TEST PER Q-2.15.7.
  - REPAIR BY WELD ONLY, IMPREGNATION NOT ALLOWED.
  - SEE DOCUMENT Q-2.14 FOR MARKING PROCEEDURE.

UNLESS OTHERWISE SPECIFIED DIMENSIONAL TOLERANCES	DRAWN BY:	RPS
FRACTIONAL: $\pm 1/16$	CHECKED BY:	MJW
X.XX: $\pm .03$	PROTOTYPE DATE:	6/27/2023
X.XXX: $\pm .015$	APPROVED FOR PRODUCTION BY:	MJW
ANGULAR: $\pm 1^\circ$	PRODUCTION DATE:	6/30/2023
DEBURR ALL SHARP EDGES. ALL MACHINED SURFACES TO HAVE A 125 RMS FINISH UNLESS NOTED OTHERWISE.	SIZE:	D
THIRD ANGLE PROJECTION	DRAWING #:	13836

REV	BY	DATE	DESCRIPTION
G	CHL	5/7/19	Q-2.14 WAS QAP5A; Q-2.15.7 WAS QAPAC-1; UPDATED WELD NOTES, UPDATED BPM MATERIALS
SEE FINAL SHEET FOR COMPLETE LIST OF DRAWING REVISIONS			

**SALCO PRODUCTS, INC.**  
**QUICK CONNECT ADAPTER 3" FLANGE**

PROJECT #: 961010      SHEET #: 1 OF 2      SCALE: 1:1  
 PART #: **K3SBF**

NO.	PART NAME	PART#	REQ'D	MATERIAL
1	FLANGE 9"X3 3/4"	C40109	1	ASTM A240 316 SS
2	QUICK CONNECT ADAPTER 3"	C40117	1	ASTM A269/A511 UNS S31603

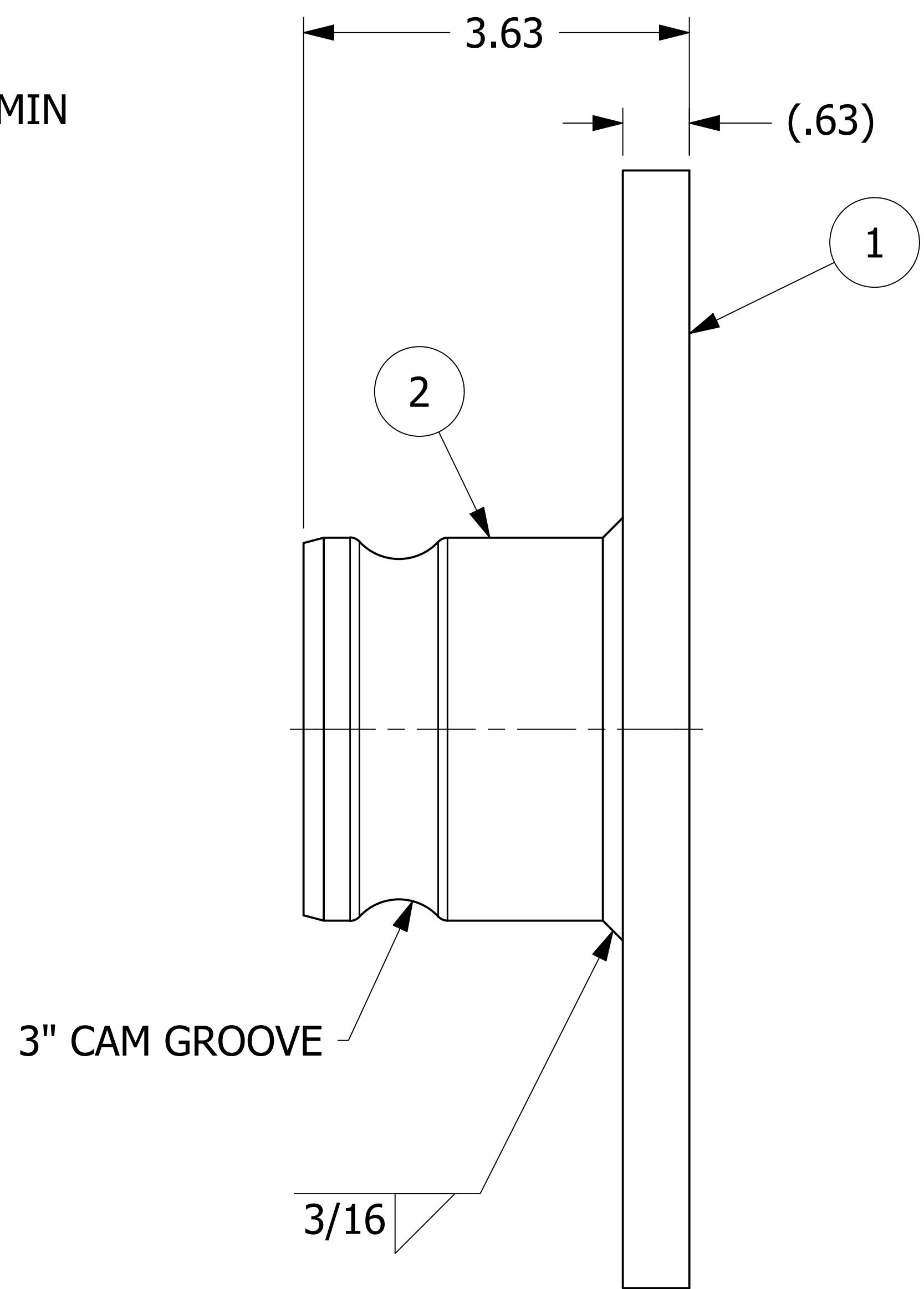
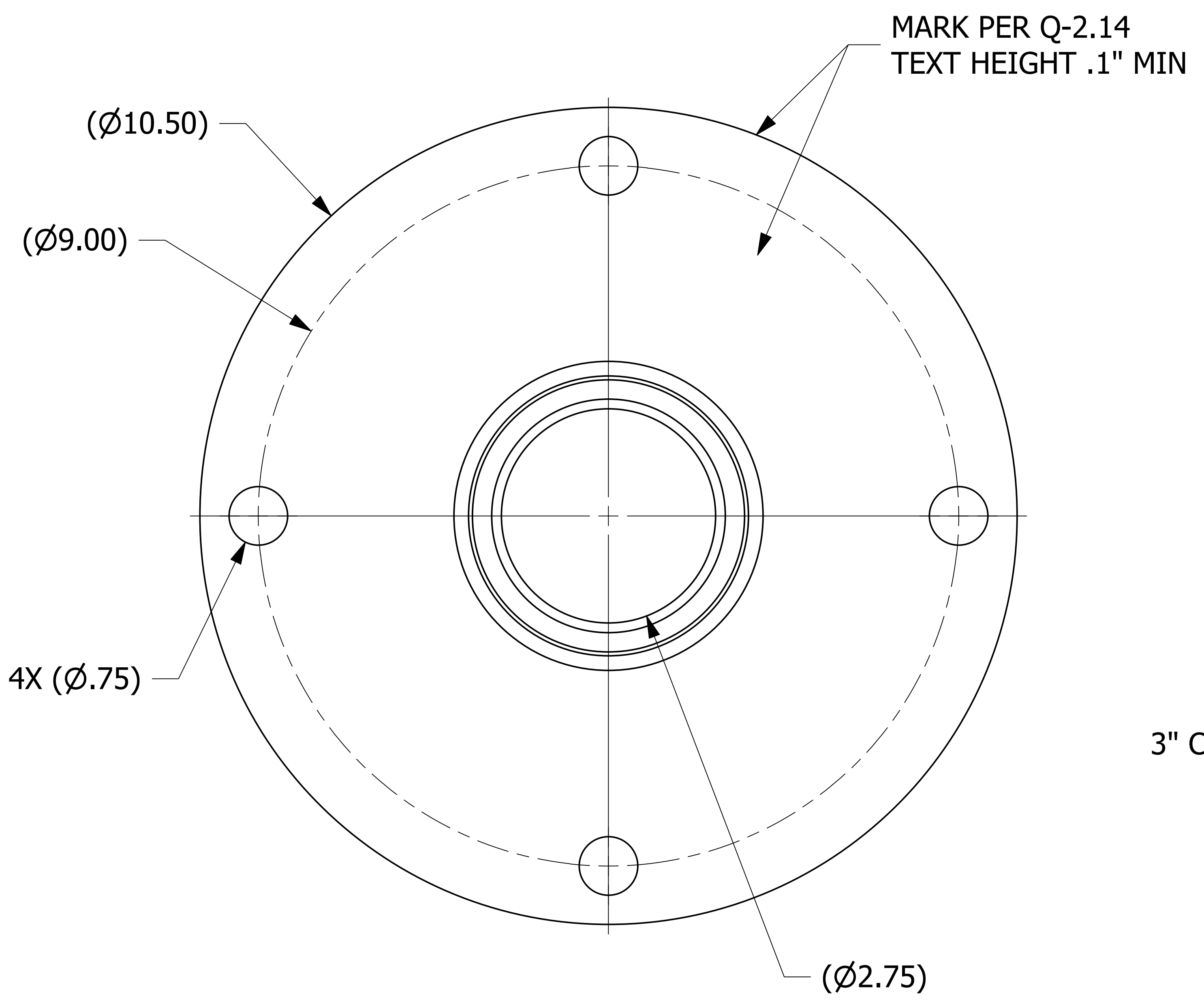

- NOTES:**
- TEST PER Q-2.15.7.
  - REPAIR BY WELD ONLY, IMPREGNATION NOT ALLOWED.
  - SEE DOCUMENT Q-2.14 FOR MARKING PROCEEDURE.

REV	BY	DATE	DESCRIPTION
G	CHL	5/7/19	Q-2.14 WAS QAP5A; Q-2.15.7 WAS QAPAC-1; UPDATED WELD NOTES, UPDATED BPM MATERIALS
F	RJP	10/9/14	ADDED SHEET 2 WITH FABRICATED PART
E	MCH	10/18/11	UPDATED HEAT/LOT # & NOTE
D	REH	4/16/10	ADDED CASTING NOTE
C	BRG	6/9/09	ADDED BOM & UPDATED NOTES
B	FOD	5/9/00	UPDATED NOTES & DRAWING W/ NEW STANDARDS
A	ACC	11/30/99	ADDED TOLERANCE TO ID DIMENSION

UNLESS OTHERWISE SPECIFIED DIMENSIONAL TOLERANCES	DRAWN BY:	RPS
FRACTIONAL: ±1/16	CHECKED BY:	MJW
X.XX: ±.03	PROTOTYPE DATE:	6/27/2023
X.XXX: ±.015	APPROVED FOR PRODUCTION BY:	MJW
ANGULAR: ±1°	PRODUCTION DATE:	6/30/2023
DEBURR ALL SHARP EDGES. ALL MACHINED SURFACES TO HAVE A 125 RMS FINISH UNLESS NOTED OTHERWISE.	SIZE:	D
THIRD ANGLE PROJECTION	DRAWING #:	13836



PART NAME: <b>QUICK CONNECT ADAPTER 3" FLANGE</b>		
MATERIAL:	PROJECT #: <b>961010</b>	SHEET #: <b>2 OF 2</b>
SCALE: <b>1:1</b>	PART #: <b>K3SBF</b>	