

NO.	PART NAME	PART#	REQ'D	MATERIAL
1	ELBOW 3"X90°	3A90SCH40ELB2	1	ALUMINUM
2	HOSE BARB 3"	B19470	1	ALUMINUM
3	PIPE 3" SCH 40	P3A40	.32 FT	ALUMINUM
4	SQUARE FLANGE 3"	PD3ASF	1	ALUMINUM

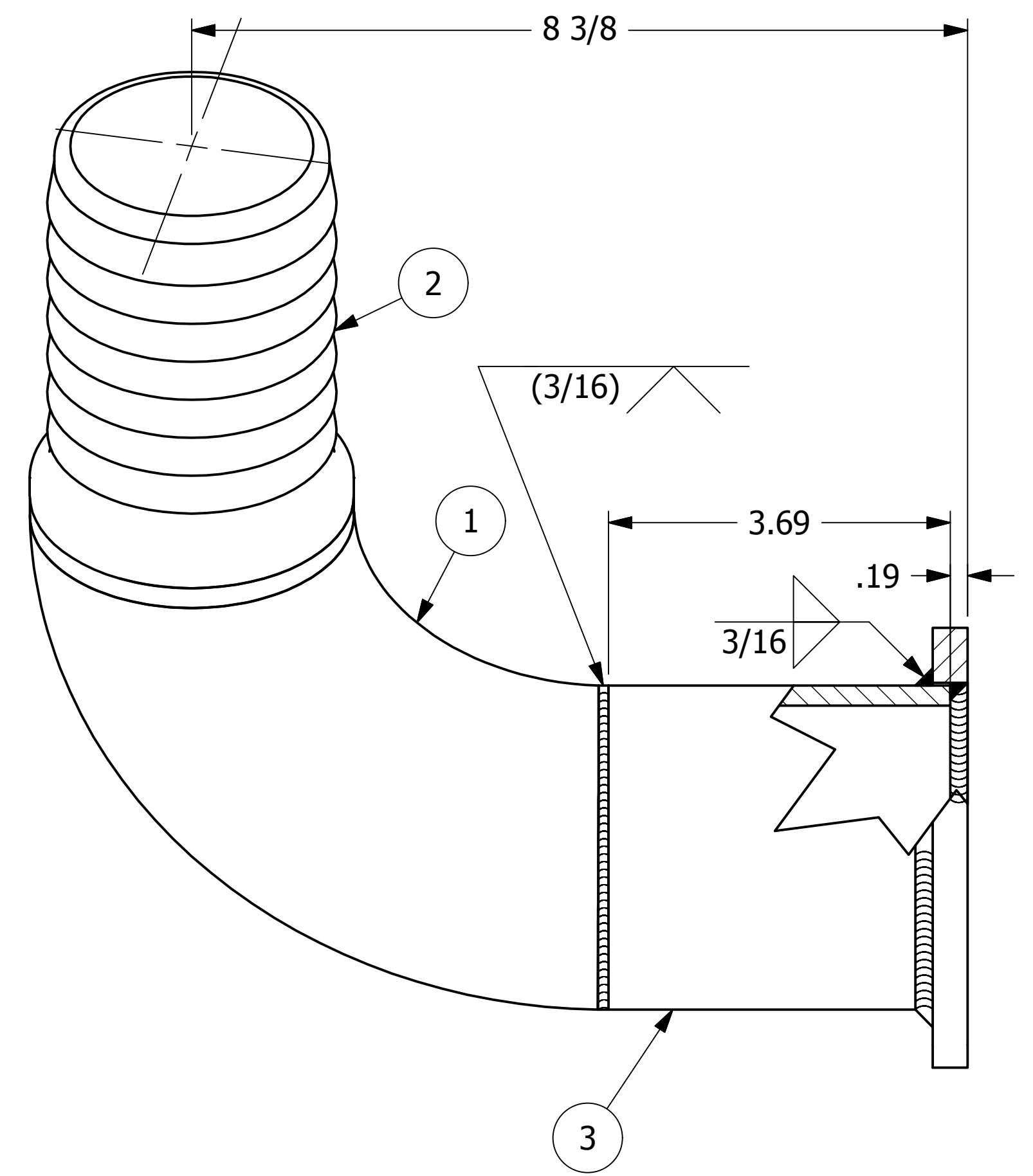
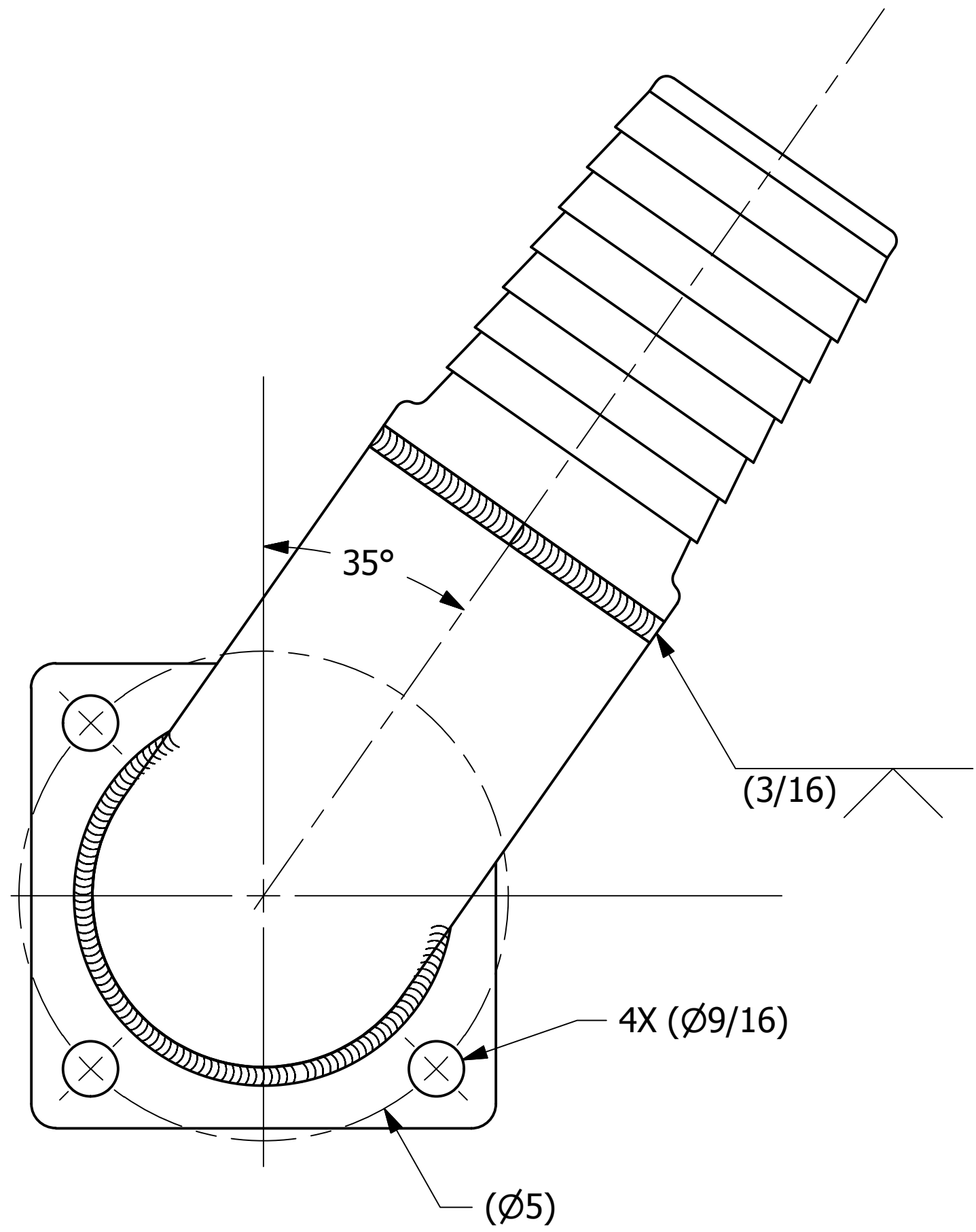

- NOTES:**
1. TEST PER Q-2.15.7
 2. SEE DOCUMENT DSS 13 FOR WELD SPECIFICATIONS.
 3. FLANGE GASKET SURFACE TO BE FREE OF WELD SPATTER.
 4. CLEAN ASSEMBLY OF DEBRIS AND OIL. REMOVE ALL BURRS AND SHARP EDGES.

REV	BY	DATE	DESCRIPTION
D	WEB	6-26-18	CHANGED ALL WELDS TO 3/16, SCALE WAS 1:1
C	JG	5-17-18	Q-2.15.7 WAS QAP4C-1; UPDATED WELD NOTE, TITLEBLOCK, WELD SYMBOLS
B	PJG	6/18/07	REVISED NOTE
A	ACC	8/26/04	ADDED PART TO SYSTEM

UNLESS OTHERWISE SPECIFIED DIMENSIONAL TOLERANCES FRACTIONAL: ±1/16 X.XX: ±.03 X.XXX: ±.015 ANGLE: ±1° DEBURR ALL SHARP EDGES. ALL MACHINED SURFACES TO HAVE A 125 RMS FINISH UNLESS NOTED OTHERWISE.	DRAWN BY:	ACC
	CHECKED BY:	CHL
	PROTOTYPE BY:	ACC
	PROTOTYPE DATE:	7/22/2004
THIRD ANGLE PROJECTION	APPROVED FOR PRODUCTION BY:	ACC
	PRODUCTION DATE:	8/26/2004

SALCO PRODUCTS, INC.

PART NAME: **FLANGED ELBOW 3" X 90°**

MATERIAL: **SEE BOM**

PROJECT #: **040617** SHEET #: **1 OF 1** SCALE: **3:4**

DRAWING #: **C19409** PART #: **PD3A90FHB1**