

NO.	PART NAME	PART#	REQ'D	MATERIAL
1	PIPE 5"	B50494	1	6063-T6
2	SWIVEL GROOVE NIPPLE 5"	N52AVG	1	6063-T6

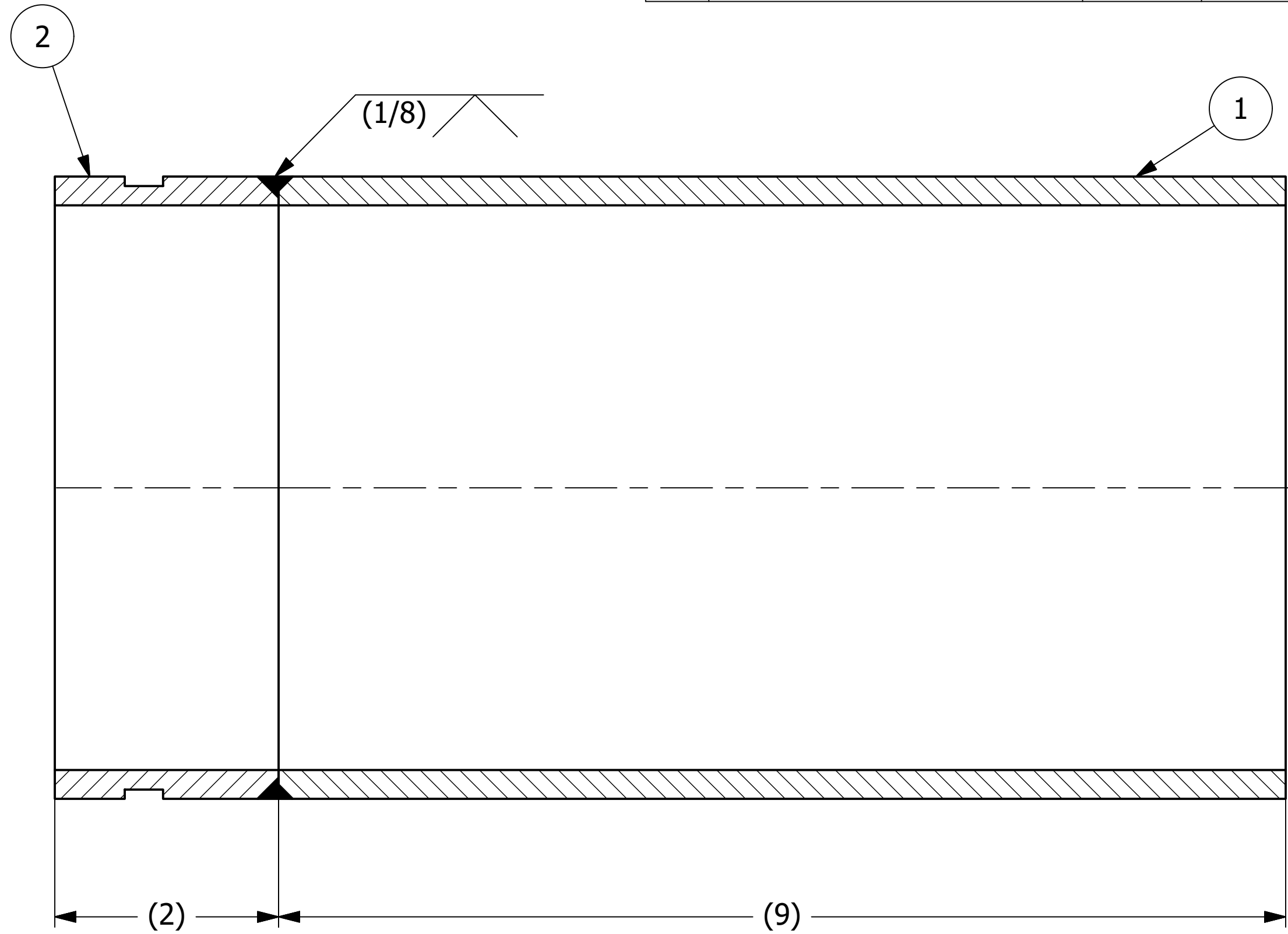
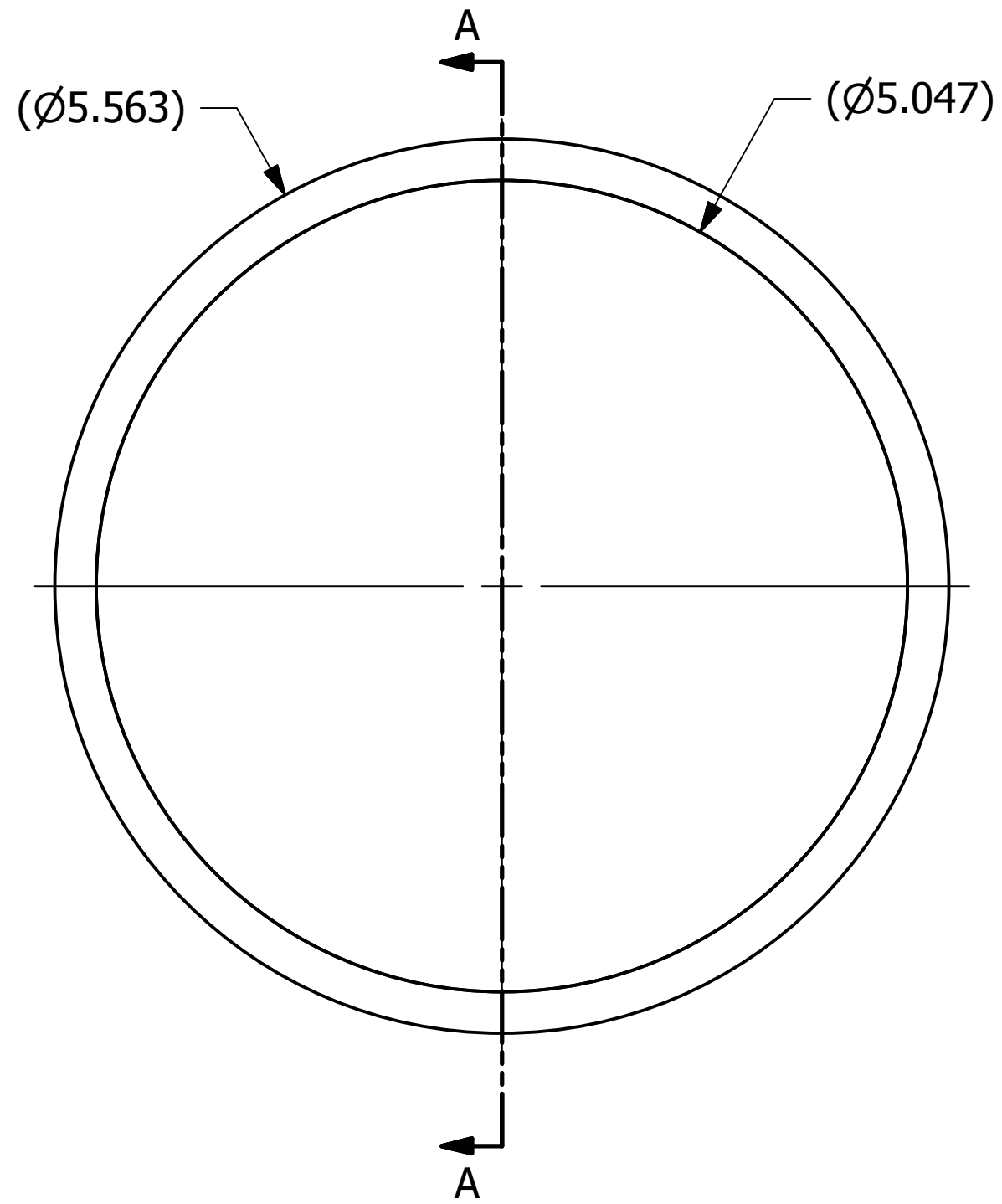

SECTION A-A

NOTES:

1. TEST PER Q-2.15.7.
2. SEE DOCUMENTS WPS-T01, WPS-M08, WPS-M09 FOR WELDING PROCEDURES.
3. WELD ACCEPTANCE CRITERIA TO MEET DOCUMENT D-005.

REV	BY	DATE	DESCRIPTION
B	WEB	7/2/20	UPDATED TO CURRENT DRAFTING STANDARDS; ADDED NOTES; UPDATED WELD SYMBOL; REPLACED P5A40 W/ B50494
A	ACC	11/07/06	WAS SINGLE PIECE OF PIPE

<small>UNLESS OTHERWISE SPECIFIED DIMENSIONAL TOLERANCES FRACTIONAL: ±1/16 X.XX: ±.03 X.XXX: ±.015 ANGLE: ±1° DEBURR ALL SHARP EDGES. ALL MACHINED SURFACES TO HAVE A 125 RMS FINISH UNLESS NOTED OTHERWISE. THIRD ANGLE PROJECTION</small>	DRAWN BY:	ACC
	CHECKED BY:	
	PROTOTYPE DATE:	
	APPROVED FOR PRODUCTION BY:	ACC
	PRODUCTION DATE:	
	SIZE:	C
DRAWING #:	16617	

**SALCO PRODUCTS, INC.**

PART NAME: **SWIVEL GROOVE NIPPLE 5"**

MATERIAL: **SEE BOM**

PROJECT #: **010910** SHEET #: **1 OF 1** SCALE: **1:1**

PART #: **N511AVG**