

NO.	PART NAME	PART #	REQ'D	MATERIAL
1	PIPE 5"	P5A40	.333 FT	ALUMINUM

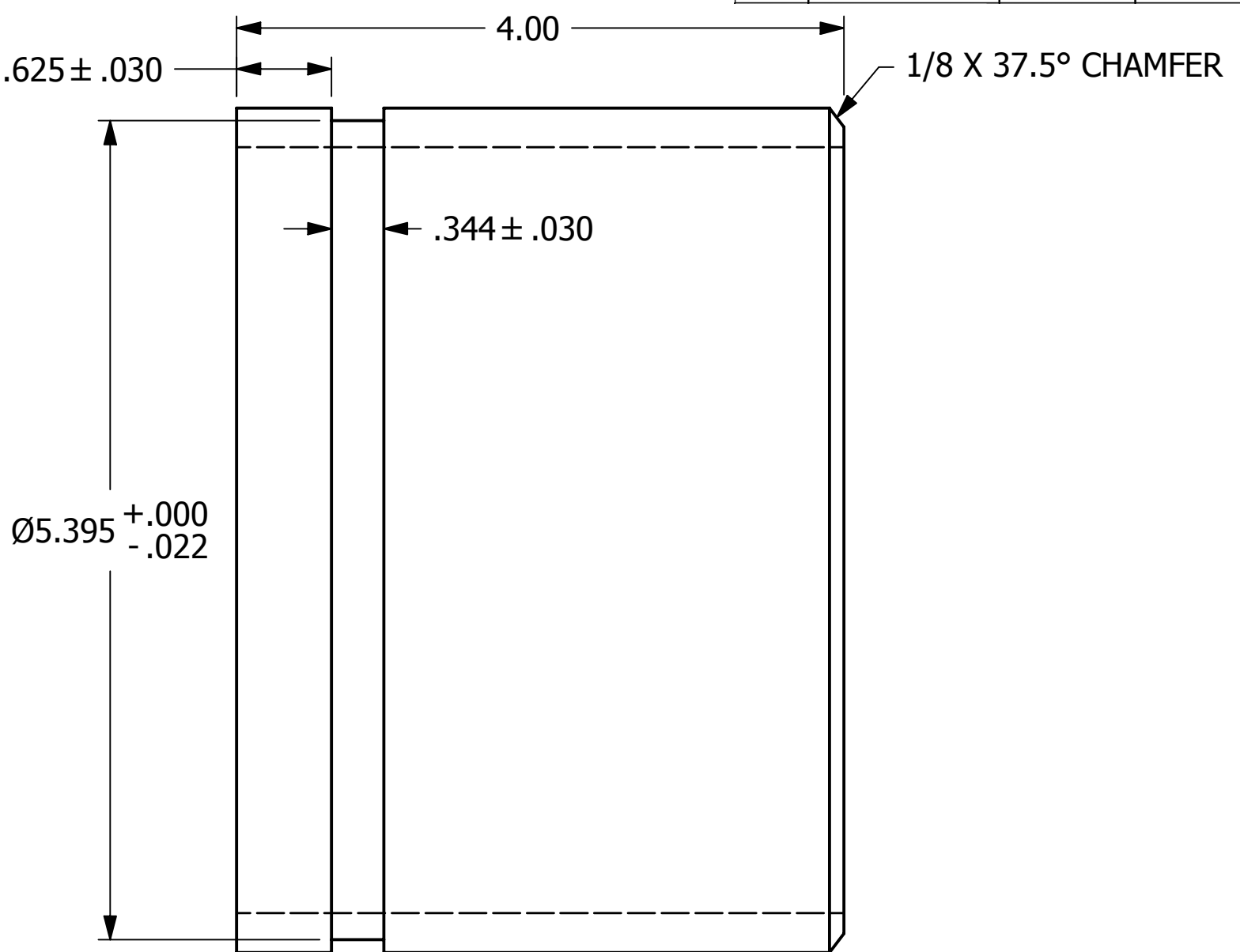
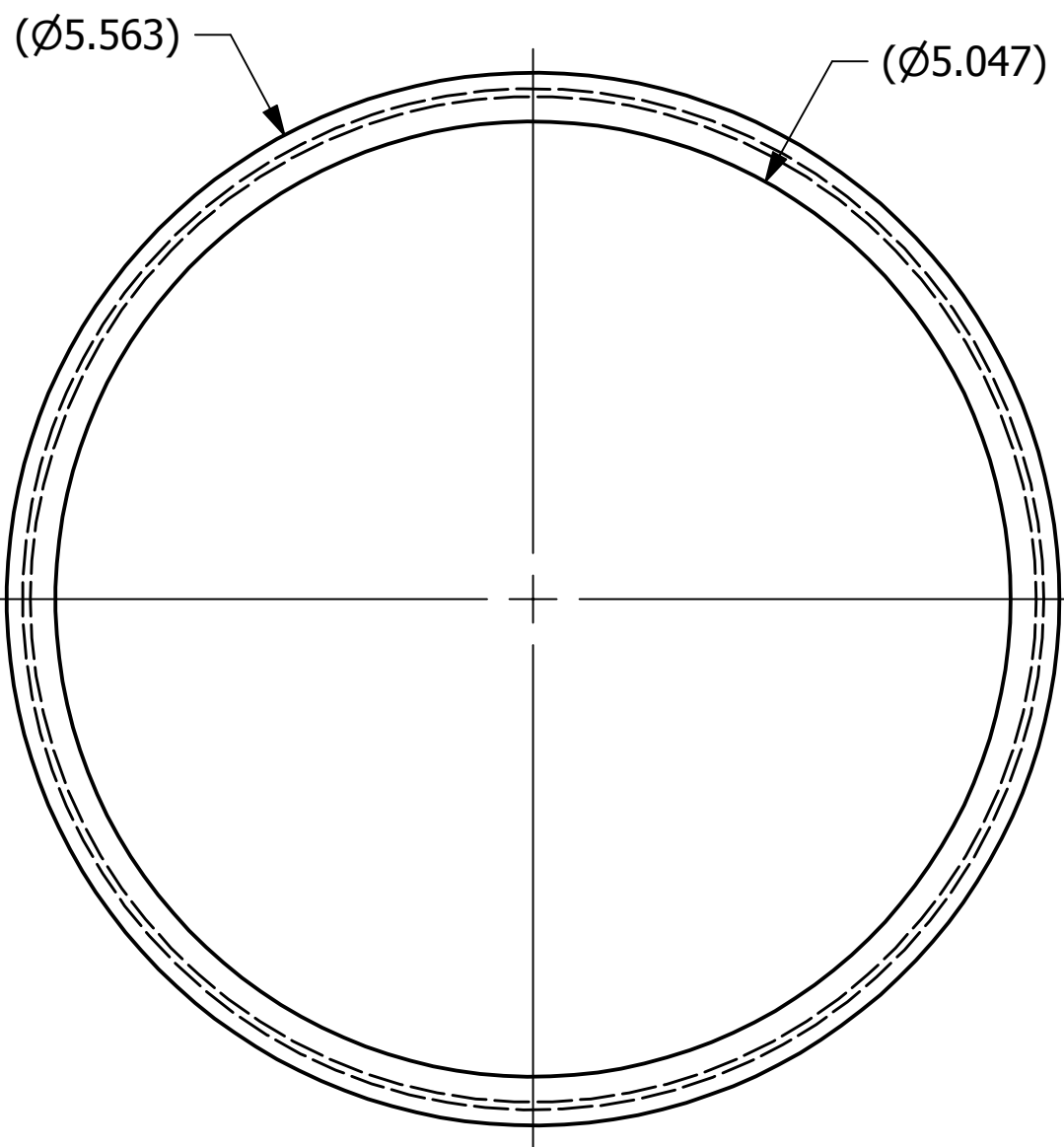

REV	BY	DATE	DESCRIPTION
B	WEB	5-5-17	CHANGED .63 & .38 TO .625±.030 & .344±.030
A	CHL	11-30-07	ADDED BOM

<small>UNLESS OTHERWISE SPECIFIED DIMENSIONAL TOLERANCES</small> FRACTIONAL: ±1/16 X.XX: ±.03 X.XXX: ±.015 ANGULAR: ±1° <small>DEBURR ALL SHARP EDGES. ALL MACHINED SURFACES TO HAVE A 125 RMS FINISH UNLESS NOTED OTHERWISE.</small> <small>THIRD ANGLE PROJECTION</small>	DRAWN BY:	ACC
	CHECKED BY:	
	PROTOTYPE BY:	ACC
	PROTOTYPE DATE:	1/18/2002
	APPROVED FOR PRODUCTION BY:	ACC
	PRODUCTION DATE:	1/18/2002

SALCO PRODUCTS, INC.

PART NAME: **SWIVEL GROOVE NIPPLE 5"**

MATERIAL: **SEE BOM**

PROJECT #: **010910** SHEET #: **1 OF 1** SCALE: **1:1**

DRAWING #: **B16614** PART #: **N54AVG**

THIS PRINT, PROPERTY OF SALCO PRODUCTS INC., CONTAINS PROPRIETARY INFORMATION AND MUST NOT BE COPIED, REPRODUCED, OR USED DETRIMENTALLY TO OUR INTEREST.