

NO.	PART NAME	PART#	REQ'D	MATERIAL
1	HATCH COVER ARM 20"	A20SASW	1	SS
2	BUMPER	VAB	1	EPDM
3	HATCH COVER HINGE ASSEMBLY 20"	HEC20THUT	1	SEE DWG

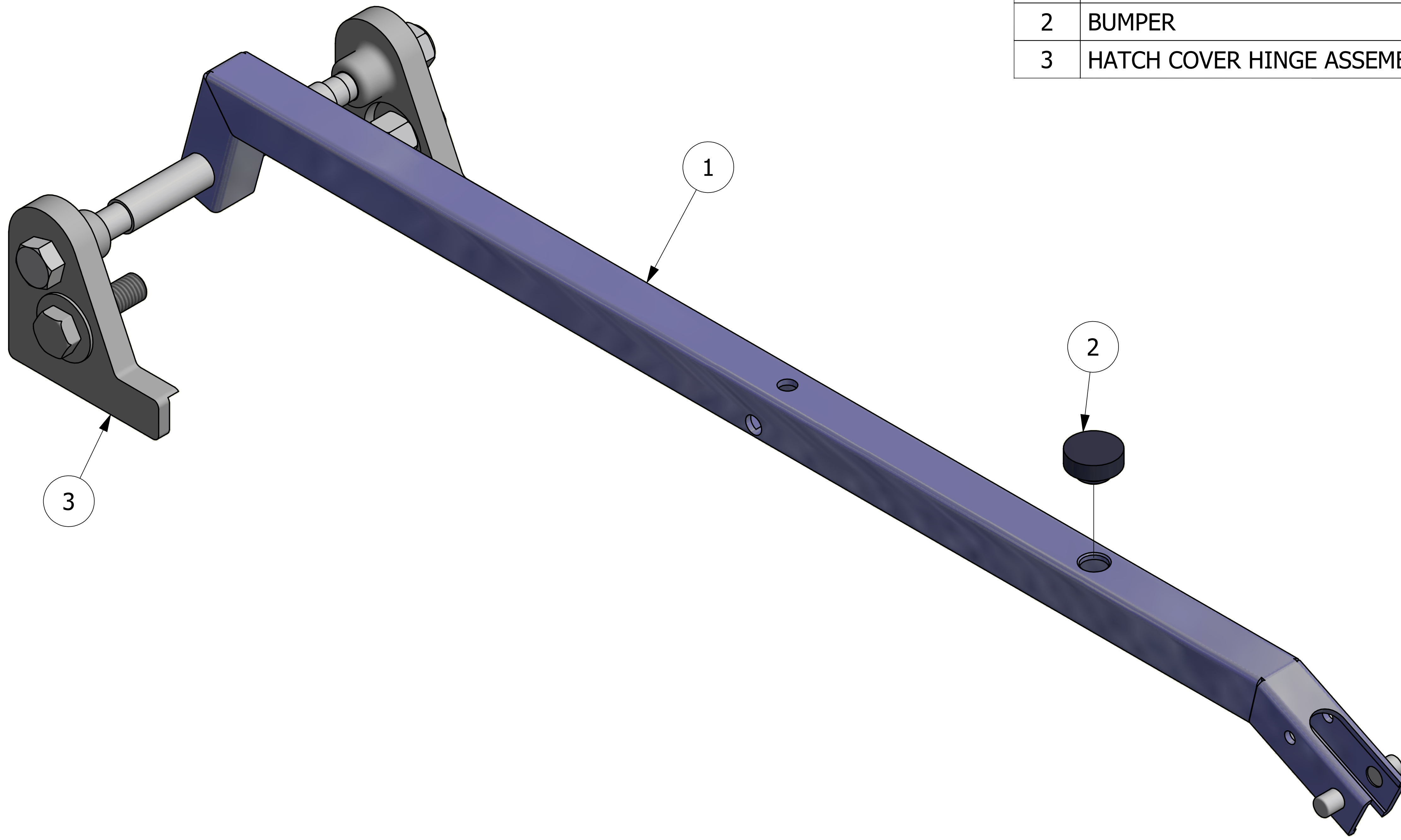

B	WEB	5-20-14	UPDATED VIEW BASED ON A20SASW CHANGES
A	CHL	7-28-10	NEW PART ADDED TO SYSTEM
REV	BY	DATE	DESCRIPTION

<small>UNLESS OTHERWISE SPECIFIED DIMENSIONAL TOLERANCES</small> FRACTIONAL: ±1/16 X.XX: ±.03 X.XXX: ±.015 ANGULAR: ±1° <small>THIS PRINT, PROPERTY OF SALCO PRODUCTS INC, CONTAINS PROPRIETARY INFORMATION AND MUST NOT BE COPIED, REPRODUCED, OR USED DETRIMENTALLY TO OUR INTEREST.</small> THIRD ANGLE PROJECTION	DRAWN BY:	CHL
	CHECKED BY:	VD
	PROTOTYPE BY:	CHL
	PROTOTYPE DATE:	5/21/2010
	APPROVED FOR PRODUCTION BY:	VD
PRODUCTION DATE:	7/28/2010	

SALCO PRODUCTS, INC.

HATCH COVER ARM ASSEMBLY 20"

MATERIAL: **SEE BOM**

PROJECT #: **WAG0095** SHEET #: **1 OF 1** SCALE: **1:1**

DRAWING #: **D28792** PART #: **UT20SCAW**