

NO.	PART NAME	PART#	REQ'D	MATERIAL
1	EYEBOLT 7/8"X4 5/8"	EBR78458	1	CARBON STEEL
2	HEAVY HEX NUT 7/8"-9	N78XH	1	CARBON STEEL
3	FLAT WASHER 7/8"	WASH78T	1	CARBON STEEL

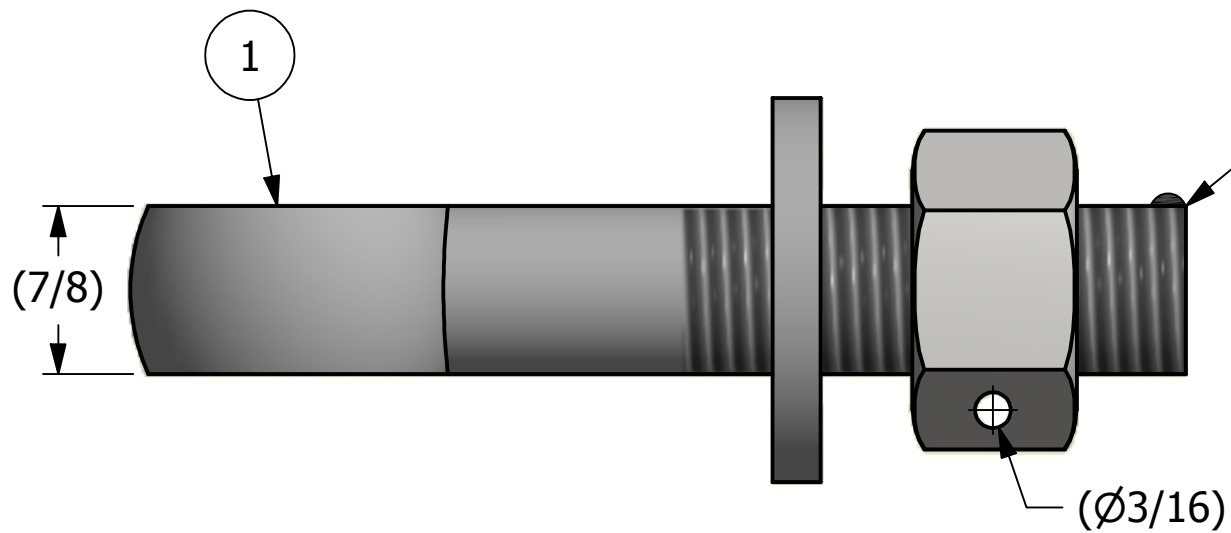

APPLY A BEAD OF WELD TO THE TWO END THREADS AFTER INSTALLING WASHER AND NUT.

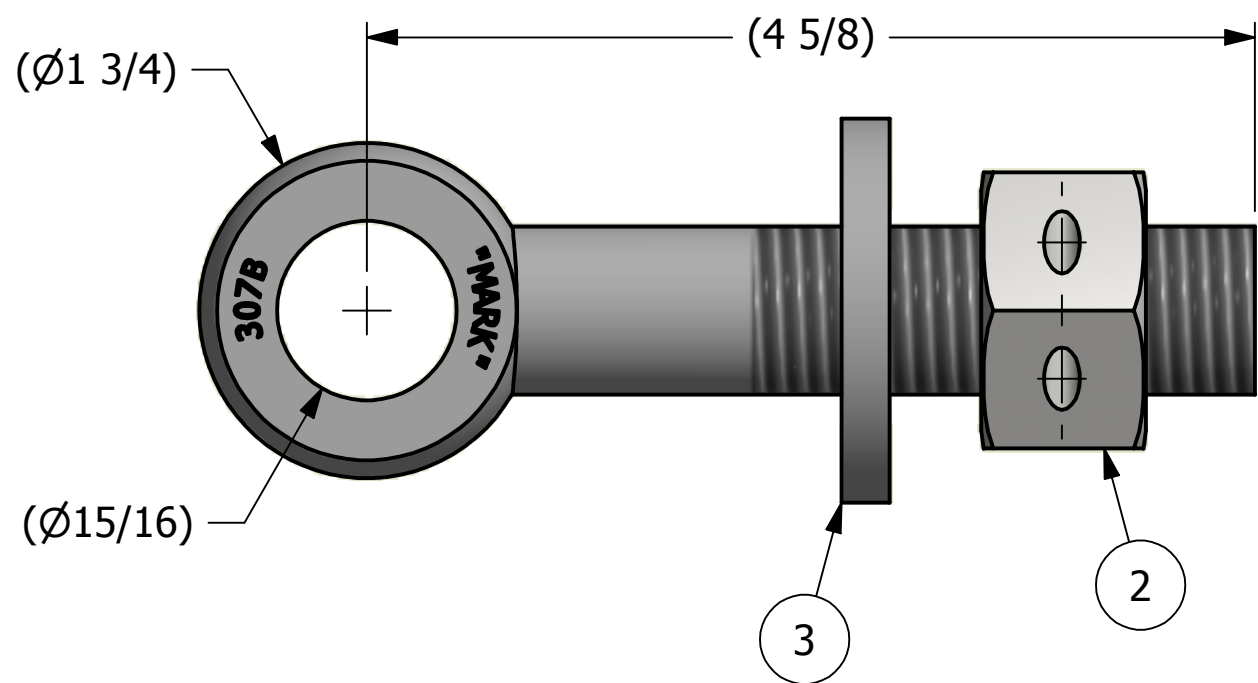
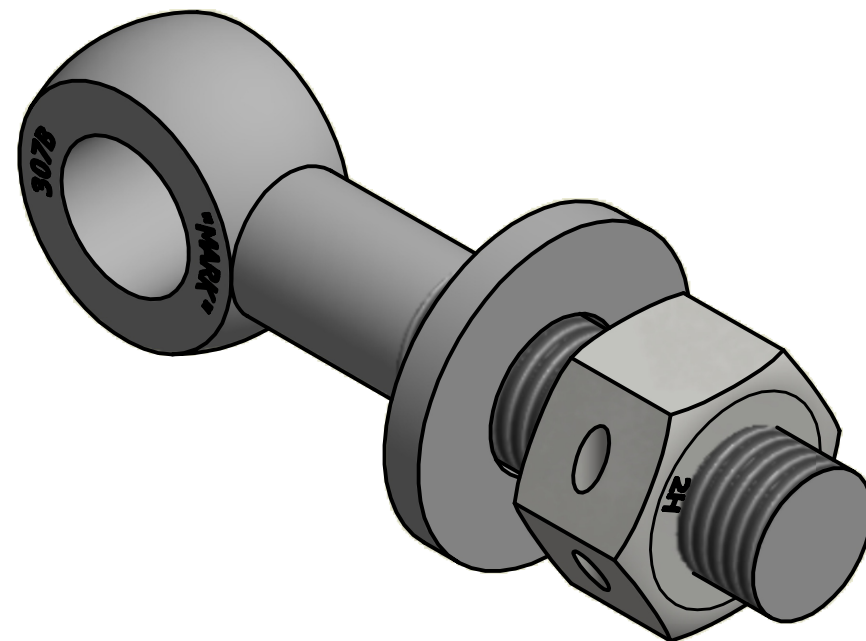

A	WEB	2-7-14	RELEASED FOR PRODUCTION
REV	BY	DATE	DESCRIPTION

<small>UNLESS OTHERWISE SPECIFIED DIMENSIONAL TOLERANCES</small> FRACTIONAL: ±1/16 X.XX: ±.03 X.XXX: ±.015 ANGULAR: ±1° <small>DEBURR ALL SHARP EDGES. ALL MACHINED SURFACES TO HAVE A 125 RMS FINISH UNLESS NOTED OTHERWISE.</small> <small>THIRD ANGLE PROJECTION</small>	DRAWN BY:	CHL
	CHECKED BY:	VD
	PROTOTYPE BY:	CHL
	PROTOTYPE DATE:	1/14/2014
	APPROVED FOR PRODUCTION BY:	WEB
	PRODUCTION DATE:	2/7/2014

SALCO PRODUCTS, INC.		
PART NAME: EYEBOLT ASSEMBLY 7/8"X4 5/8"		
MATERIAL: SEE BOM		
PROJECT #:	130709FR	SHEET #: 1 OF 1
DRAWING #:		SCALE: 1:1
B38087		PART #: EB78458XHA

THIS PRINT, PROPERTY OF SALCO PRODUCTS INC., CONTAINS PROPRIETARY INFORMATION AND MUST NOT BE COPIED, REPRODUCED, OR USED DETRIMENTALLY TO OUR INTEREST.