

NO.	PART NAME	PART#	REQ'D	MATERIAL
1	EYEBOLT 7/8"X5 1/2"	EBR7855HP	1	CARBON STEEL
2	PIN 3/8"X2 1/2"	PIN375	1	CARBON STEEL
3	HEX NUT 7/8"-9	N78X3	1	CARBON STEEL
4	FLAT WASHER 7/8"	WASH78T	1	CARBON STEEL

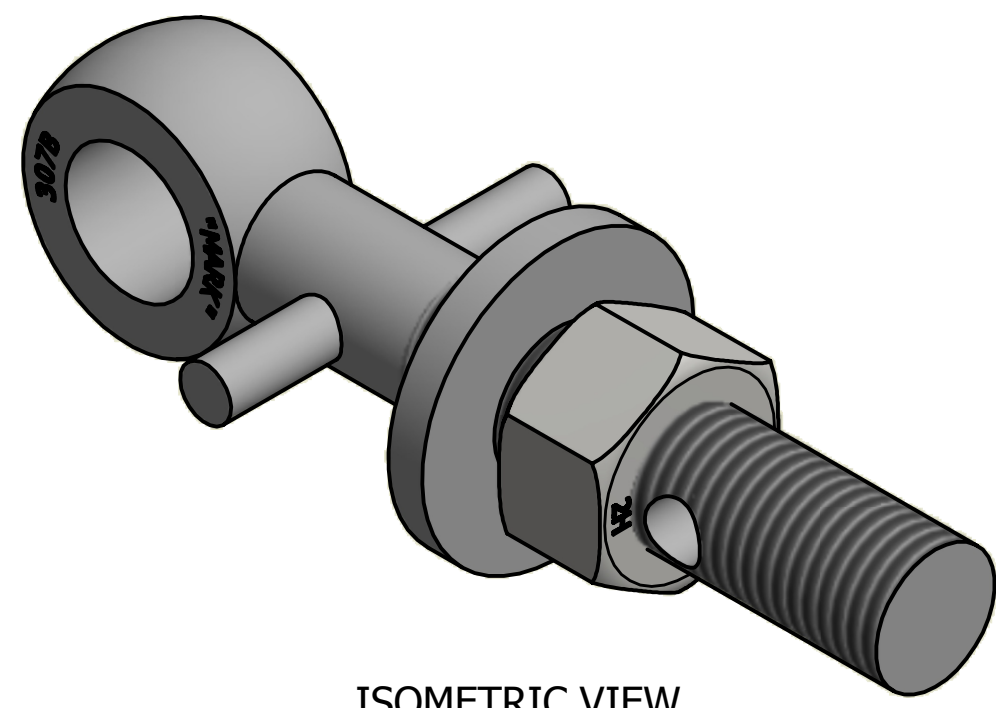

REV	BY	DATE	DESCRIPTION
C	JJK	4-16-14	UPDATED EYEBOLT OD
B	CHL	10-29-13	REPLACED EBR7855HPR W/EBR7855HP
A	RJP	10-25-13	RELEASED FOR PRODUCTION

UNLESS OTHERWISE SPECIFIED DIMENSIONAL TOLERANCES	DRAWN BY:	RJP
FRACTIONAL: ±1/16	CHECKED BY:	CHL
X.XX: ±.03	PROTOTYPE BY:	RJP
X.XXX: ±.015	PROTOTYPE DATE:	10/15/2013
ANGULAR: ±1°	APPROVED FOR PRODUCTION BY:	VD
DEBURR ALL SHARP EDGES. ALL MACHINED SURFACES TO HAVE A 125 RMS FINISH UNLESS NOTED OTHERWISE.	PRODUCTION DATE:	10/25/2013
THIRD ANGLE PROJECTION		

SALCO PRODUCTS, INC.

PART NAME: EYEBOLT ASSEMBLY 7/8" X 5 1/2"

MATERIAL: SEE BOM

PROJECT #: 131015FR SHEET #: 1 OF 1 SCALE: 1:1

DRAWING #: **B37481** PART #: **EB7855XHAP**

THIS PRINT, PROPERTY OF SALCO PRODUCTS INC., CONTAINS PROPRIETARY INFORMATION AND MUST NOT BE COPIED, REPRODUCED, OR USED DETRIMENTALLY TO OUR INTEREST.