

NO.	PART NAME	PART #	REQ'D	MATERIAL
1	HATCH COVER RING 30"	E42601	1	CS
2	LATCH U-BRACKET	UIB30	1	CS

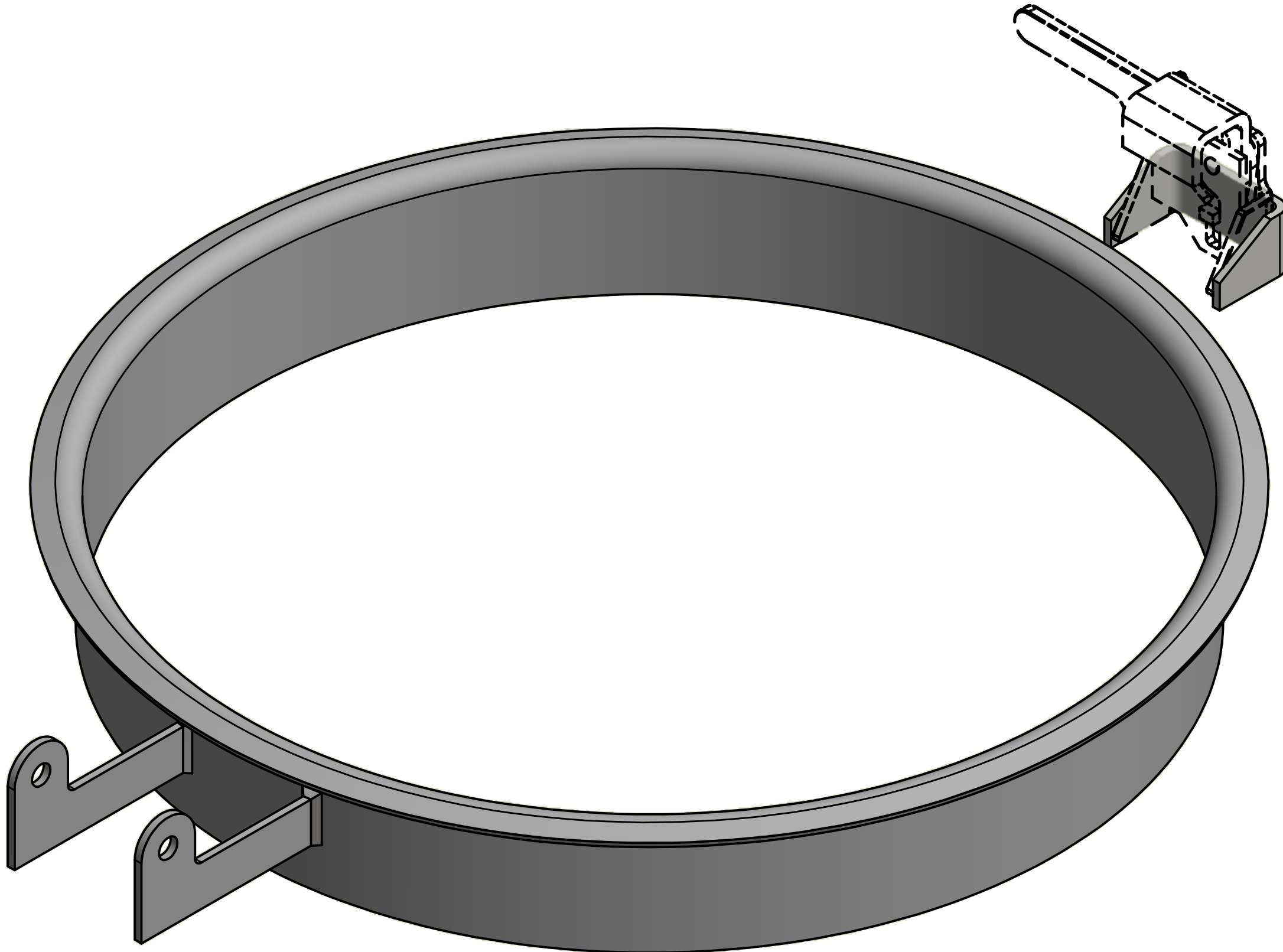

ISOMETRIC VIEW

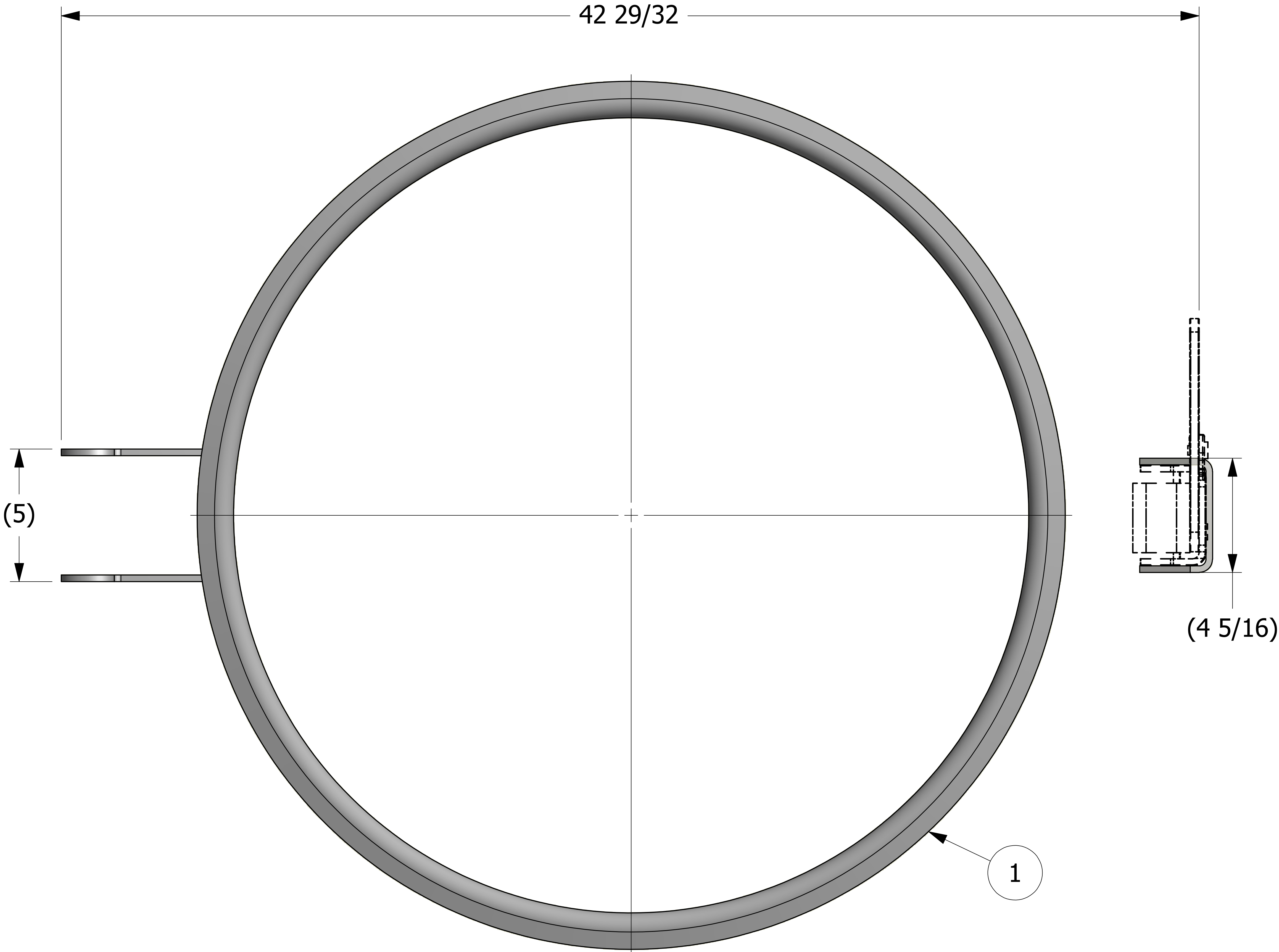
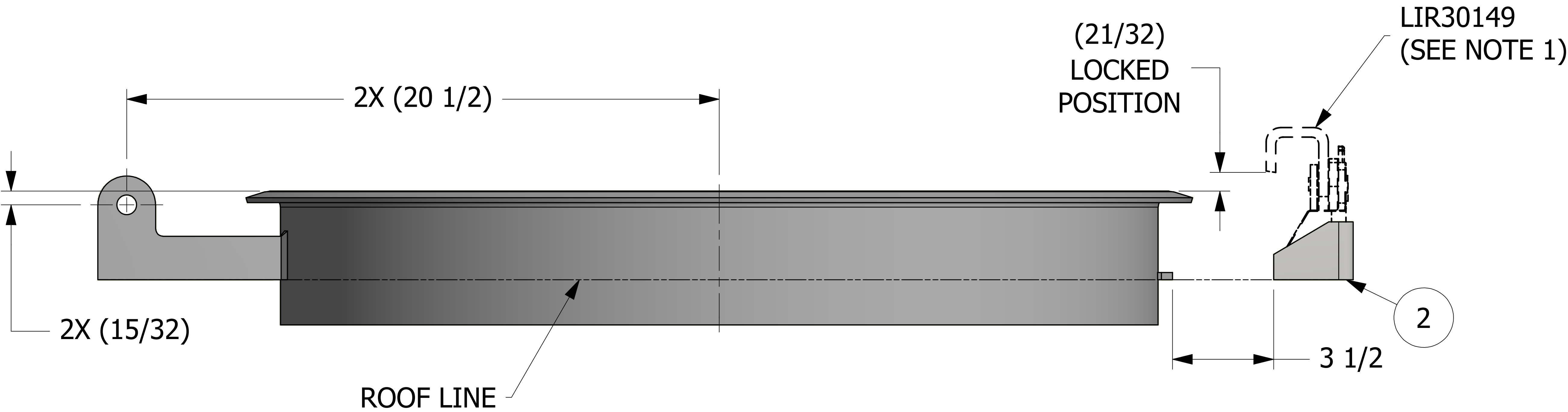

- NOTES:
1. LIR30149 SOLD SEPERATELY.
 2. PHC3007SAL2 & VPHC3007SAL2 COVERS FIT RING ASSEMBLY.

UNLESS OTHERWISE SPECIFIED DIMENSIONAL TOLERANCES FRACTIONAL: $\pm 1/16$ X.XX: $\pm .03$ X.XXX: $\pm .015$ ANGULAR: $\pm 1^\circ$ DEBURR ALL SHARP EDGES. ALL MACHINED SURFACES TO HAVE A 125 RMS FINISH UNLESS NOTED OTHERWISE.	DRAWN BY: JG
THIRD ANGLE PROJECTION	CHECKED BY: CHL
	PROTOTYPE BY: JG
	PROTOTYPE DATE: 11/2/2015
	APPROVED FOR PRODUCTION BY: JG
	PRODUCTION DATE: 11/3/2015

B	JG	11-4-15	3 1/2" DIM WAS 4"
A	JG	11-3-15	RELEASED FOR PRODUCTION
REV	BY	DATE	DESCRIPTION
PART NAME: SALCO PRODUCTS, INC.			
HATCH COVER RING ASSEMBLY 30"			
MATERIAL: SEE BOM			
PROJECT #:	R151022	SHEET #:	1 OF 1
DRAWING #:	E42635	PART #:	HCR30A1
		SCALE:	1:1