

APPLICATION FOR RENEWAL OF APPROVAL FOR PRESSURE RELIEF DEVICES, VALVES, CLOSURES, AND FITTINGS

1. AAR APPROVAL No. E202143
2. Date of Application 10/01/2019
3. Previous AAR Approval E-099017
4. Applicant: Salco Products Inc.
5. Address: 1385 101st Street, Suite A, Lemont IL 60439
6. Drawing No. D49421 7. Latest rev. A 8. Date of latest rev. 10/01/2019
9. Description of device: Parallel Instrument Tee 3" x 2" 10. Device ID No. HSPITXXX

CERTIFICATION: The subject device is **unchanged** from the previous approval, and conforms with the latest revision of AAR Specifications for Tank Cars, Appendix A. The device conforms with drawing listed above.

11. By: _____ Title: _____

If device is **changed** since latest approval, fill in the following blanks

- | 12. Reference Previous Drawing | New Drawing | If on Service Trial |
|--|--|---------------------|
| No. <u>HSPIT3X2</u> Rev. <u>E</u> Date <u>4/1/14</u> | No. <u>HSPITXXX</u> Rev. <u>A</u> Date <u>10/01/2019</u> | S.T. No. _____ |
| No. _____ Rev. _____ Date _____ | No. _____ Rev. _____ Date _____ | S.T. No. _____ |
| No. _____ Rev. _____ Date _____ | No. _____ Rev. _____ Date _____ | S.T. No. _____ |

13. New drawing supersedes previous one or does not obsolete it

CHANGES

REASONS FOR CHANGES

- | | |
|---|---|
| <p>14. a. <u>New Drawing Number</u></p> <p>b. _____</p> <p>c. _____</p> <p>d. _____</p> <p style="text-align: center;">(if needed use supplemental sheet)</p> | <p>a. <u>Reorganized old drawing into a new chart</u></p> <p>b. <u>drawing.</u></p> <p>c. _____</p> <p>d. _____</p> |
|---|---|

15. Normal operational effect of changes of device: None - This is a clerical update the the drawing structure.
- _____
- _____

16. Drawing submitted with this application: HSPITXXX

CERTIFICATION: The above data is correct and conforms with AAR Specifications for Tank Cars, Appendix A. The device conforms with drawing listed above.

17. By: _____ Title: _____

APPROVAL AAR Tank Car Committee:

Date Approved: 8/14/2020

Kenneth B Dorsey

(Signature) on behalf of Committee

| NO. | PART NAME | PART # | REQ'D | MATERIAL |
|-----|------------------------------|-----------|-----------|----------|
| 1 | PARALLEL INSTRUMENT TEE PLUG | HSPITPLG5 | 1 | SALCO PE |
| 2 | SHEET 2" | SHT2UHR | .82 SQ FT | SALCO PE |

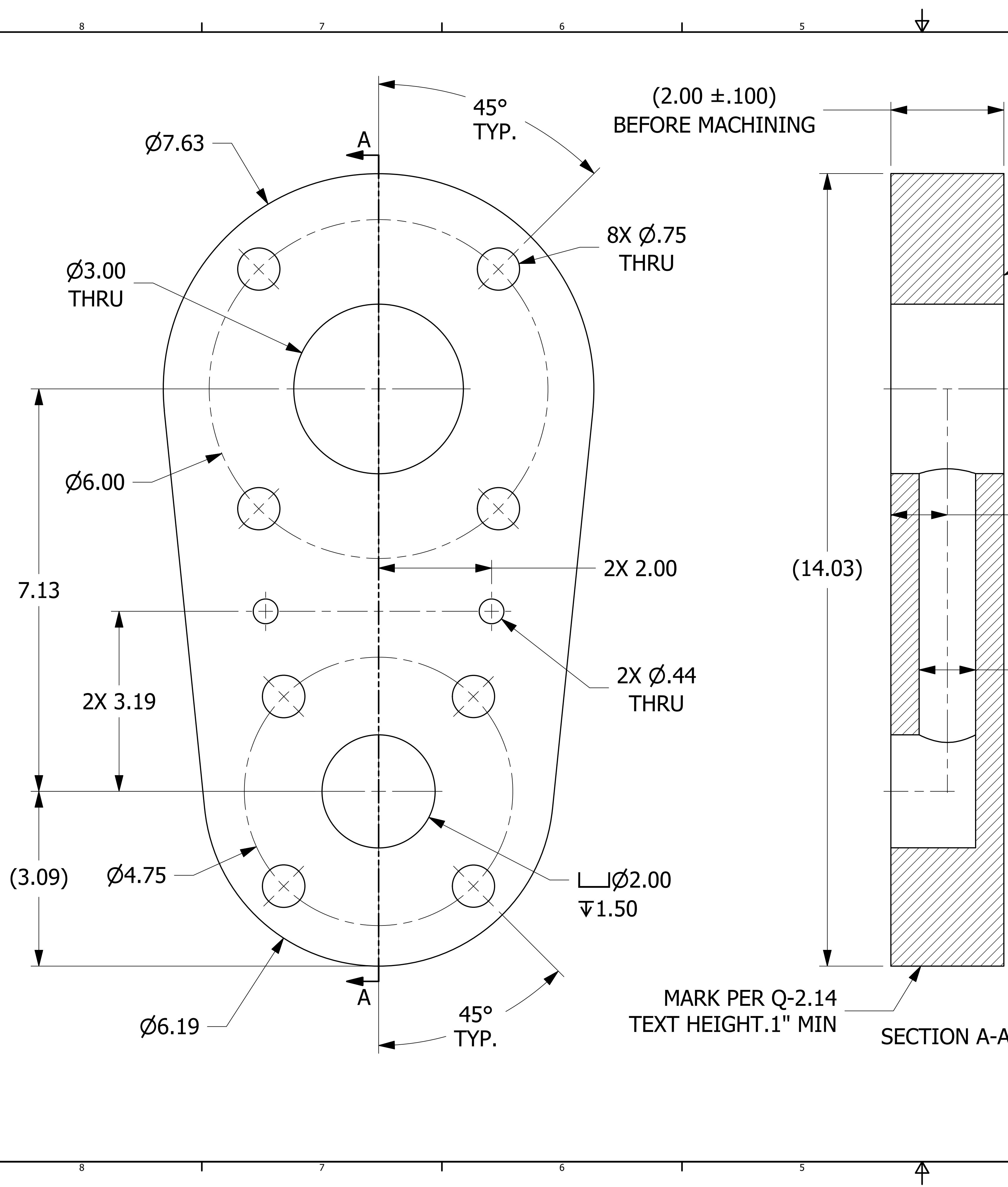

SERRATED GASKET SURFACE
(3 PLACES)

- NOTES:
1. SEE DOCUMENT DSS 1 FOR MATERIAL SPECIFICATIONS.
 2. SEE DOCUMENT Q-2.14 FOR MARKING PROCEDURE.
 3. SEE DOCUMENT DSS 3 FOR FRICTION WELDING SPECIFICATIONS.
 4. AAR APPROVAL #E-202143.

| | | |
|--|-----------------------------|-----------|
| UNLESS OTHERWISE SPECIFIED DIMENSIONAL TOLERANCES | DRAWN BY: | CHL |
| FRACTIONAL: ±1/16 | CHECKED BY: | WRB |
| X.XX: ±.03 | PROTOTYPE DATE: | 8/28/2019 |
| X.XXX: ±.015 | APPROVED FOR PRODUCTION BY: | WRB |
| ANGULAR: ±1° | PRODUCTION DATE: | 10/1/2019 |
| DEBURR ALL SHARP EDGES. ALL MACHINED SURFACES TO HAVE A 125 RMS FINISH. UNLESS NOTED OTHERWISE. | SIZE: | D |
| THIRD ANGLE PROJECTION | DRAWING #: | 49421 |

| | | | |
|---|-----|------------------------|---|
| B | | | AAR APPROVAL # WAS E-099017, UPDATED TITLEBLOCK |
| A | CHL | 10/1/19 | RELEASED FOR PRODUCTION |
| REV | BY | DATE | DESCRIPTION |
| SALCO PRODUCTS, INC. | | | |
| PART NAME: PARALLEL INSTRUMENT TEE 3"X2" | | | |
| MATERIAL: SEE BOM/NOTE | | | |
| PROJECT #: 030708 | | SHEET #: 1 OF 4 | SCALE: 1 : 1 |
| PART #: HSPITXXX | | | |

MARK PER Q-2.14
TEXT HEIGHT .1" MIN

SECTION A-A

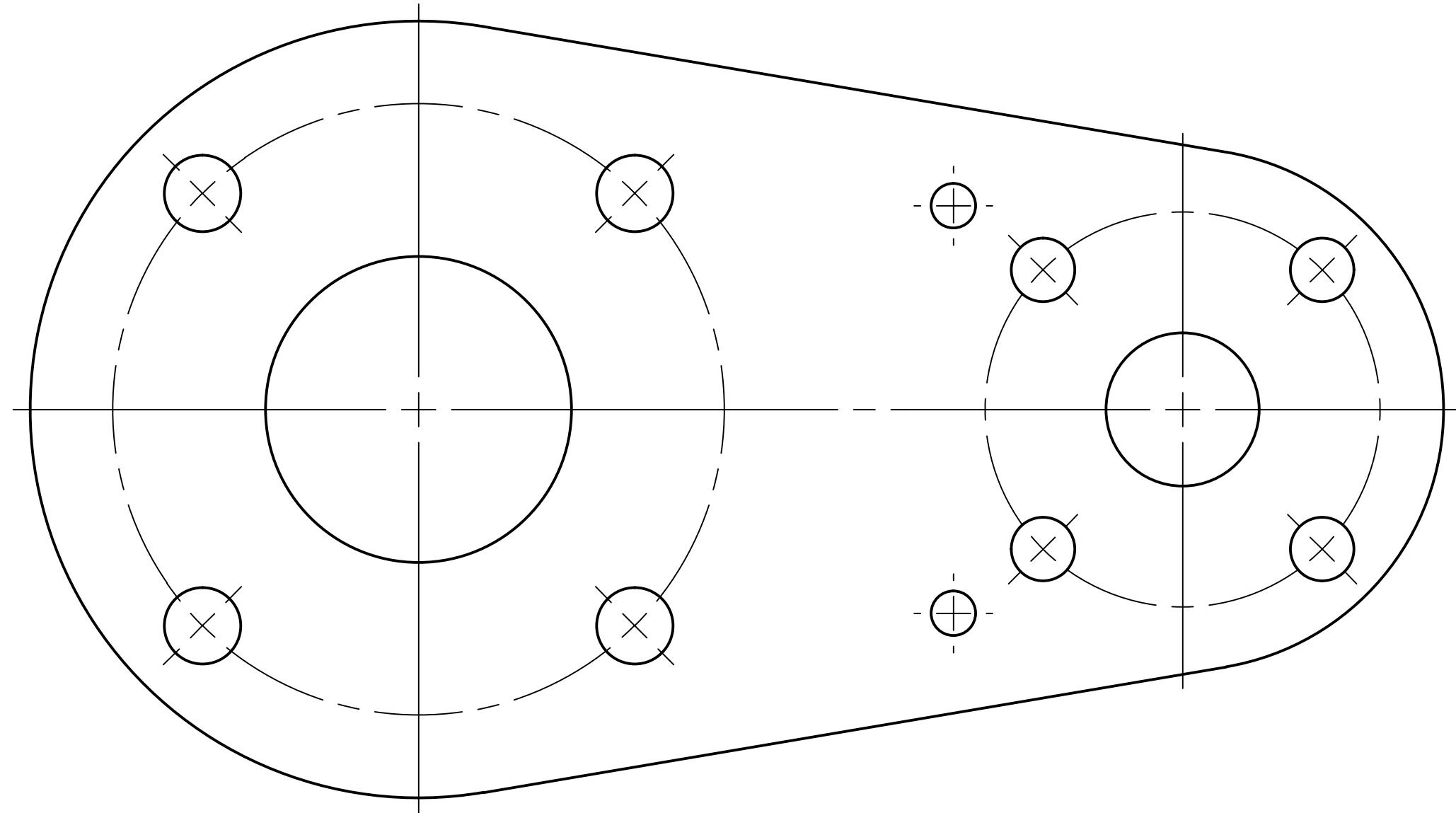

**3" X 1 1/2" ANSI BOLTING PATTERN
PARALLEL INSTRUMENT TEE**

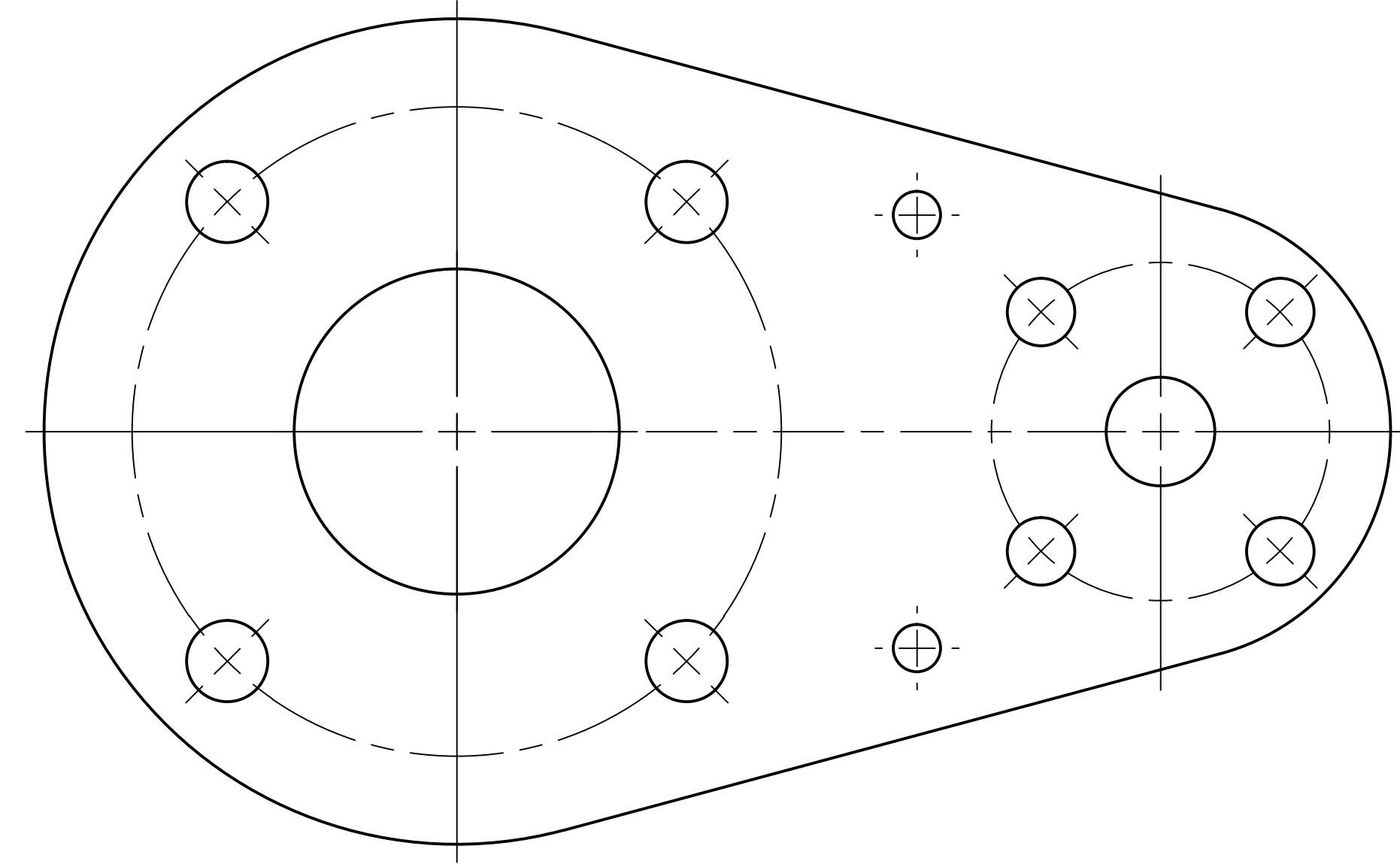

**3" X 1" ANSI BOLTING PATTERN
PARALLEL INSTRUMENT TEE**

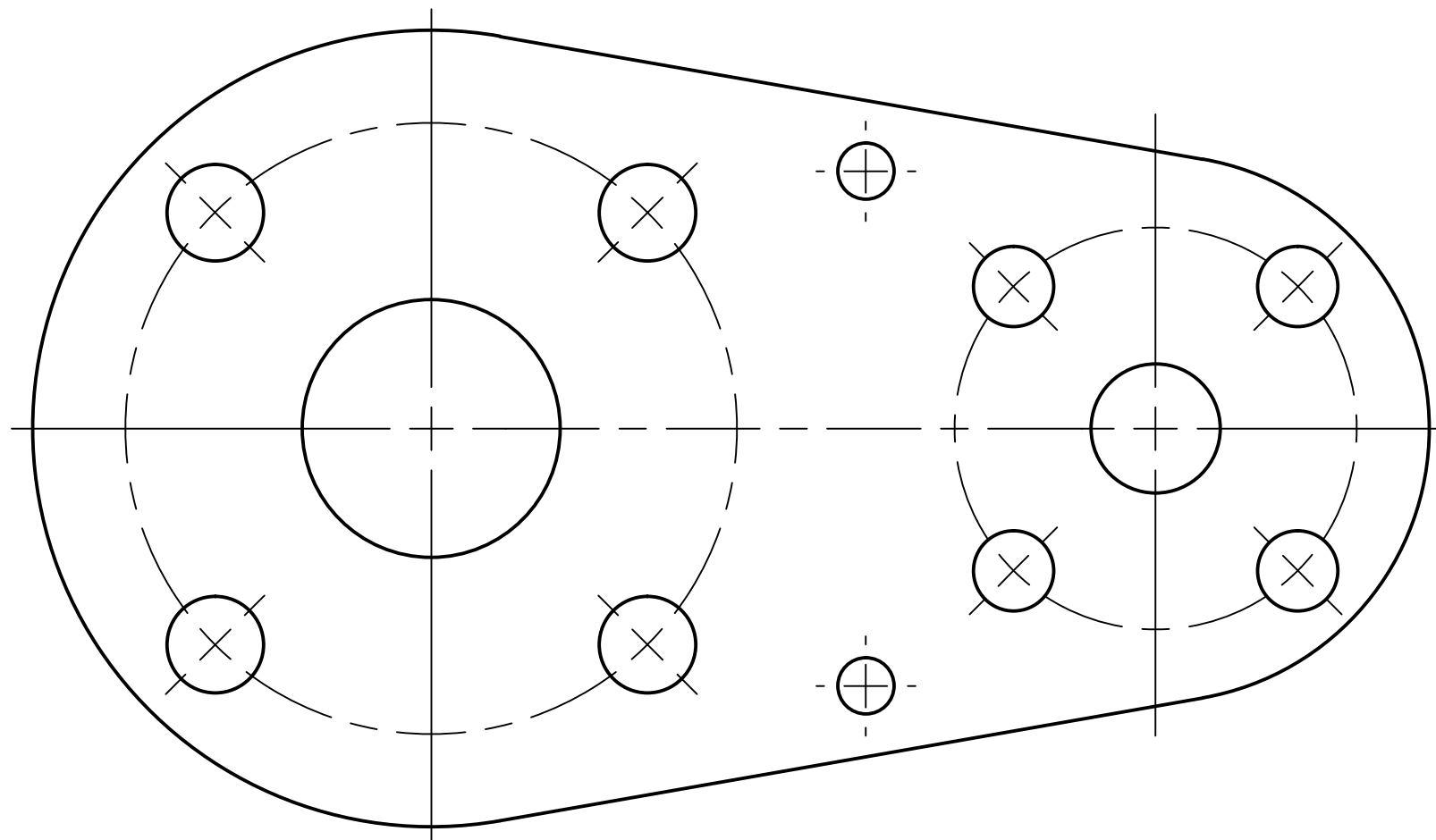

**2" X 1" ANSI BOLTING PATTERN
PARALLEL INSTRUMENT TEE**

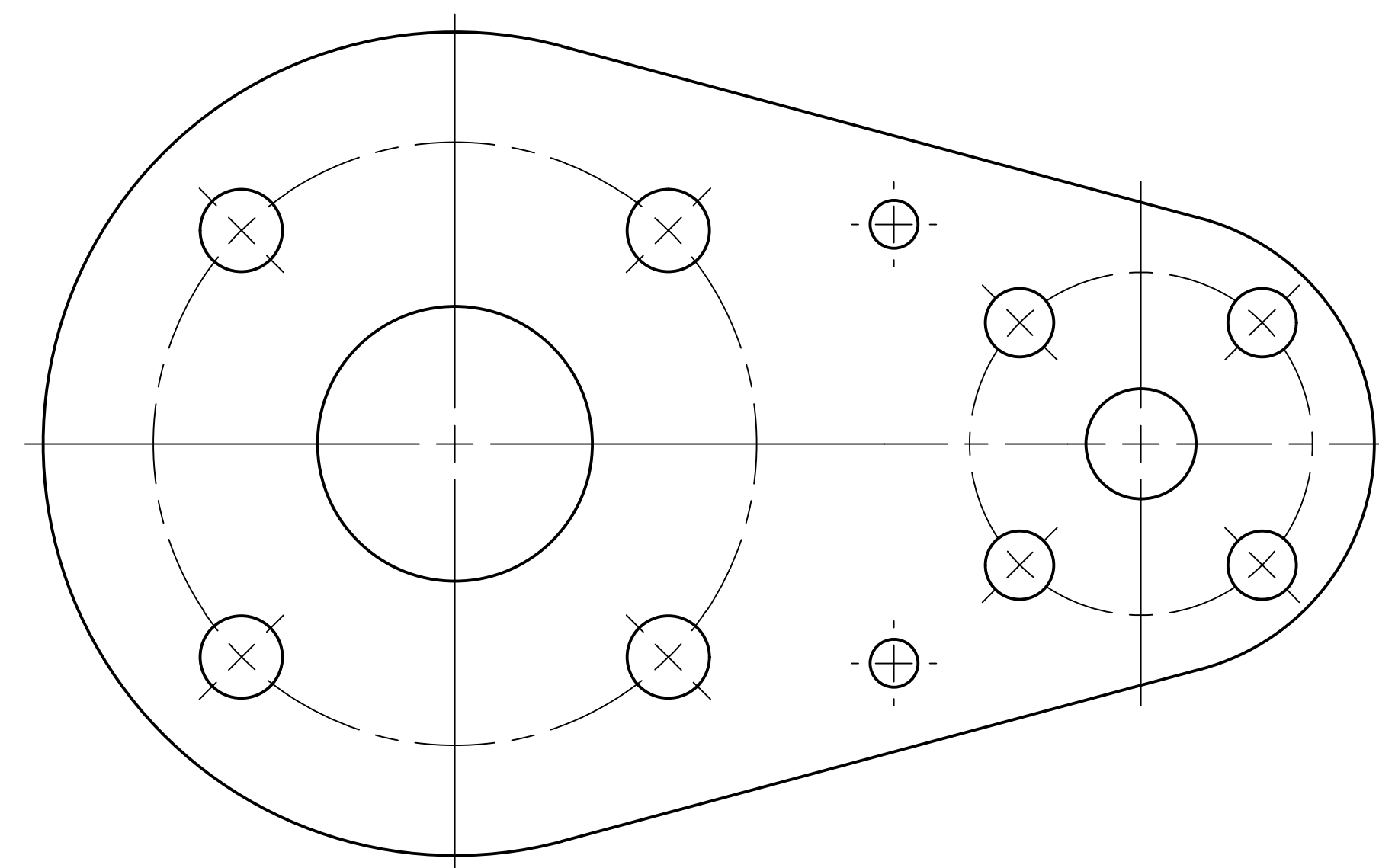

**2 1/2" X 1" ANSI BOLTING PATTERN
PARALLEL INSTRUMENT TEE**

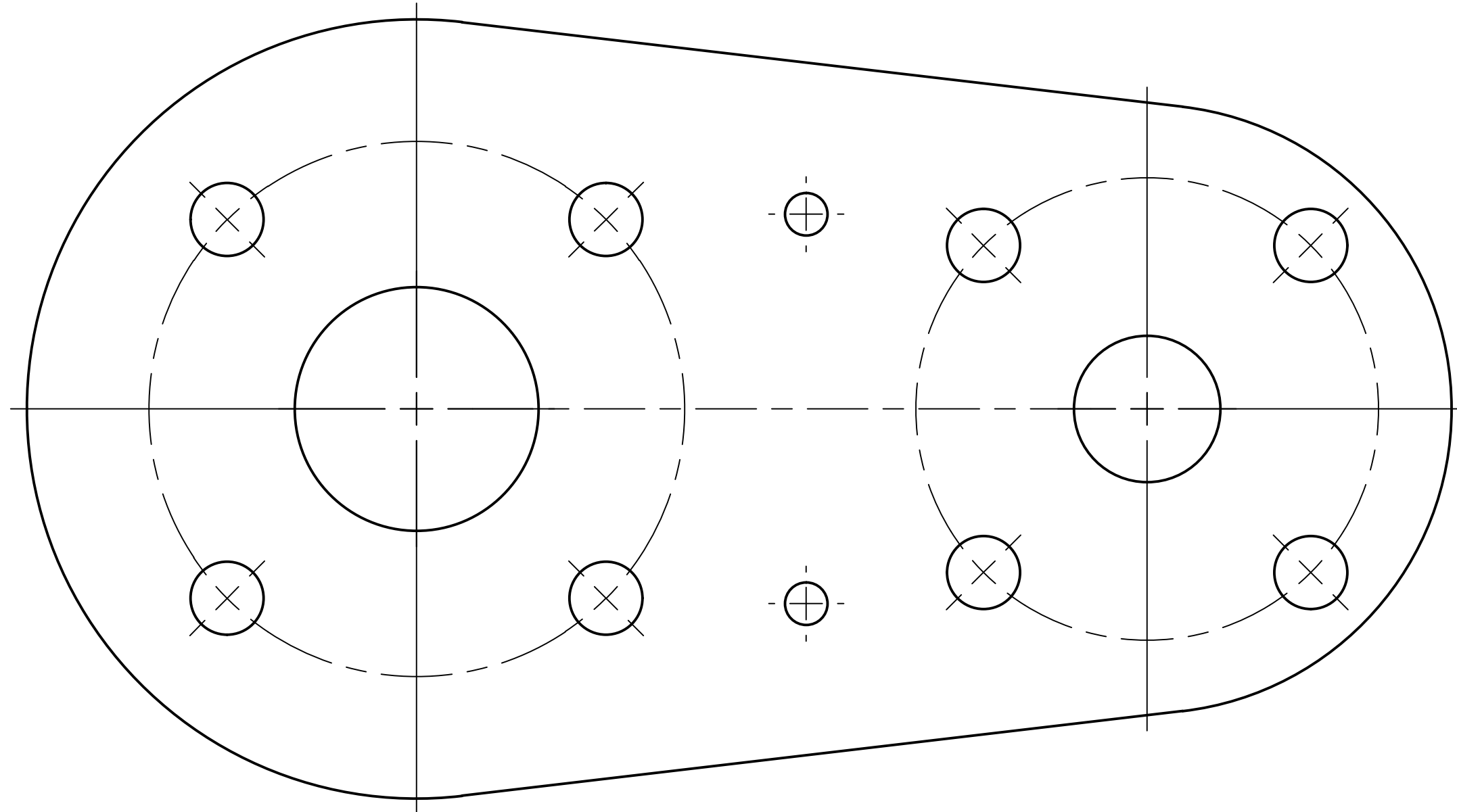

2 1/2" X 2" ANSI BOLTING PATTERN
PARALLEL INSTRUMENT TEE

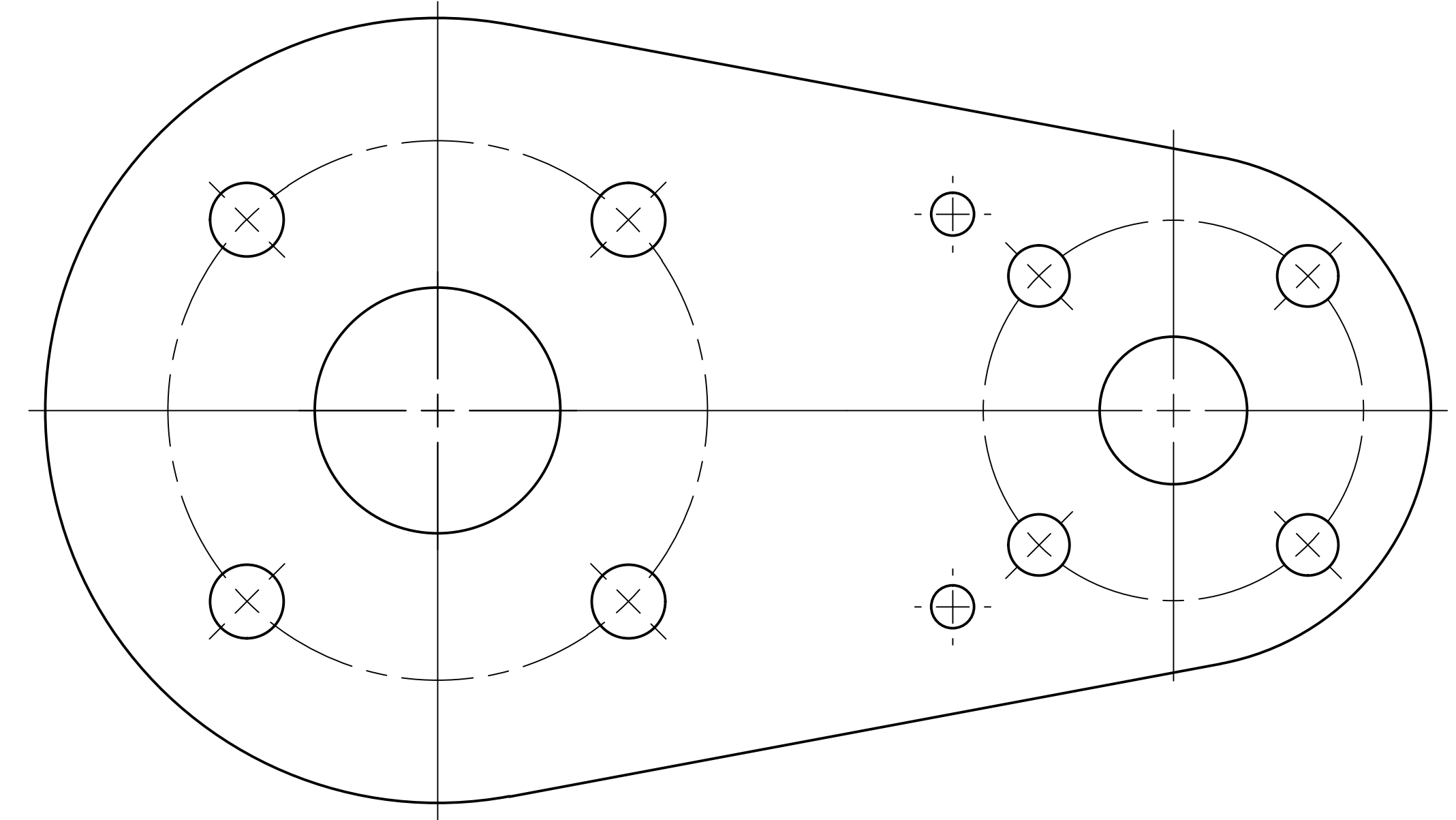

2 1/2" X 1 1/2" ANSI BOLTING PATTERN
PARALLEL INSTRUMENT TEE

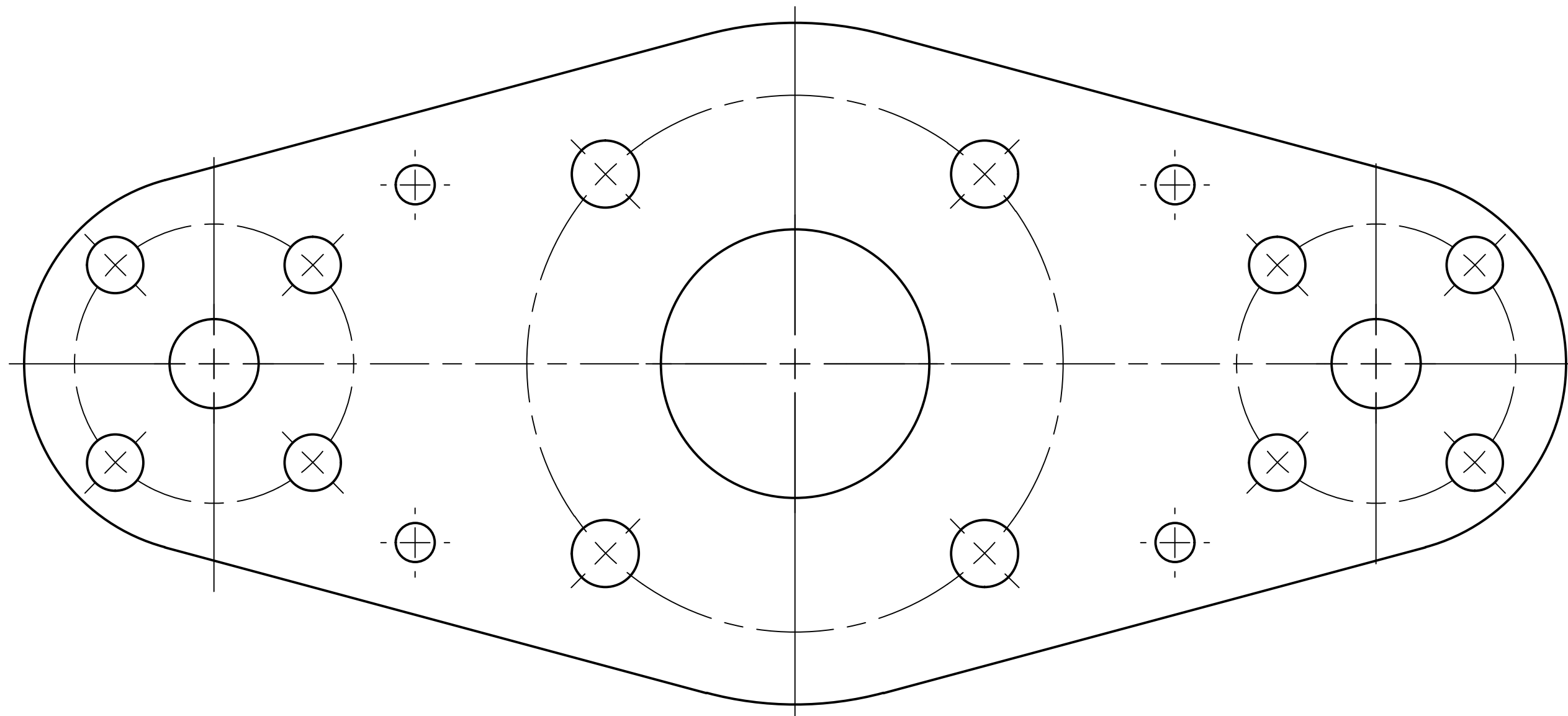

3" X 1" X 1" ANSI BOLTING PATTERN
PARALLEL INSTRUMENT TEE

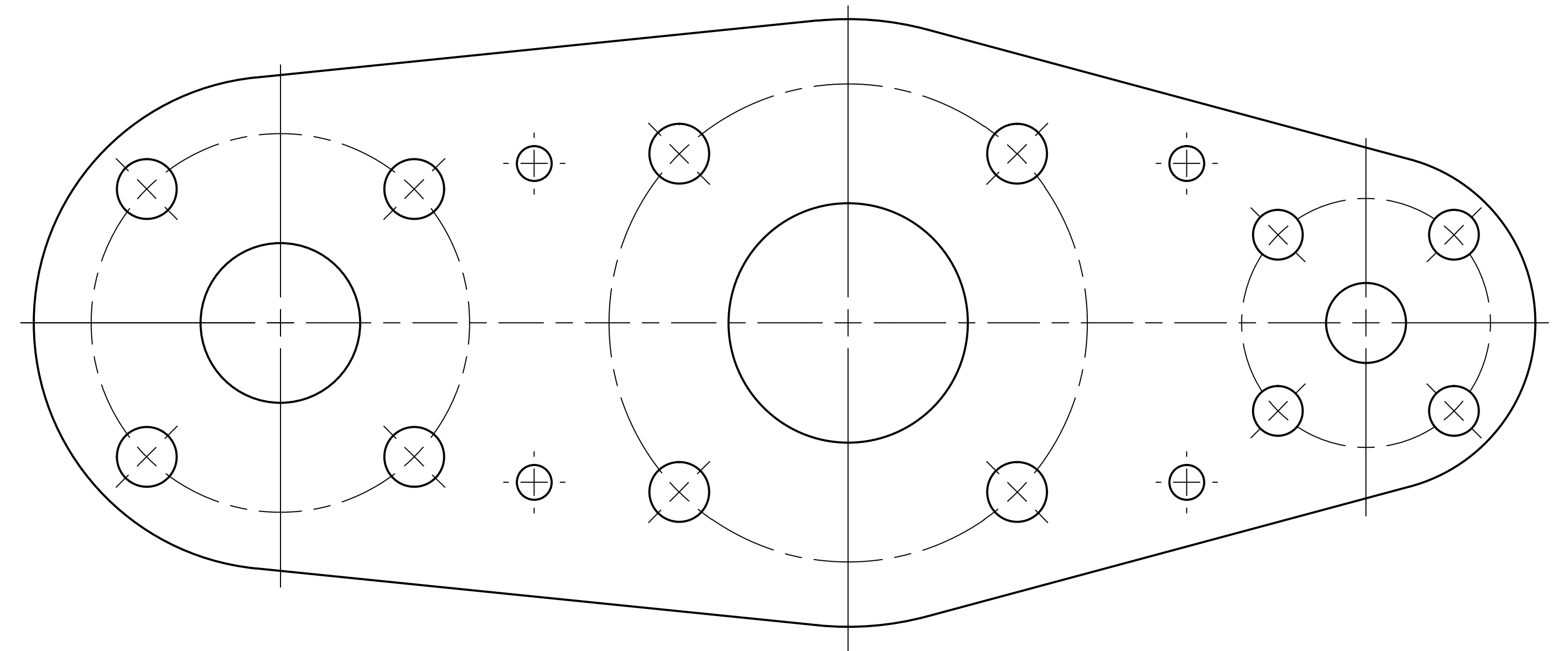

3" X 1" X 2" ANSI BOLTING PATTERN
PARALLEL INSTRUMENT TEE

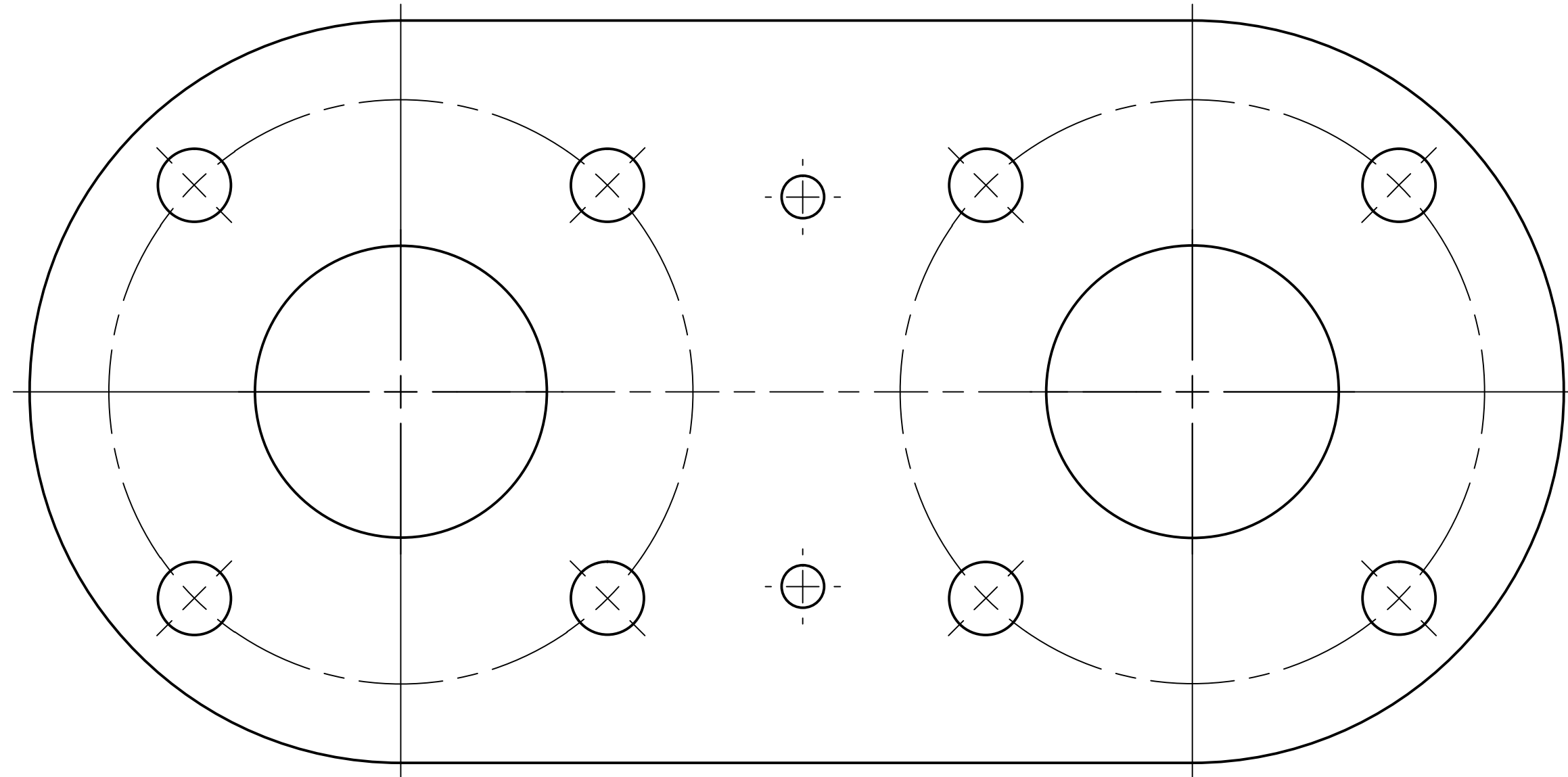

3" X 3" ANSI BOLTING PATTERN
PARALLEL INSTRUMENT TEE

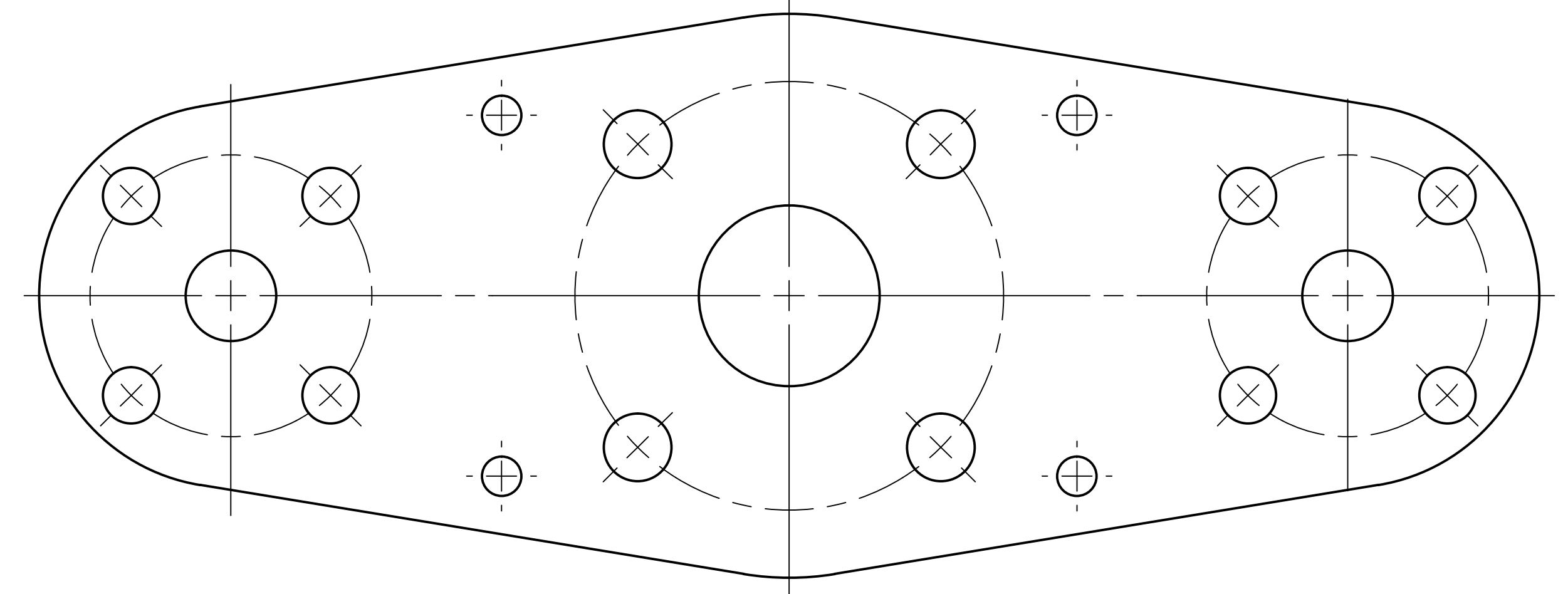

2" X 1" X 1" ANSI BOLTING PATTERN
PARALLEL INSTRUMENT TEE

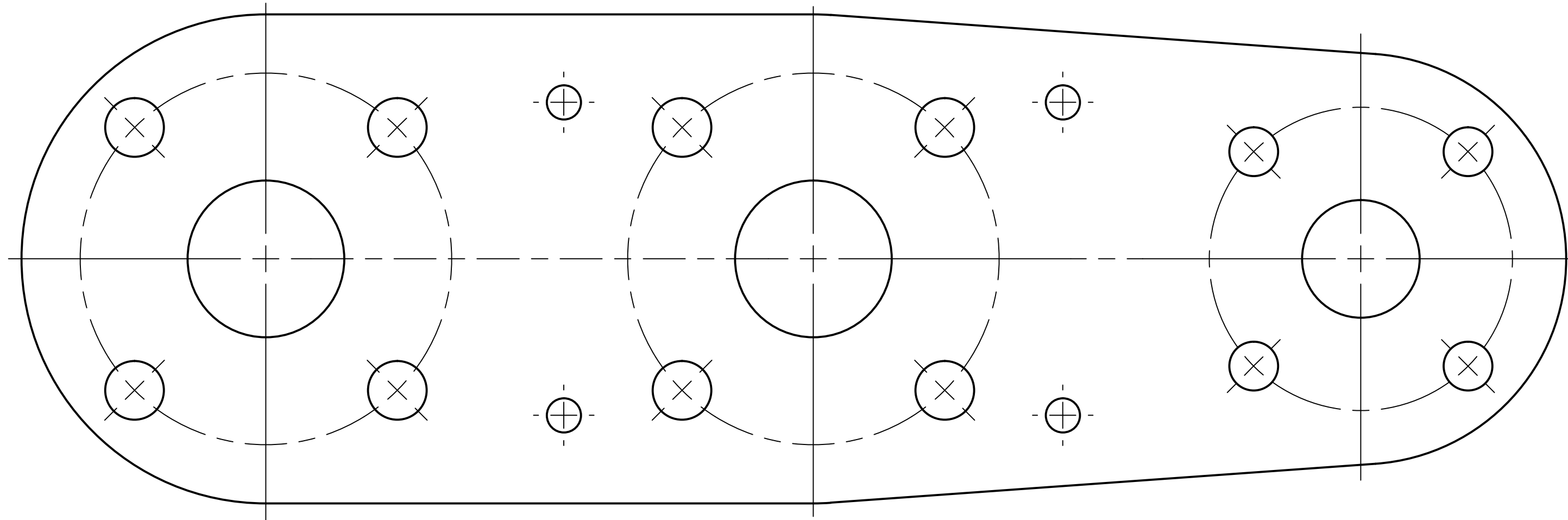

2" X 2" X 1 1/2" ANSI BOLTING PATTERN
PARALLEL INSTRUMENT TEE