

NO.	PART NAME	PART#	REQ'D	MATERIAL
1	PIPE BEND 5"	PDS5YPB	2	304 SS
2	SWIVEL GROOVE NIPPLE 5"	N52S4VG	2	304 SS
3	Y-PIPE TAB	PDS5YTB1	2	304 SS
4	Y-PIPE TAB	PDS5YTB2	2	304 SS
5	QUICK CONNECT ADAPTER 5"	PDK5AWBS4	1	304 SS

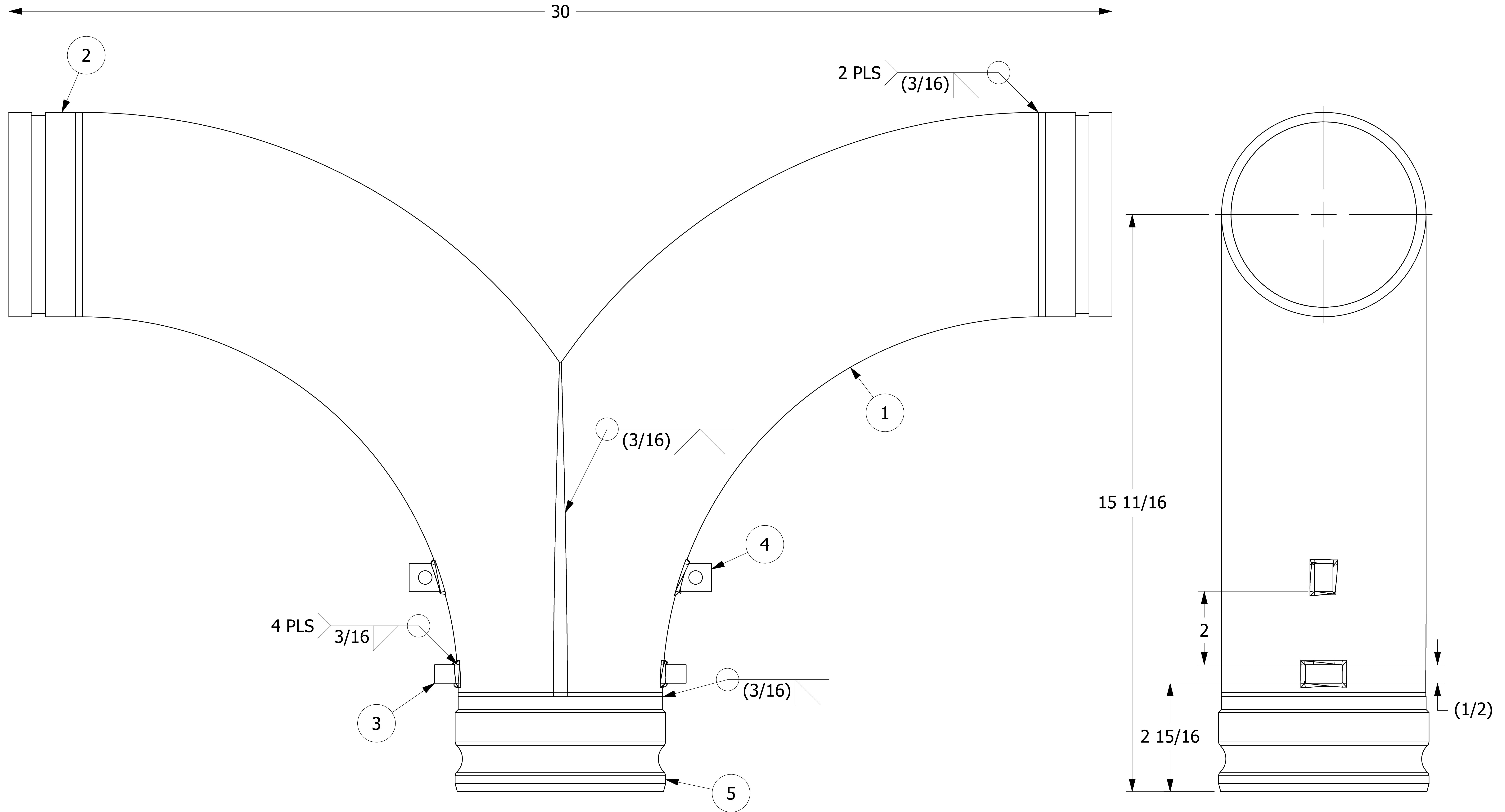

- NOTES:**
1. CLEAN ALL DEBRIS AND OIL, REMOVE ALL SHARP EDGES AND BURRS.
 2. APPLY PROTECTOR OVER KAM ADAPTER AND GROOVED NIPPLES.
 3. MUST PASS QAP4C-1.
 4. WELD MUST BE IN ACCORDANCE WITH AWS (OR APPROVED EQUIVALENT) BY CERTIFIED WELDERS. PROCEDURES TO BE VENDOR SUPPLIED AND SALCO APPROVED.

UNLESS OTHERWISE SPECIFIED DIMENSIONAL TOLERANCES		DRAWN BY:	CHL	A BG 7-18-12 NEW PART ADDED TO THE NETWORK	
FRACTIONAL:	±1/16	CHECKED BY:	PJG	REV BY DATE DESCRIPTION	
X.XX:	±.03	PROTOTYPE BY:	CHL		
X.XXX:	±.015	PROTOTYPE DATE:	3/18/2009		
ANGULAR:	±1°	APPROVED FOR PRODUCTION BY:	BG	Y-PIPE 5" PART NAME:	
THIRD ANGLE PROJECTION		PRODUCTION DATE:	7/18/2012	MATERIAL: SEE BOM PROJECT #: 090310 SHEET #: 1 OF 1 SCALE: 1:1	
				E26590 PDS5YF	