

4

3

2

1

B

B

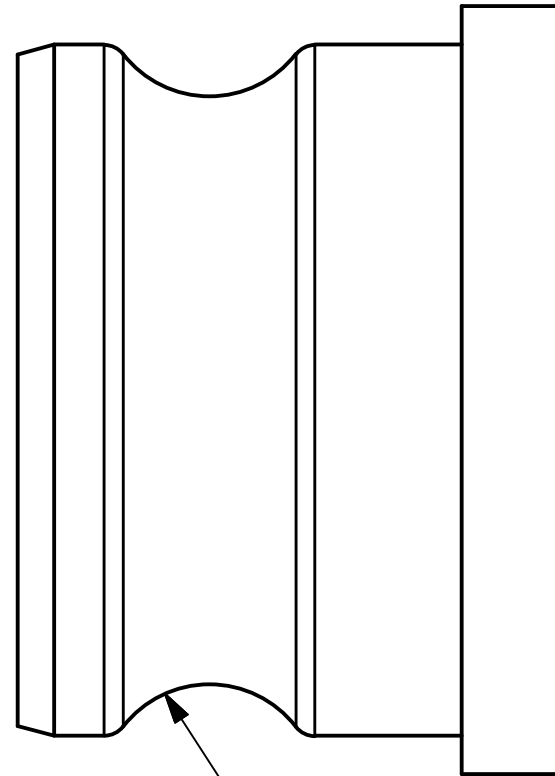

3" CAM GROOVE

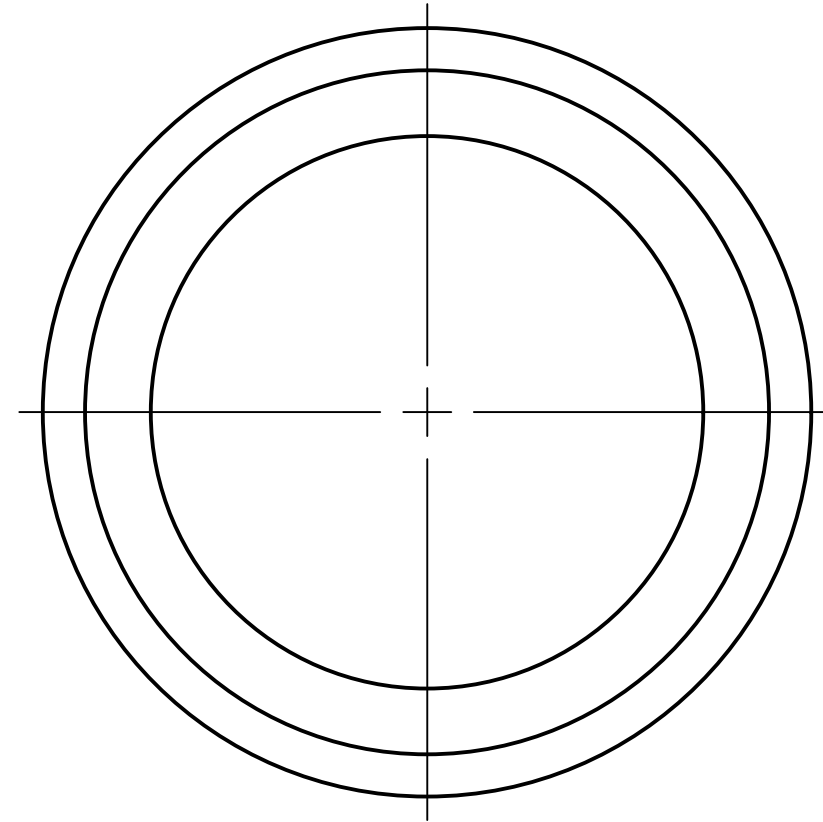

NOTE:
PRINT FOR REFERENCE ONLY.

A	WEB	12/9/19	UPDATED TO CURRENT STANDARDS; MATERIAL WAS ALUMINUM
REV	BY	DATE	DESCRIPTION

<small>UNLESS OTHERWISE SPECIFIED DIMENSIONAL TOLERANCES</small> FRACTIONAL: $\pm 1/16$ X.XX: $\pm .03$ X.XXX: $\pm .015$ ANGULAR: $\pm 1^\circ$ <small>DEBURR ALL SHARP EDGES. ALL MACHINED SURFACES TO HAVE A 125 RMS FINISH UNLESS NOTED OTHERWISE.</small>	DRAWN BY:	CHL
	CHECKED BY:	ACC
	PROTOTYPE DATE:	11/27/2001
	APPROVED FOR PRODUCTION BY:	ACC
	PRODUCTION DATE:	11/27/2001
	SIZE:	B
THIRD ANGLE PROJECTION	DRAWING #:	16446

SALCO PRODUCTS, INC.		
PART NAME: ADAPTER 3"		
MATERIAL: ASTM B26 356.0-T6		
PROJECT #: 010910	SHEET #: 1 OF 1	SCALE: 1:1
PART #: PT30AWSAL		

4

3

2

1

A

A