

NO.	PART NAME	PART #	REQ'D	MATERIAL
1	TOP FITTING CAP 2" THREADED	TE20SDLDC07A	1	316L SS
2	QUICK CONNECT 2" FLANGE	TE2SFAS	1	316L SS

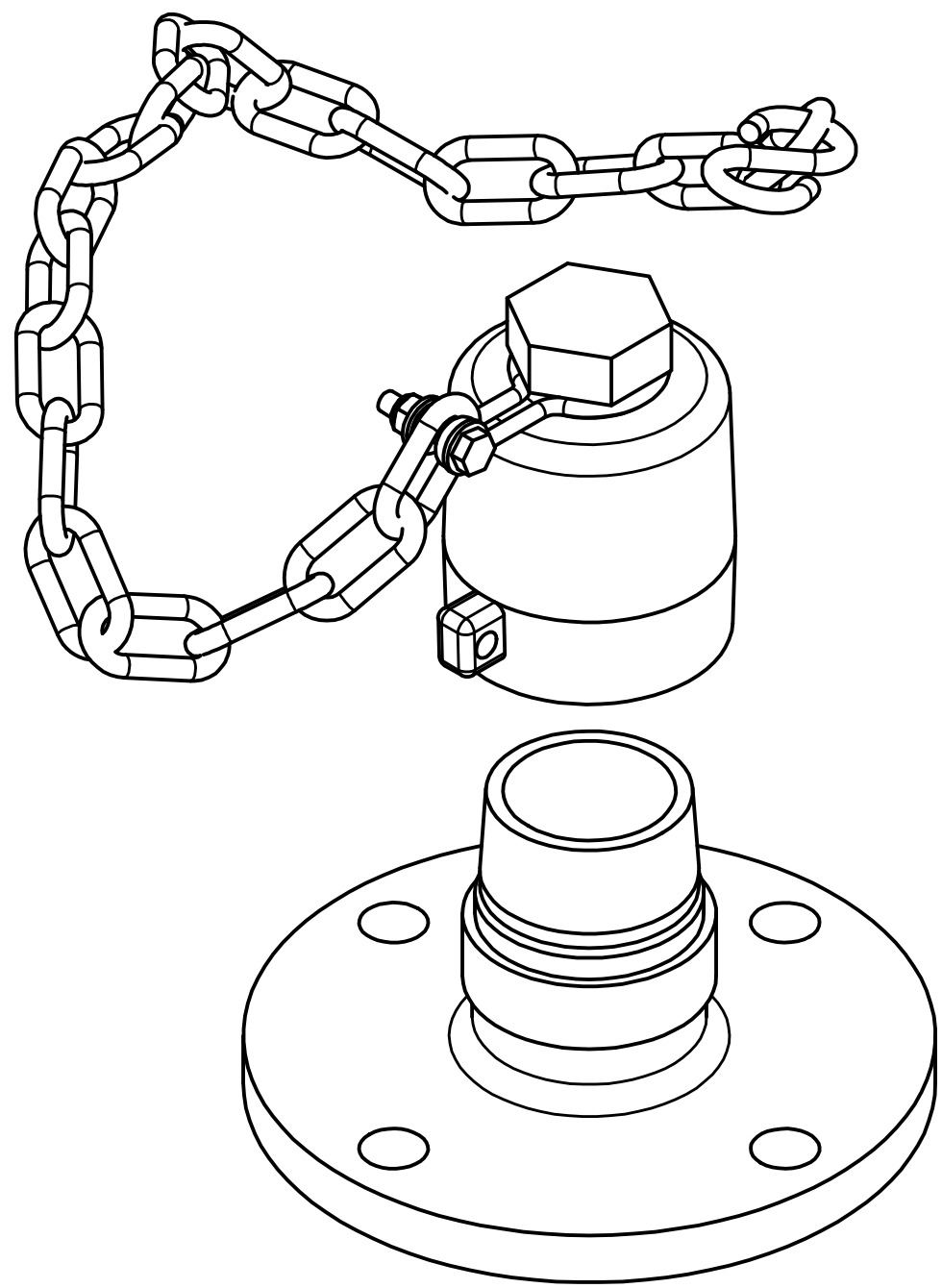

NOTE:  
CAP GASKET MATERIAL IS BLACK VITON B.

UNLESS OTHERWISE SPECIFIED  
DIMENSIONAL TOLERANCES  
FRACTIONAL: ±1/16  
X.XX: ±.03  
X.XXX: ±.015  
ANGULAR: ±1°  
DEBURR ALL SHARP EDGES.  
ALL MACHINED SURFACES TO  
HAVE A 125 RMS FINISH  
UNLESS NOTED OTHERWISE.

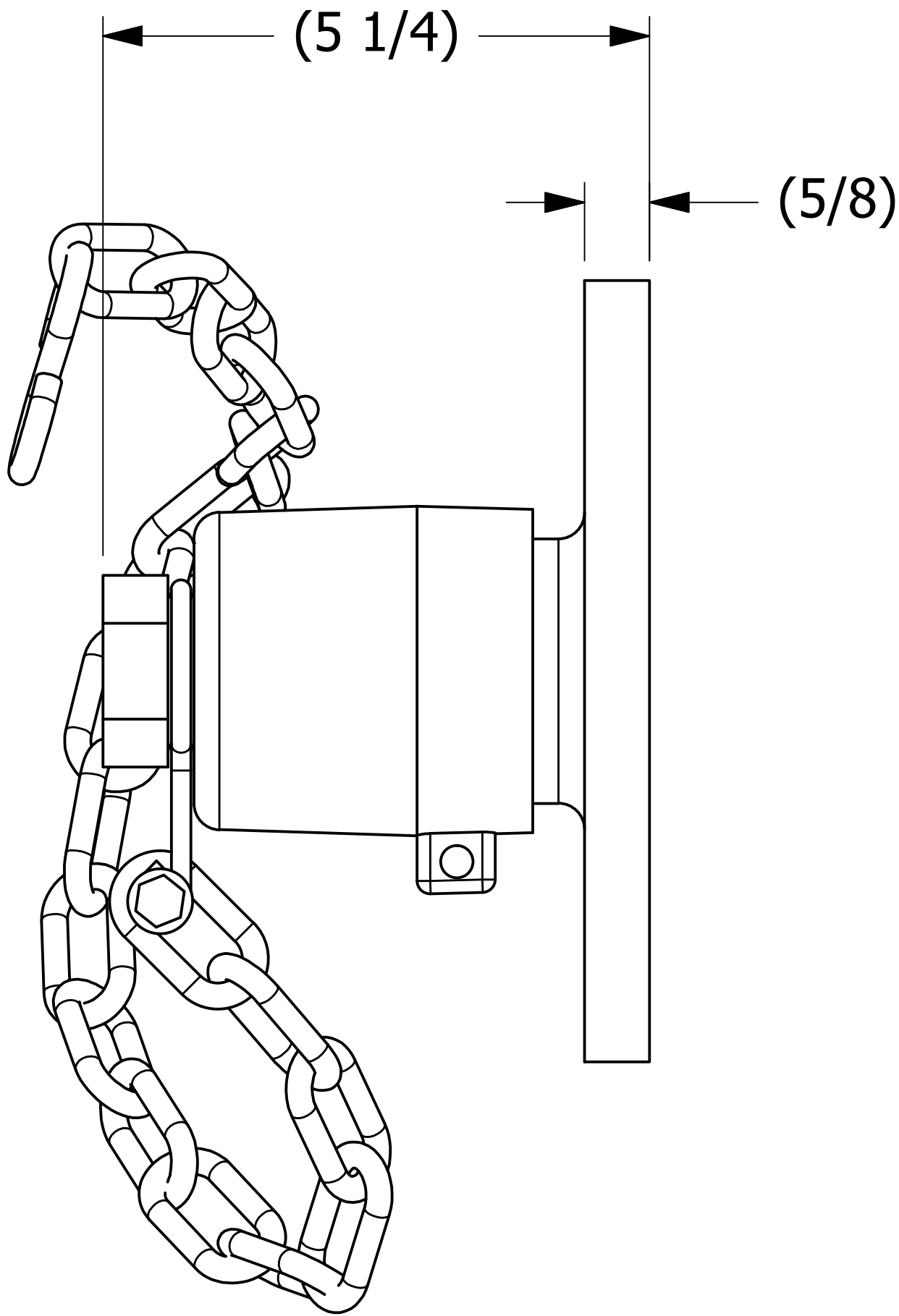
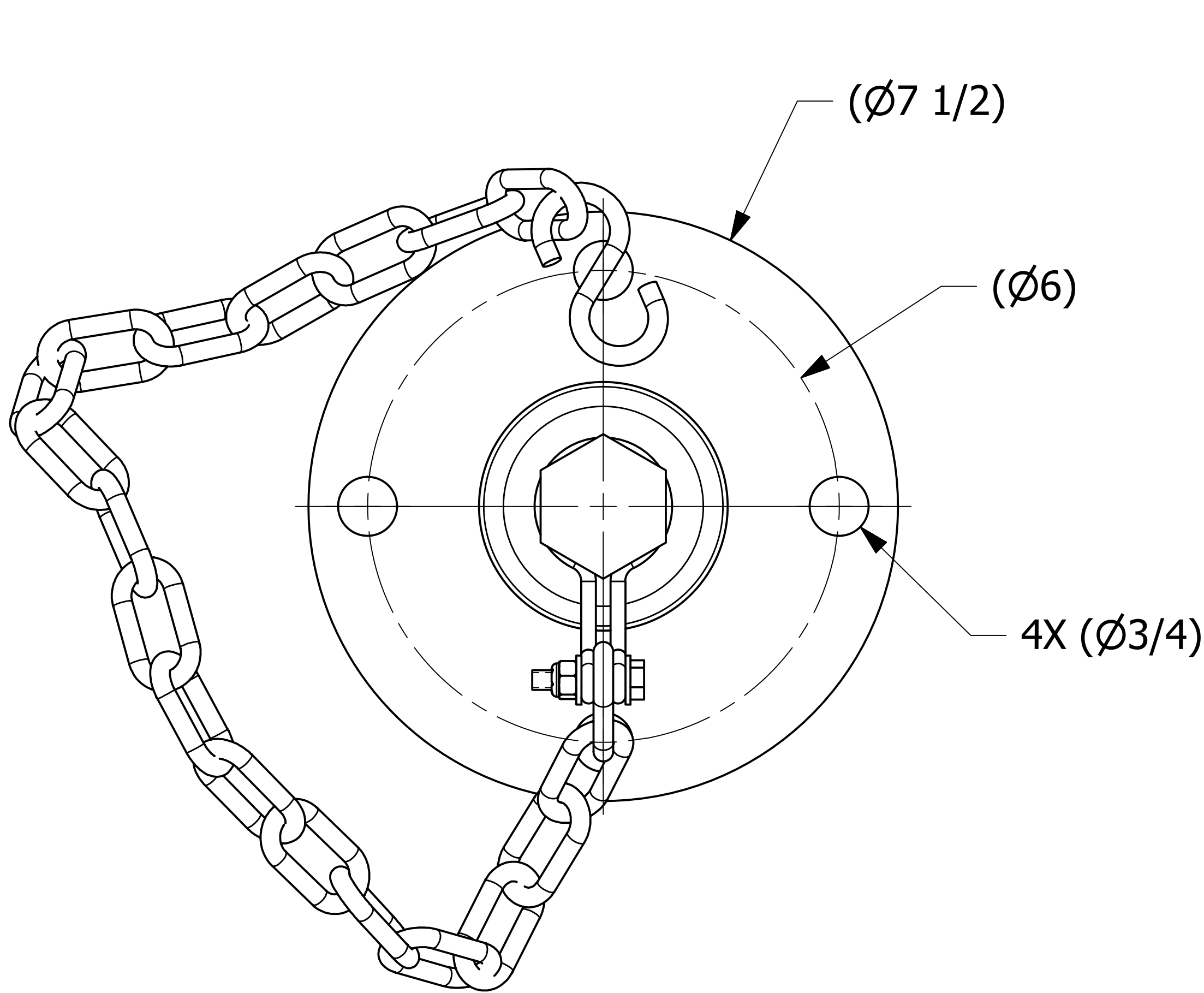
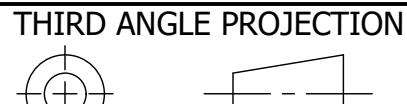

DRAWN BY:	GS
CHECKED BY:	CHL
PROTOTYPE BY:	GS
PROTOTYPE DATE:	11/5/2003
APPROVED FOR PRODUCTION BY:	CHL
PRODUCTION DATE:	5/31/2012

B	CHL	1-9-19	UPDATED BOM, NOTE, ADDED SIDE VIEW & DIMENSIONS
A	GS	5-31-12	DRAWING ADDED TO NETWORK.
REV	BY	DATE	DESCRIPTION
 <b>SALCO PRODUCTS, INC.</b>			
PART NAME: <b>QUICK CONNECT 2" FLANGED</b>			
MATERIAL: <b>SEE BOM/NOTE</b>			
PROJECT #:	1210251	SHEET #:	1 OF 1
DRAWING #:	D33147	PART #:	TE20SDL07FA
SCALE: <b>1:1</b>			