

NO.	PART NAME	PART#	REQ'D	MATERIAL
1	SHEET 2"	SHT2UHR	.93 SQ FT	SALCO PE
2	PARALLEL INSTRUMENT TEE PLUG	HSPITPLG1	2	SALCO PE

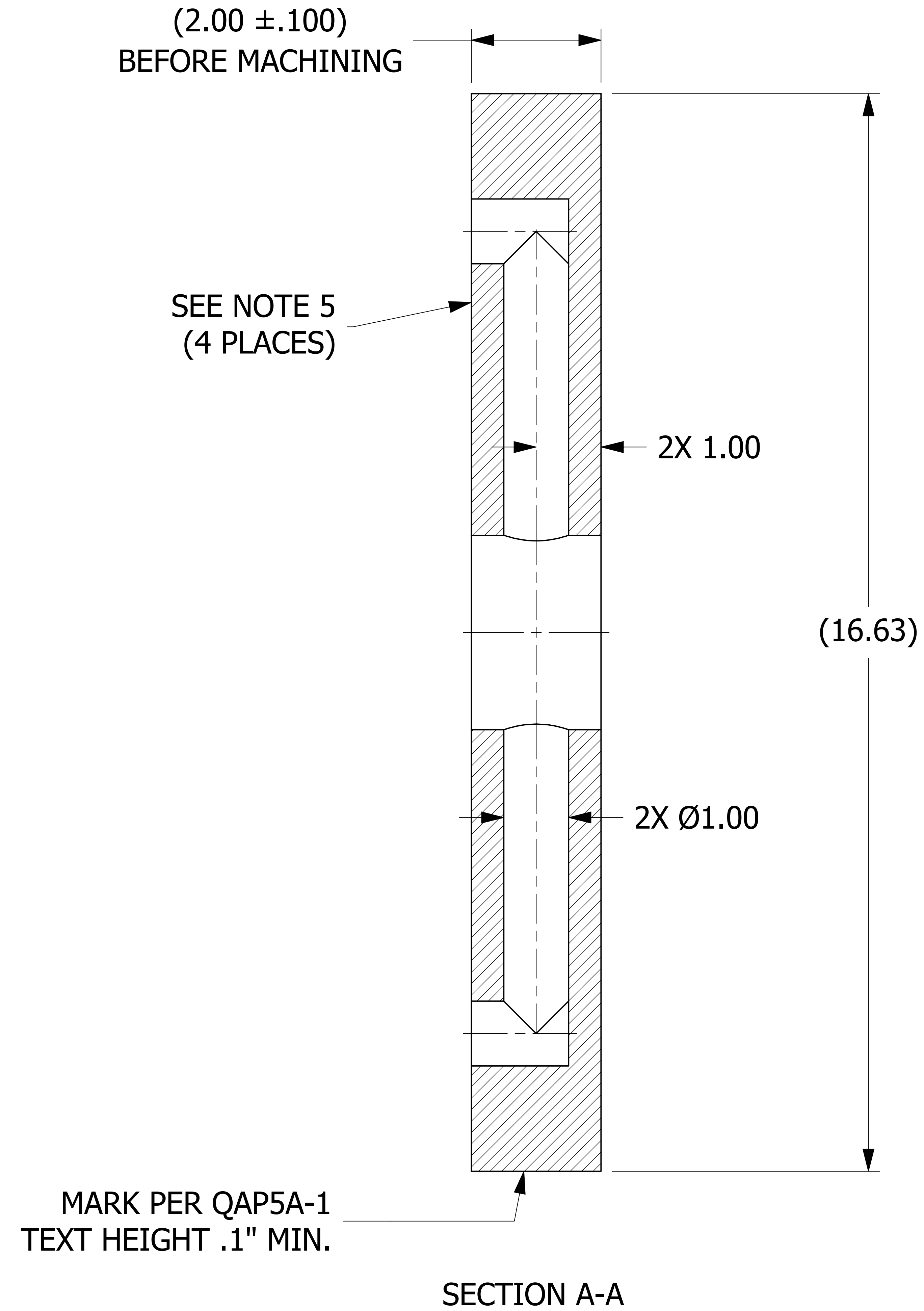
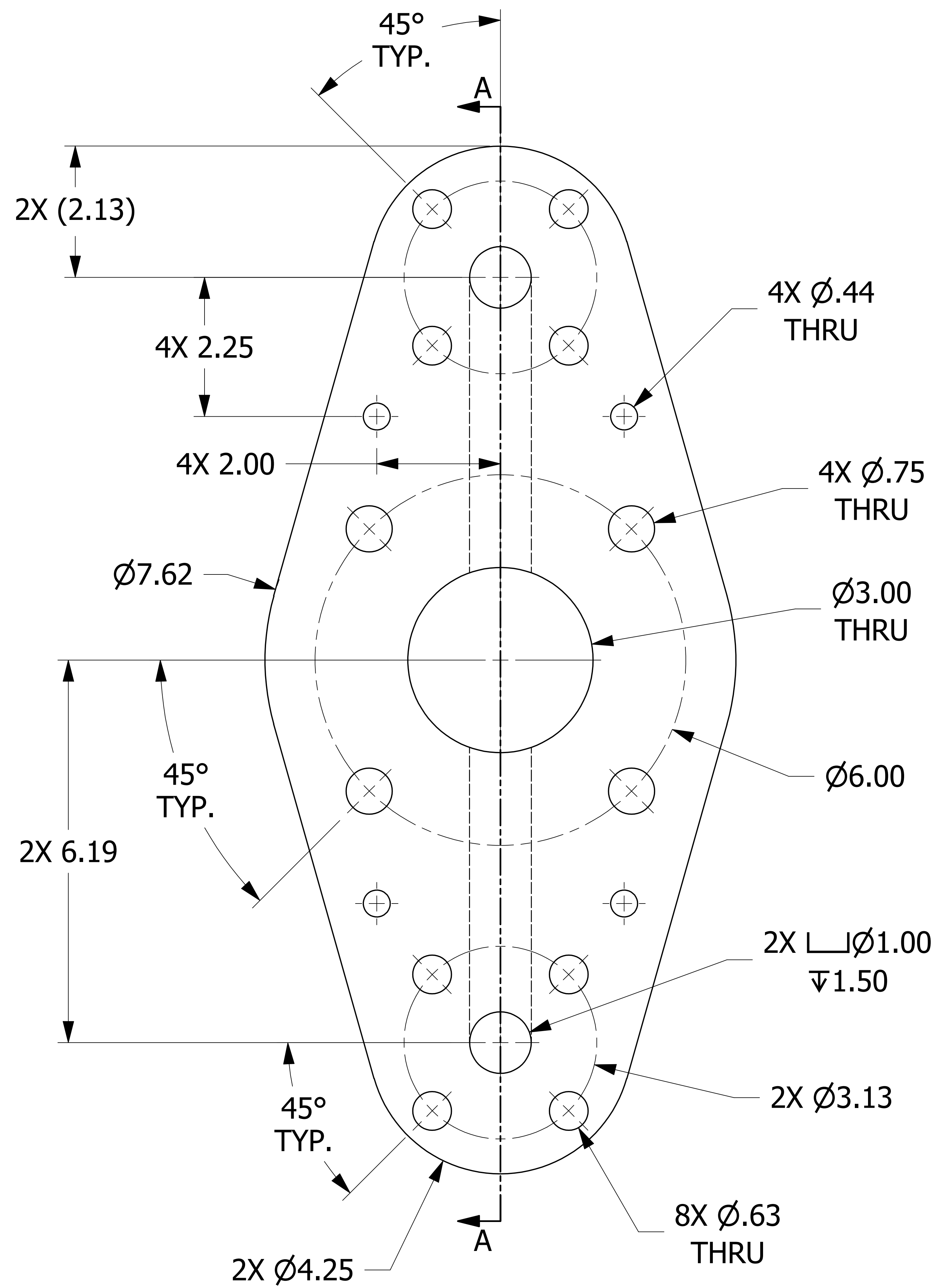

NOTES:

1. SEE DOCUMENT DSS 1 FOR MATERIAL SPECIFICATIONS.
2. SEE DOCUMENT QAP5A-1 FOR MARKING PROCEDURE.
3. SEE DOCUMENT DSS 3 FOR FRICTION WELDING SPECIFICATIONS.
4. AAR APPROVAL #E-099017.
5. SEE DOCUMENT DSS 5 FOR SERRATED GASKET SPECIFICATIONS.

REV	BY	DATE	DESCRIPTION
D	WEB	6-11-14	ADDED ±.100 TOLERANCE, UPDATED NOTES
C	KHK	1-30-13	UPDATED TO CURRENT DRAFTING STANDARDS, NOTE
B	REH	12-10-10	INCREASED FIXTURE HOLE DIAMETER TO .438
A	BRG	2-24-08	THROUGH HOLE WAS .88

UNLESS OTHERWISE SPECIFIED DIMENSIONAL TOLERANCES FRACTIONAL: ±1/16 X.XX: ±.03 X.XXX: ±.015 ANGULAR: ±1° DEBURR ALL SHARP EDGES. ALL MACHINED SURFACES TO HAVE A 125 RMS FINISH UNLESS NOTED OTHERWISE.	DRAWN BY: WRB	CHECKED BY: ACC	PROTOTYPE BY: WRB	PROTOTYPE DATE: 3/23/2007	APPROVED FOR PRODUCTION BY: PJG	PRODUCTION DATE: 11/2/2007
THIRD ANGLE PROJECTION						

SALCO PRODUCTS, INC.			
PARALLEL INSTRUMENT TEE 3" X 1" X 1"			
SEE BOM/NOTE			
PROJECT #:	030708	SHEET #:	1 OF 1
DRAWING #:	E23350	PART #:	HSPIT3X1X1
		SCALE:	1:1