

NO.	PART NAME	PART#	REQ'D	MATERIAL
1	PIPE NIPPLE 1/2"	A28211	1	ASTM A312 TP316
2	CONCENTRIC REDUCER 4"X3"	C49770	1	ASME SA403 304L SS
3	BALL VALVE 1/2" THREADED	CA76F-103-24-SP1	1	316 SS
4	ELBOW 4"X4"X45°	D49769	1	AISI S31600
5	ADAPTER 3"	PT30AWBS	1	AISI S31600
6	ADAPTER GASKET 5 1/4" RR	SSA4G3	1	BLACK EPDM SC
7	PLUG ASSEMBLY 1/2"	TC054PAH	1	416/304 SS

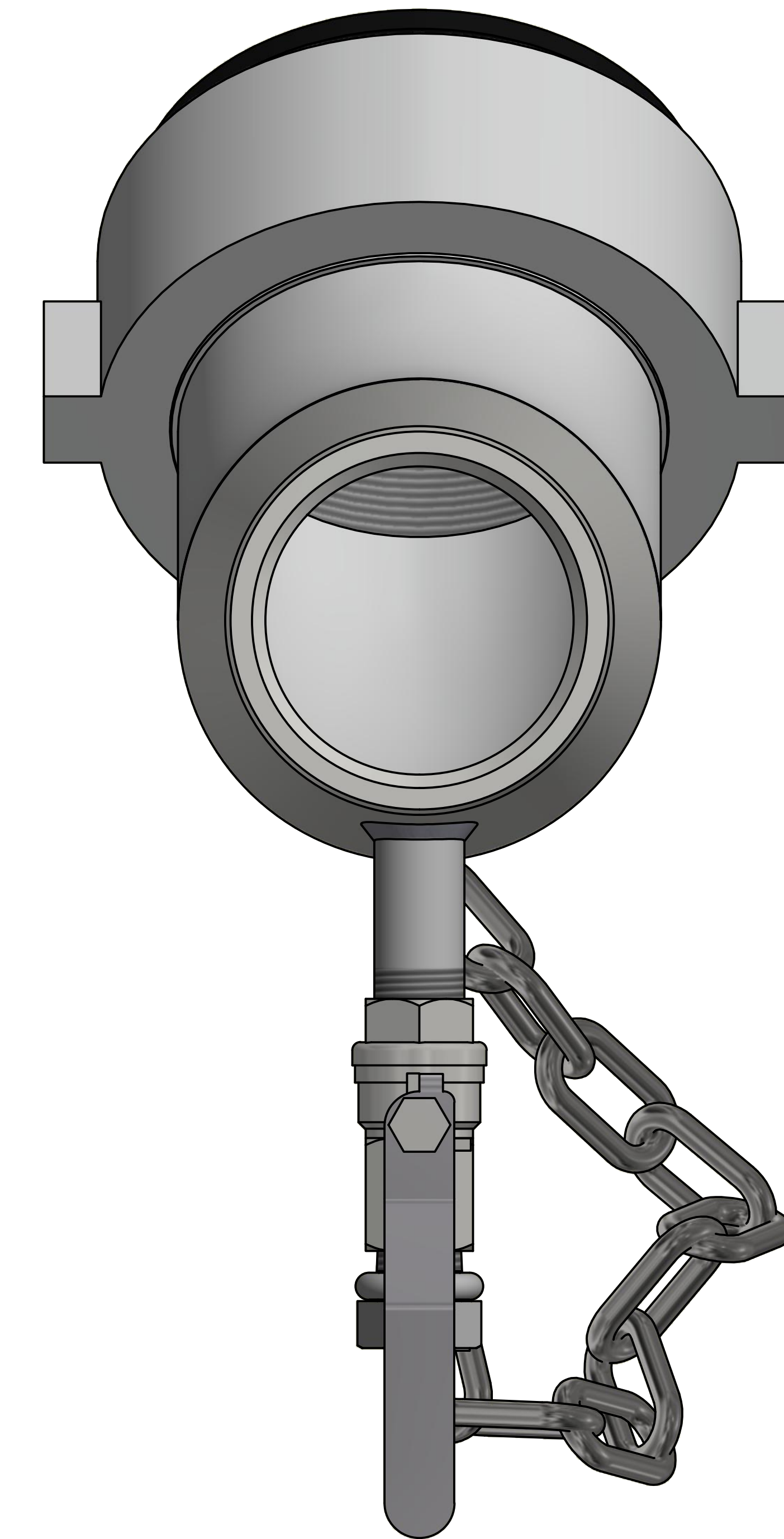
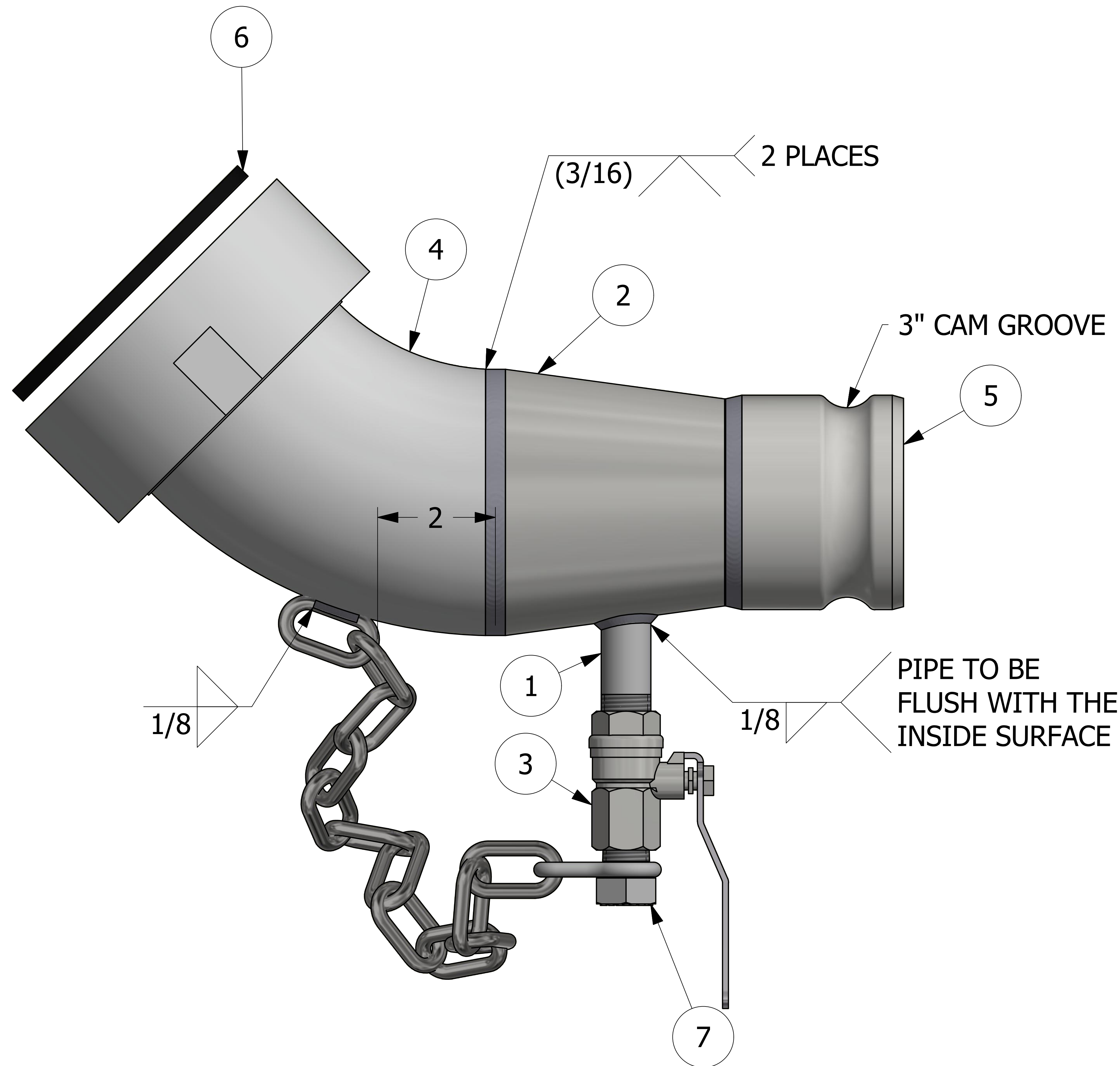

NOTES:

1. ALL INTERNAL SURFACES TO BE GROUND FLUSH TO PREVENT PRODUCT ENTRAPMENT.
2. ELBOW AND REDUCER ARE BOTH SCH. 40.
3. SEE DOCUMENTS WPS-E-03, WPS-F05, WPS-M07, WPS-T06 FOR WELDING SPECIFICATIONS.
4. WELD ACCEPTANCE CRITERIA TO MEET DOCUMENT D-005.
5. TEST PER Q-2.15.7.
6. PARTS TO BE SHIPPED SEPARATELY WITH THREAD PROTECTORS ON ALL NPT THREADS.

REV	BY	DATE	DESCRIPTION
E	WEB	1/26/21	ADDED CHAIN WELD & LOCATION
D	CHL	11/14/19	REPALCED 1/2BWEV6, CRS4X3 & U44S4FM1101 W/CA76F-103-24-SP1, C49770 & D49769, UPDATED WELD NOTES
C	WEB	7/2/18	UPDATED WELD NOTE TO DSS 13, ADDED TESTING NOTE, ADDED NOTE 5, SORTED BOM
B	CHL	9/30/11	REPLACED CRS4X2,U44S4FM1108 W/CRS4X3,U44S4FM1101
A	CHL	6/23/11	DRAWING ADDED TO NETWORK

UNLESS OTHERWISE SPECIFIED DIMENSIONAL TOLERANCES FRACTIONAL: ±1/16 X.XX: ±.03 X.XXX: ±.015 ANGULAR: ±1° DEBURR ALL SHARP EDGES. ALL MACHINED SURFACES TO HAVE A 125 RMS FINISH UNLESS NOTED OTHERWISE. THIRD ANGLE PROJECTION	DRAWN BY: REH CHECKED BY: WRB PROTOTYPE DATE: 10/4/2010 APPROVED FOR PRODUCTION BY: WRB PRODUCTION DATE: 6/23/2011 SIZE: E DRAWING #: 29629
--	---

SALCO PRODUCTS, INC.

UNLOADING ELBOW 4"X3" 45°

SEE BOM

PROJECT #: **WAG0780** SHEET #: **1 OF 1** SCALE: **1:1**

PART #: **U43S4FM1502**