

| NO. | PART NAME | PART# | REQ'D | MATERIAL |
|-----|-----------------------|--------|-------|--------------|
| 1 | EYEBOLT 1"X6" | EBR16H | 1 | CARBON STEEL |
| 2 | HEAVY SQUARE NUT 1"-8 | N1 | 1 | CARBON STEEL |
| 3 | FLAT WASHER 1" | WASH1P | 1 | CARBON STEEL |

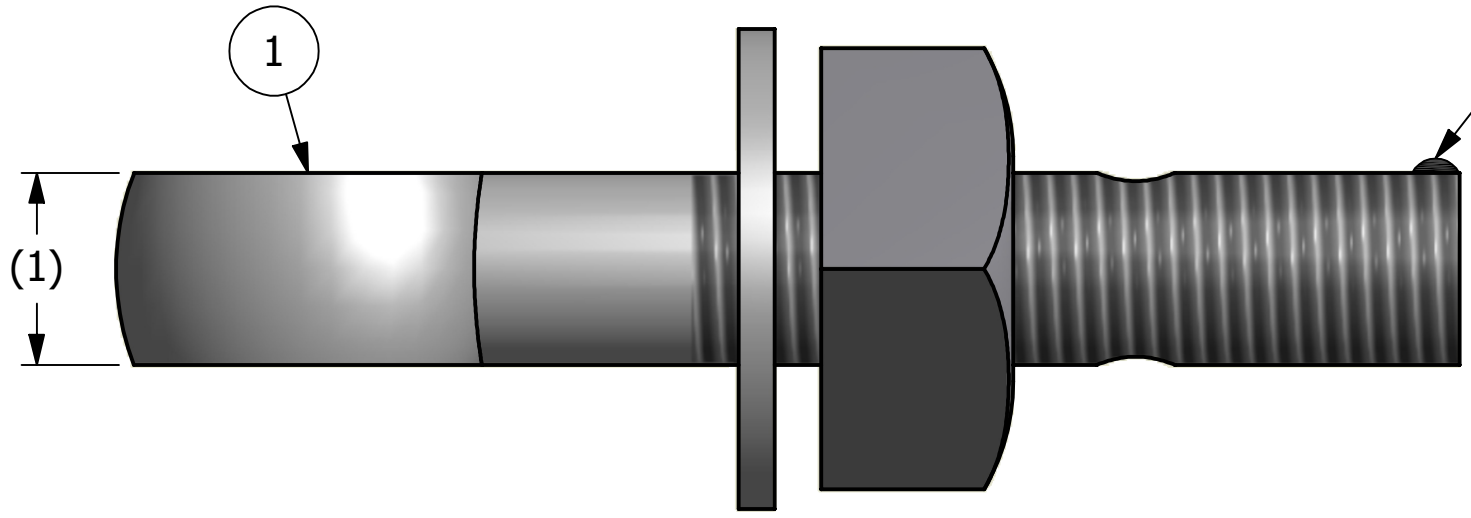

APPLY A BEAD OF WELD TO THE TWO END THREADS AFTER INSTALLING WASHER AND NUT

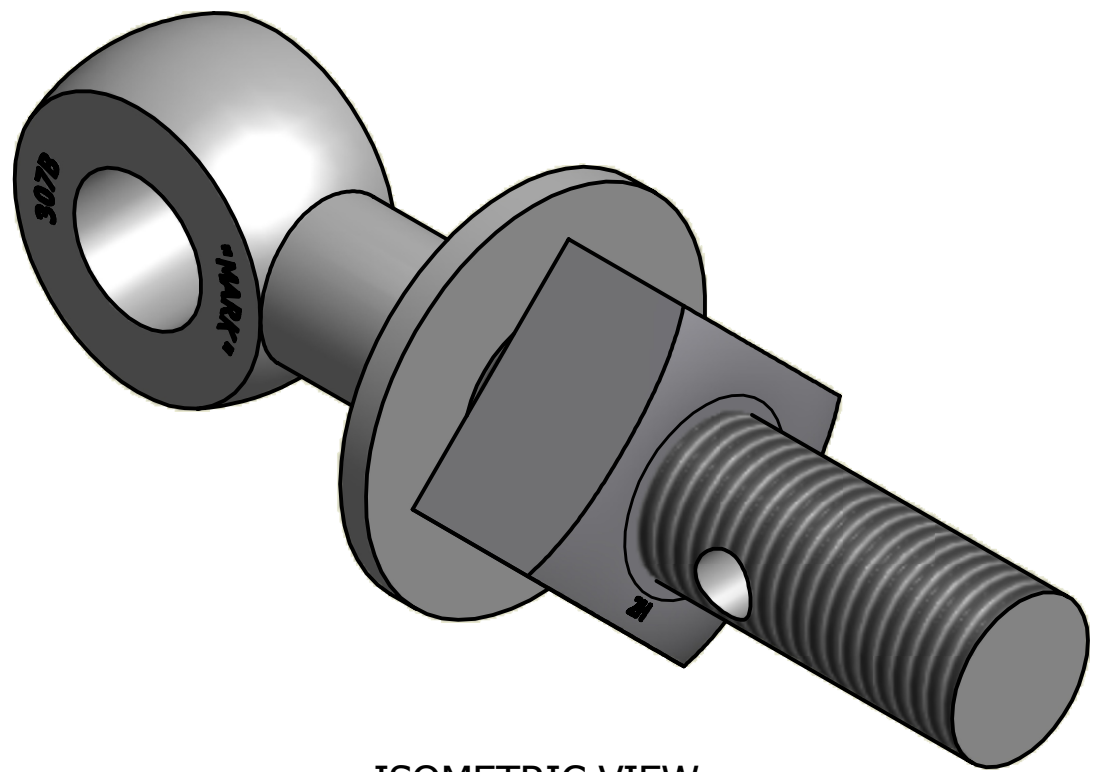

ISOMETRIC VIEW

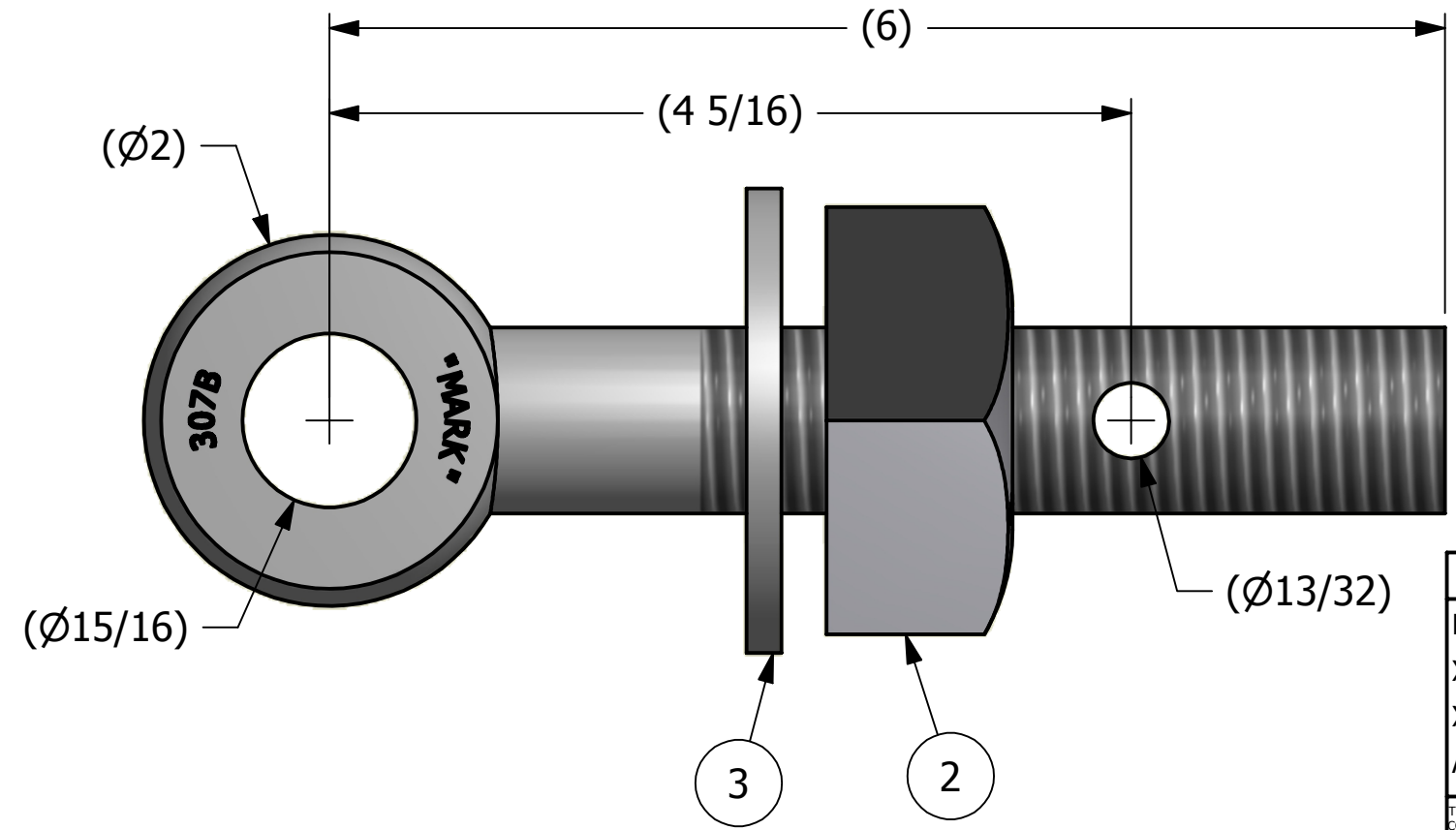

| REV | BY | DATE | DESCRIPTION |
|-----|-----|---------|-------------------------------------|
| C | CHL | 1-25-12 | CHANGED EYEBOLT MATERIAL |
| B | CHL | 4-25-01 | REPLACED WASH1 WITH WASH1P |
| A | FOD | 8-4-99 | UPDATED B.O.M., ITEM # 1 WAS EBR16H |

| | | | |
|--|-------|-----------------------------|-----------|
| UNLESS OTHERWISE SPECIFIED DIMENSIONAL TOLERANCES | | DRAWN BY: | FOD |
| FRACTIONAL: | ±1/16 | CHECKED BY: | SAB |
| X.XX: | ±.03 | PROTOTYPE BY: | FOD |
| X.XXX: | ±.015 | PROTOTYPE DATE: | 5/11/1999 |
| ANGULAR: | ±1° | APPROVED FOR PRODUCTION BY: | SAB |
| THIS PRINT, PROPERTY OF SALCO PRODUCTS INC., CONTAINS PROPRIETARY INFORMATION AND MUST NOT BE COPIED, REPRODUCED, OR USED DETRIMENTALLY TO OUR INTEREST. | | PRODUCTION DATE: | 5/11/1999 |
| THIRD ANGLE PROJECTION | | | |

SALCO PRODUCTS, INC.

PART NAME: **EYEBOLT ASSEMBLY 1"X6"**

MATERIAL: **SEE BOM**

PROJECT #: _____ SHEET #: **1 OF 1** SCALE: **1:1**

DRAWING #: **B13425** PART #: **EB16HA**

