

NO.	PART NAME	PART#	REQ'D	MATERIAL
1	EYEBOLT 7/8"X5 1/2"	EBR7855H	1	1045 CS
2	HEAVY SQUARE NUT 7/8" - 9	N78	1	CARBON STEEL
3	FLAT WASHER 7/8" USS	WASH78T	1	CARBON STEEL

APPLY A BEAD OF WELD TO THE TWO END THREADS AFTER INSTALLING WASHER AND NUT

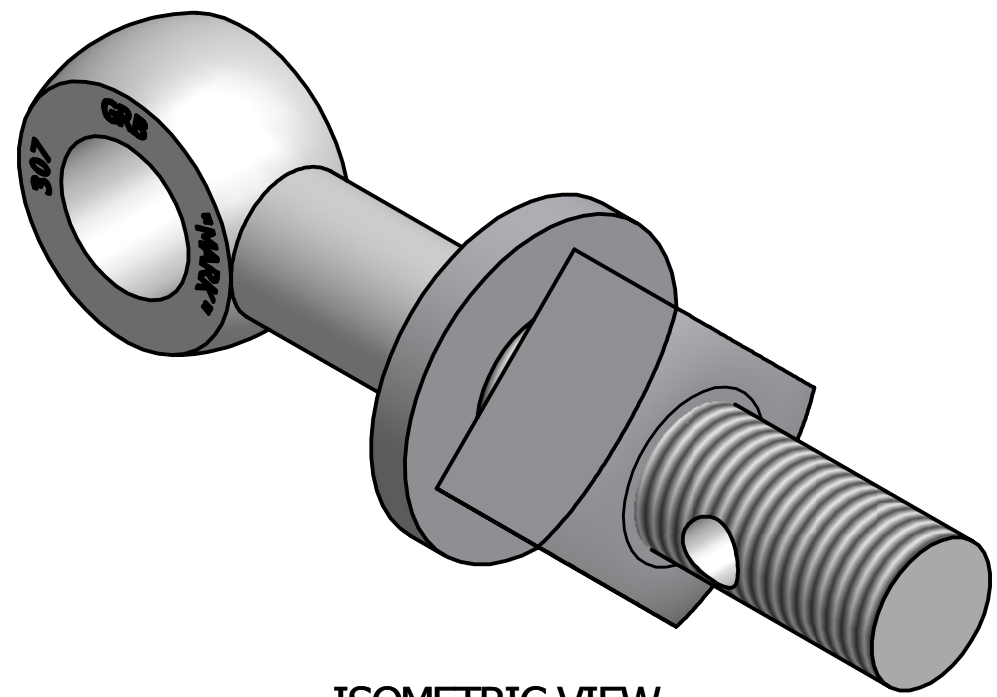

ISOMETRIC VIEW

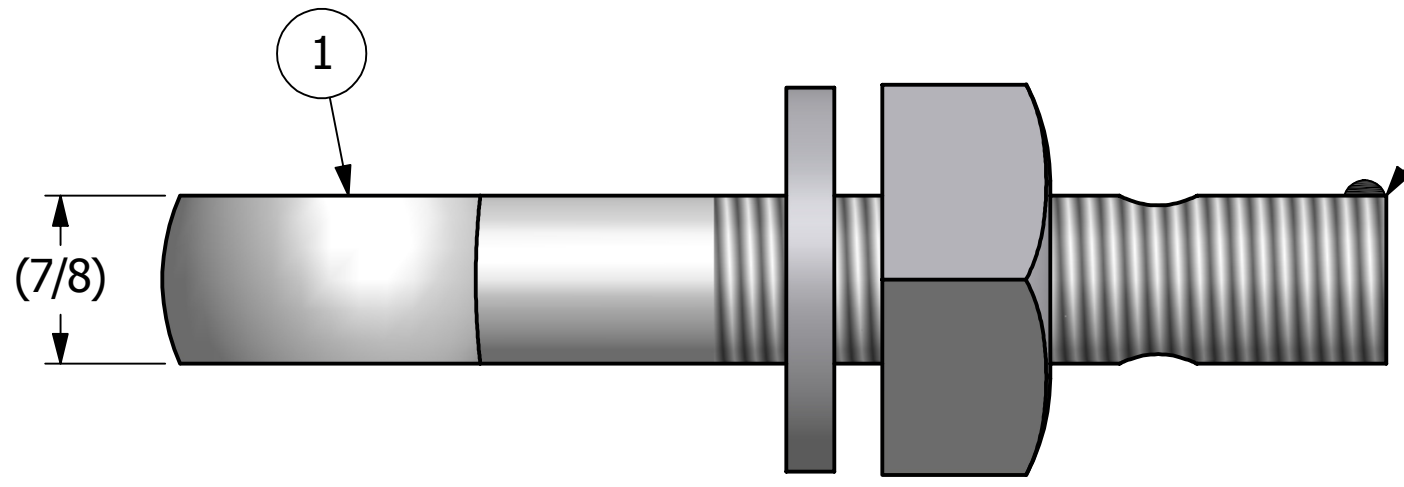
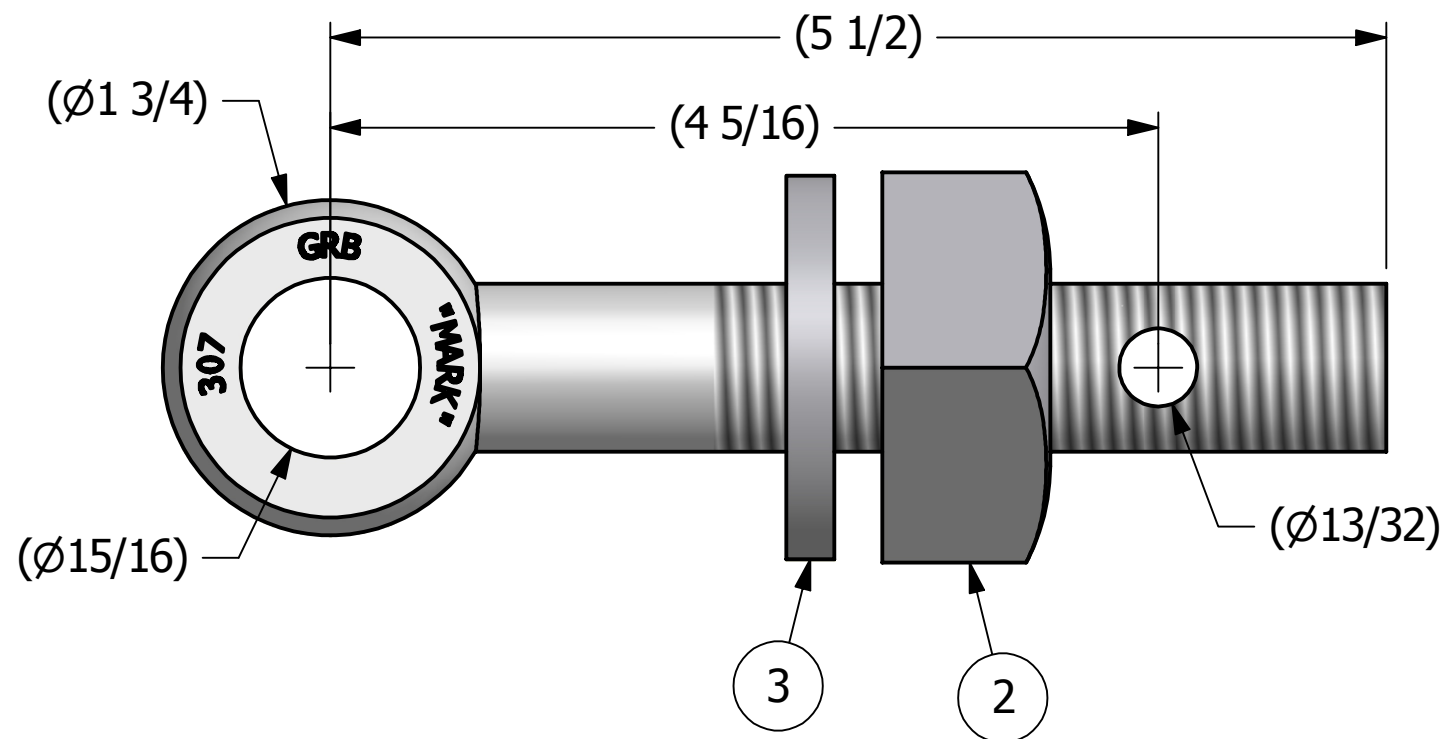

REV	BY	DATE	DESCRIPTION
E	CHL	7-25-07	REPLACED EBR7855HR WITH WBR7855H & RPLACED A16204 WITH WELD STOP
D	CHL	6-10-02	CHANGED MATERIAL OF WASH478T
C	CHL	11-26-01	REPLACED SN14S W/A16204
B	FOD	8-5-99	UPDATED BOM, ITEM #1 WAS EB7855HR
A	FOD	5-26-99	CHANGED PAT# ON ITEM #1 WAS EB7855H & UPDATED DRAWING WITH NEW STANDARDS

UNLESS OTHERWISE SPECIFIED DIMENSIONAL TOLERANCES	DRAWN BY:	TJN
FRACTIONAL: ±1/16	CHECKED BY:	
X.XX: ±.03	PROTOTYPE BY:	TJN
X.XXX: ±.015	PROTOTYPE DATE:	5/28/1993
ANGULAR: ±1°	APPROVED FOR PRODUCTION BY:	
THIS PRINT, PROPERTY OF SALCO PRODUCTS INC. CONTAINS PROPRIETARY INFORMATION AND MUST NOT BE COPIED, REPRODUCED, OR USED DETRIMENTALLY TO OUR INTEREST.	PRODUCTION DATE:	
THIRD ANGLE PROJECTION		

SALCO PRODUCTS, INC.

PART NAME: **EYEBOLT ASSEMBLY 7/8"X5 1/2"**

MATERIAL: **SEE BOM**

PROJECT #: _____ SHEET #: **1 OF 1** SCALE: **1:1**

DRAWING #: **B5442** PART #: **EB7855HA**