

NO.	PART NAME	PART#	REQ'D	MATERIAL
1	EYEBOLT 7/8"X6 1/2"	EBR7865HFTR	1	CARBON STEEL
2	EYEBOLT SAFETY COLLAR 7/8"	COLLAR78S3T3	1	303 SS
3	HEAVY SQUARE NUT 7/8"-9	N78	1	CARBON STEEL
4	FLAT WASHER 7/8"	WASH78T	1	CARBON STEEL
5	HUCK RIVET 1/4"X13/16"	A16204	1	304 SS

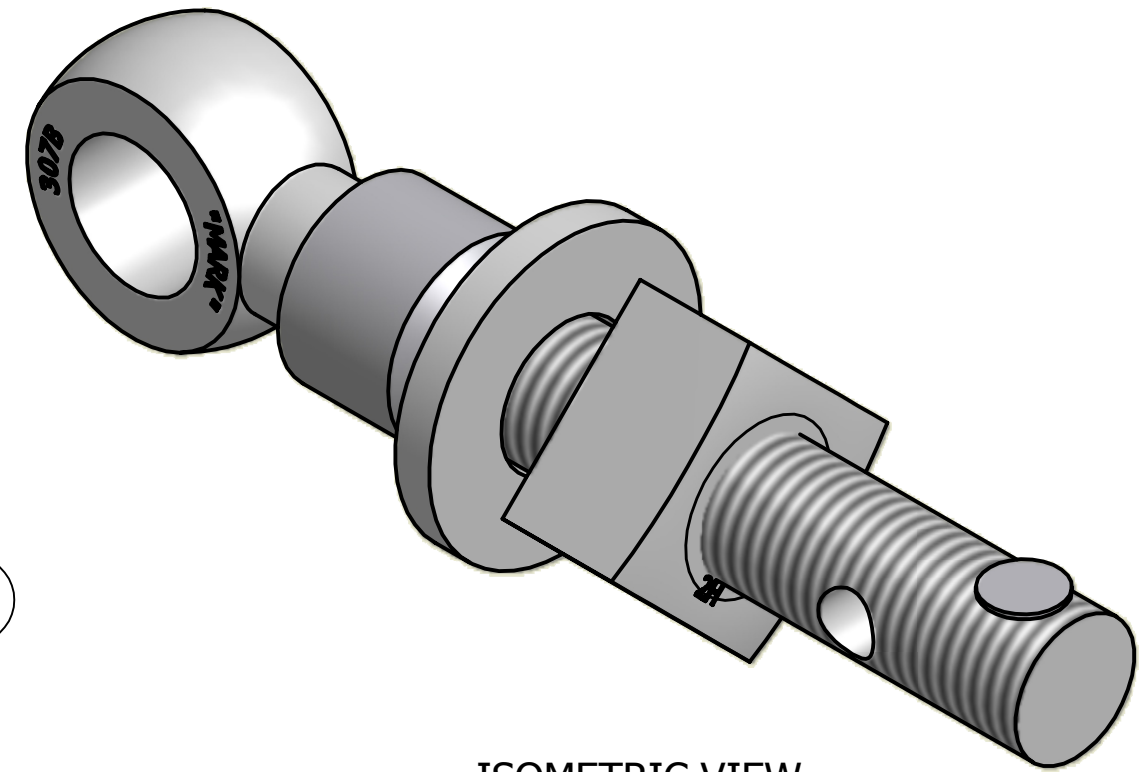

ISOMETRIC VIEW

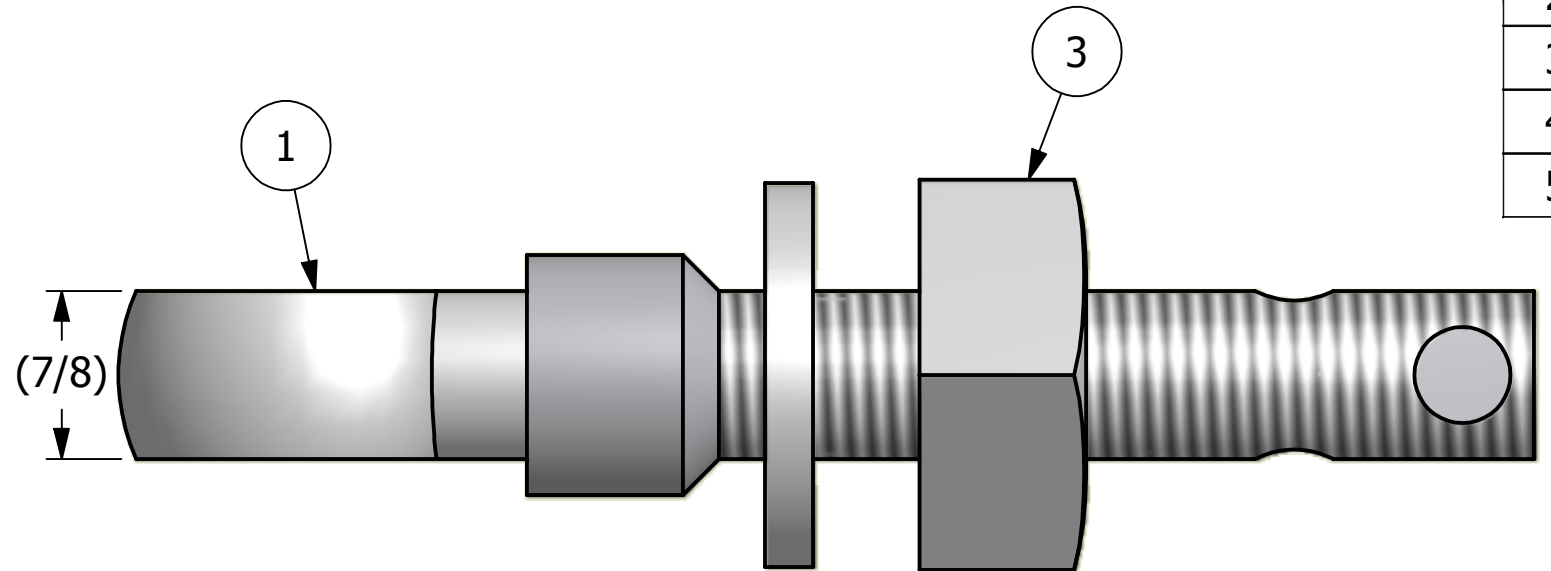
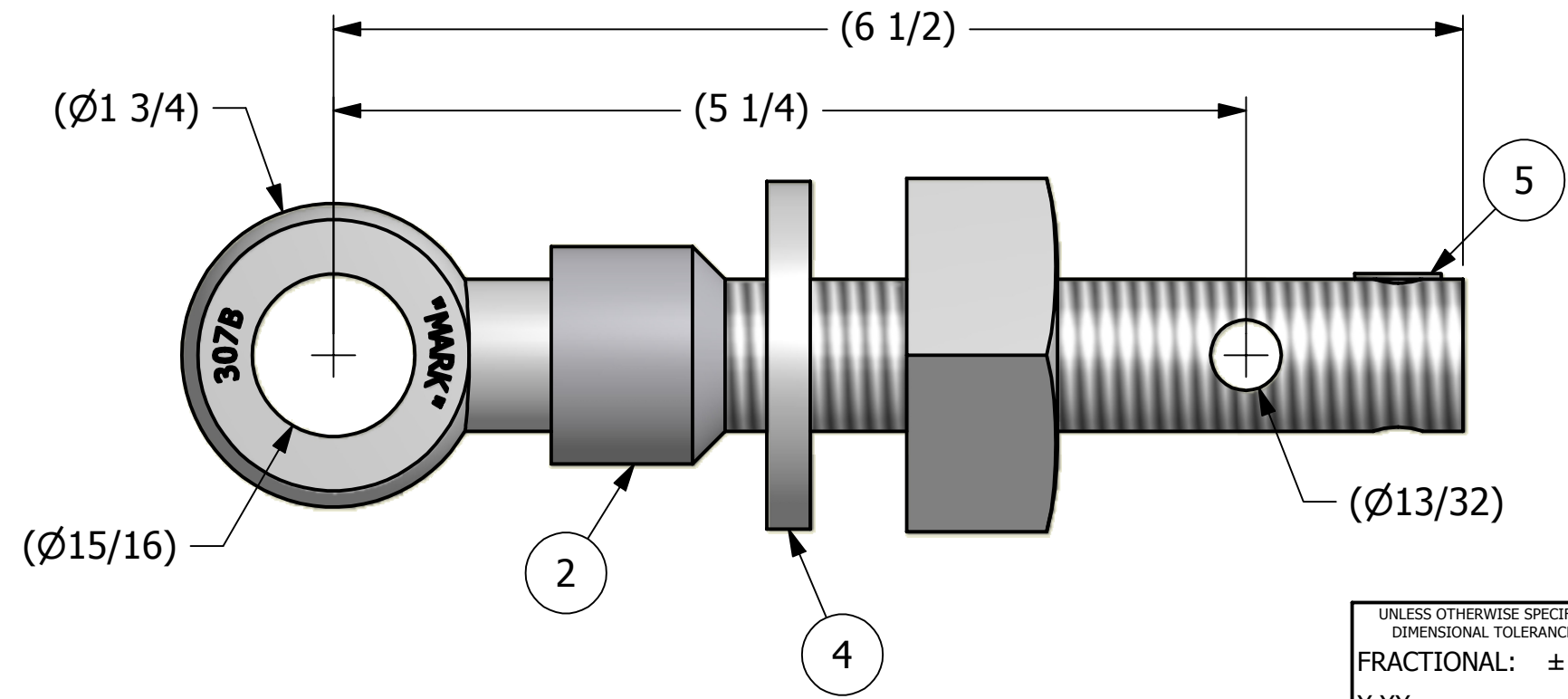

A	CHL	6-10-10	NEW PART ADDED TO SYSTEM
REV	BY	DATE	DESCRIPTION

<small>UNLESS OTHERWISE SPECIFIED DIMENSIONAL TOLERANCES</small> FRACTIONAL: ±1/16 X.XX: ±.03 X.XXX: ±.015 ANGULAR: ±1° <small>DEBURR ALL SHARP EDGES. ALL MACHINED SURFACES TO HAVE A 125 RMS FINISH UNLESS NOTED OTHERWISE.</small> THIRD ANGLE PROJECTION	DRAWN BY:	CHL
	CHECKED BY:	VD
	PROTOTYPE BY:	CHL
	PROTOTYPE DATE:	4/27/2010
	APPROVED FOR PRODUCTION BY:	VD
	PRODUCTION DATE:	6/10/2010

SALCO PRODUCTS, INC.

PART NAME: **EYEBOLT ASSEMBLY 7/8"X6 1/2"**

MATERIAL: **SEE BOM**

PROJECT #: **WAG0784** SHEET #: **1 OF 1** SCALE: **1:1**

DRAWING #: **B28583** PART #: **EB7865HFTATC3**

THIS PRINT, PROPERTY OF SALCO PRODUCTS INC., CONTAINS PROPRIETARY INFORMATION AND MUST NOT BE COPIED, REPRODUCED, OR USED DETRIMENTALLY TO OUR INTEREST.