

NO.	PART NAME	PART#	REQ'D	MATERIAL
1	INSERT 2"	A35587	1	316L SS
2	PIPE FLANGE 7 1/2" BC	C36334	1	316L SS

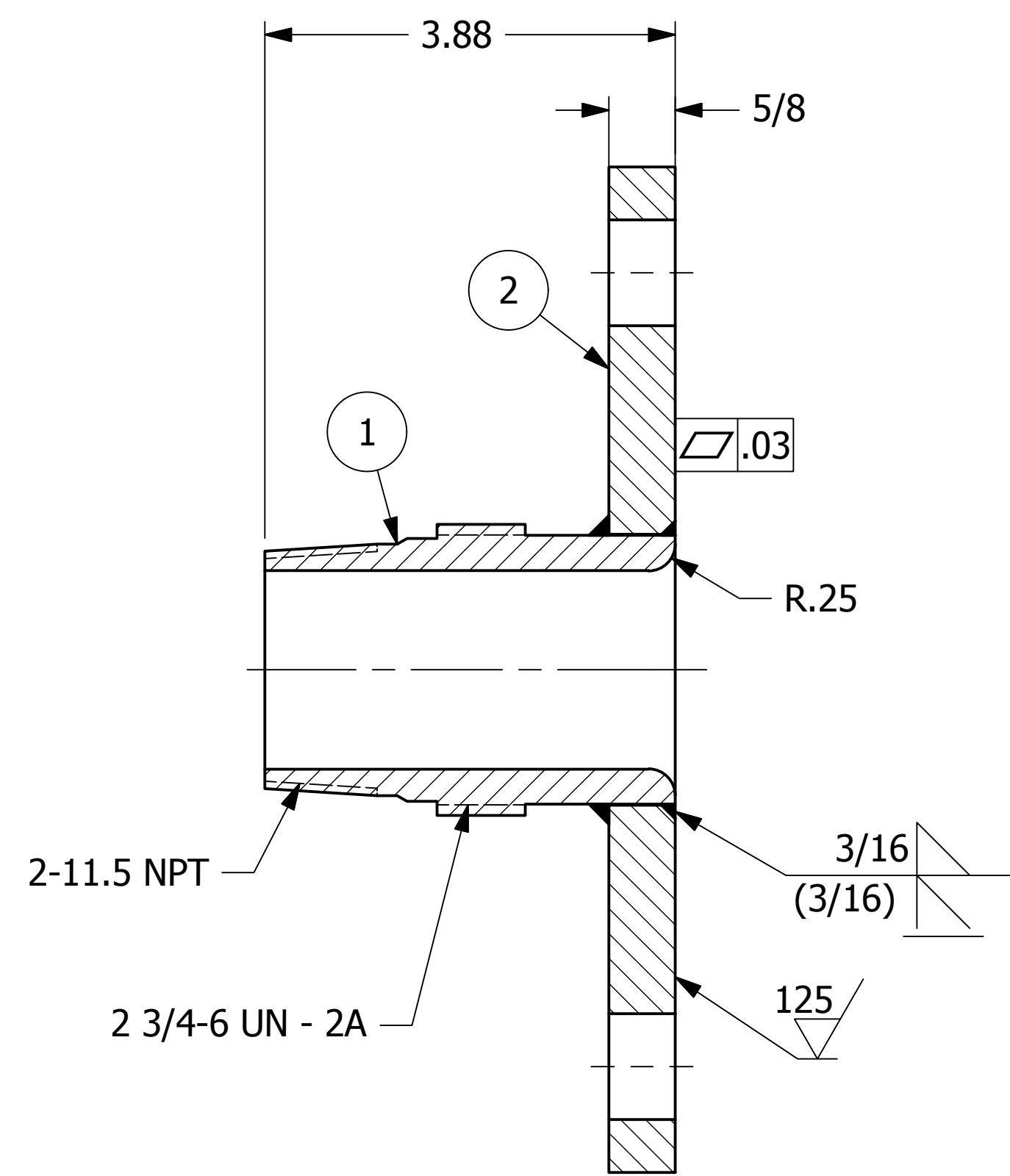
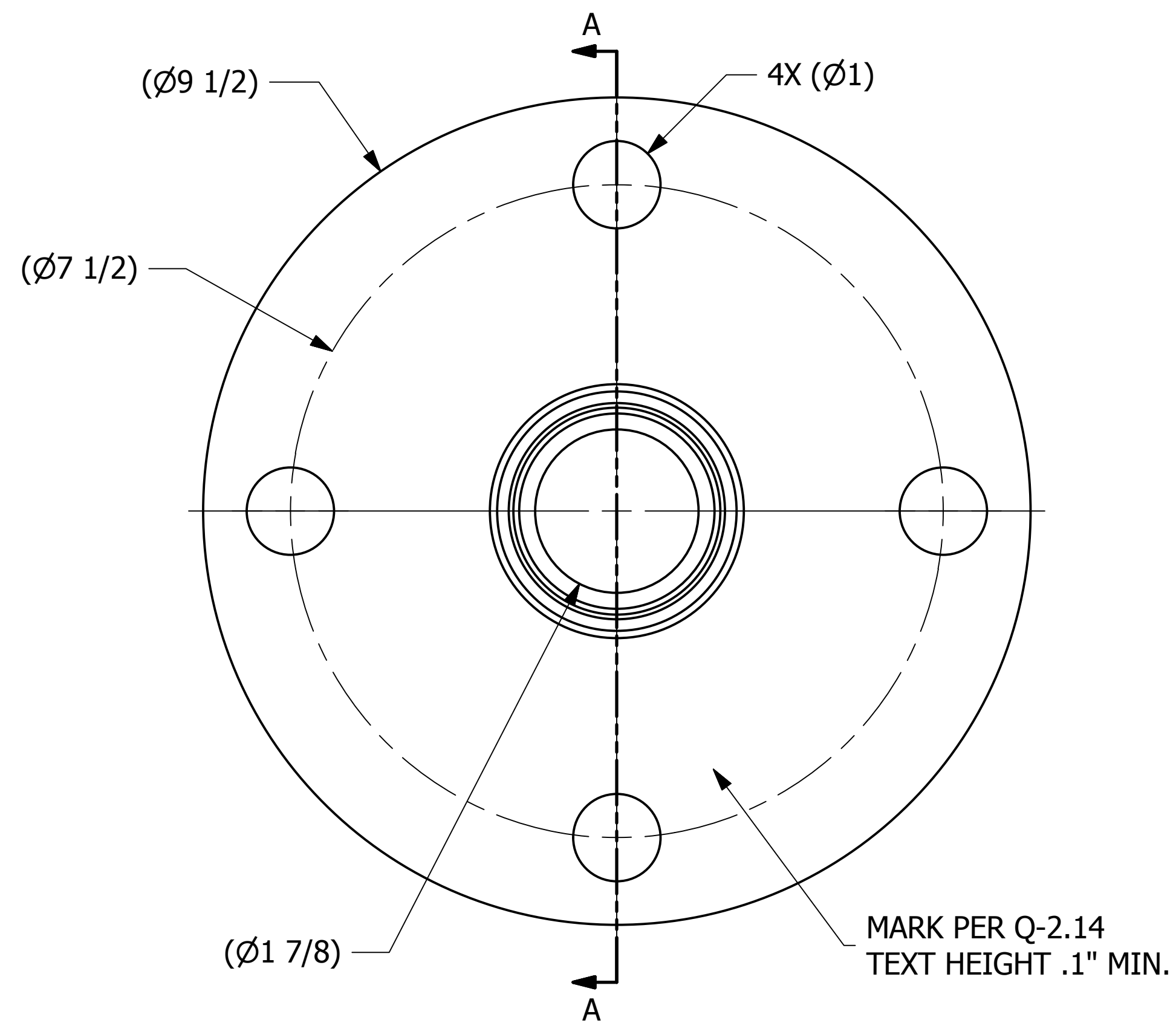

SECTION A-A

REV	BY	DATE	DESCRIPTION
E	WEB	5-23-19	Q-2.14 WAS QAP5A-1; Q-2.15.7 WAS QAP4C-1; UPDATED WELD NOTE TO WPS-F03, WPS-F05, WPS-M07, OR WPS-T06 ; ADDED D-005 NOTE; UPDATED WELDS
D	GS	8-7-13	DRAWING REVERTED TO REV B
C	TAK	5-13-13	REPLACED TE2S75FASC W/ TE2S75FASNT
B	REH	10-20-11	UPDATED HEAT/LOT NOTE
A	CHL	9-29-09	ADDED BOM & MACHING DIMENSIONS

- NOTES.
1. SEE DOCUMENT WPS-F03, WPS-F05, WPS-M07, OR WPS-T06 FOR WELDING PROCEDURES.
 2. WELD ACCEPTANCE CRITERIA TO MEET DOCUMENT D-005.
 3. TEST PER Q-2.15.7.
 4. SEE DOCUMENT Q-2.14 FOR MARKING PROCEDURE.
 5. FLANGE GASKET FACE TO BE FREE OF WELD SPATTER.

UNLESS OTHERWISE SPECIFIED DIMENSIONAL TOLERANCES FRACTIONAL: $\pm 1/16$	DRAWN BY:	CHL
X.XX: $\pm .03$	CHECKED BY:	ACC
X.XXX: $\pm .015$	PROTOTYPE BY:	CHL
ANGLE: $\pm 1^\circ$	PROTOTYPE DATE:	11/16/2002
DEBURR ALL SHARP EDGES. ALL MACHINED SURFACES TO HAVE A 125 RMS FINISH UNLESS NOTED OTHERWISE.	APPROVED FOR PRODUCTION BY:	ACC
THIRD ANGLE PROJECTION	PRODUCTION DATE:	11/16/2002



PART NAME: TOP FITTING FLANGE 2"		
MATERIAL: SEE BOM		
PROJECT #: 020909	SHEET #: 1 OF 1	SCALE: 1:1
DRAWING #: C17286	PART #:	TE2S75FAS