

SECTION A-A

NOTE:  
CASTINGS ARE 316L SS GRADE CF-3M ASTM# A743.

NO.	PART NAME	PART #	REQ'D	MATERIAL
1	QUICK CONNECT 2" FLANGED	TE2SFAS	1	316L SS
2	QUICK CONNECT CAP 2" THREAD ON	TE20SDLPDC07A	1	316L SS

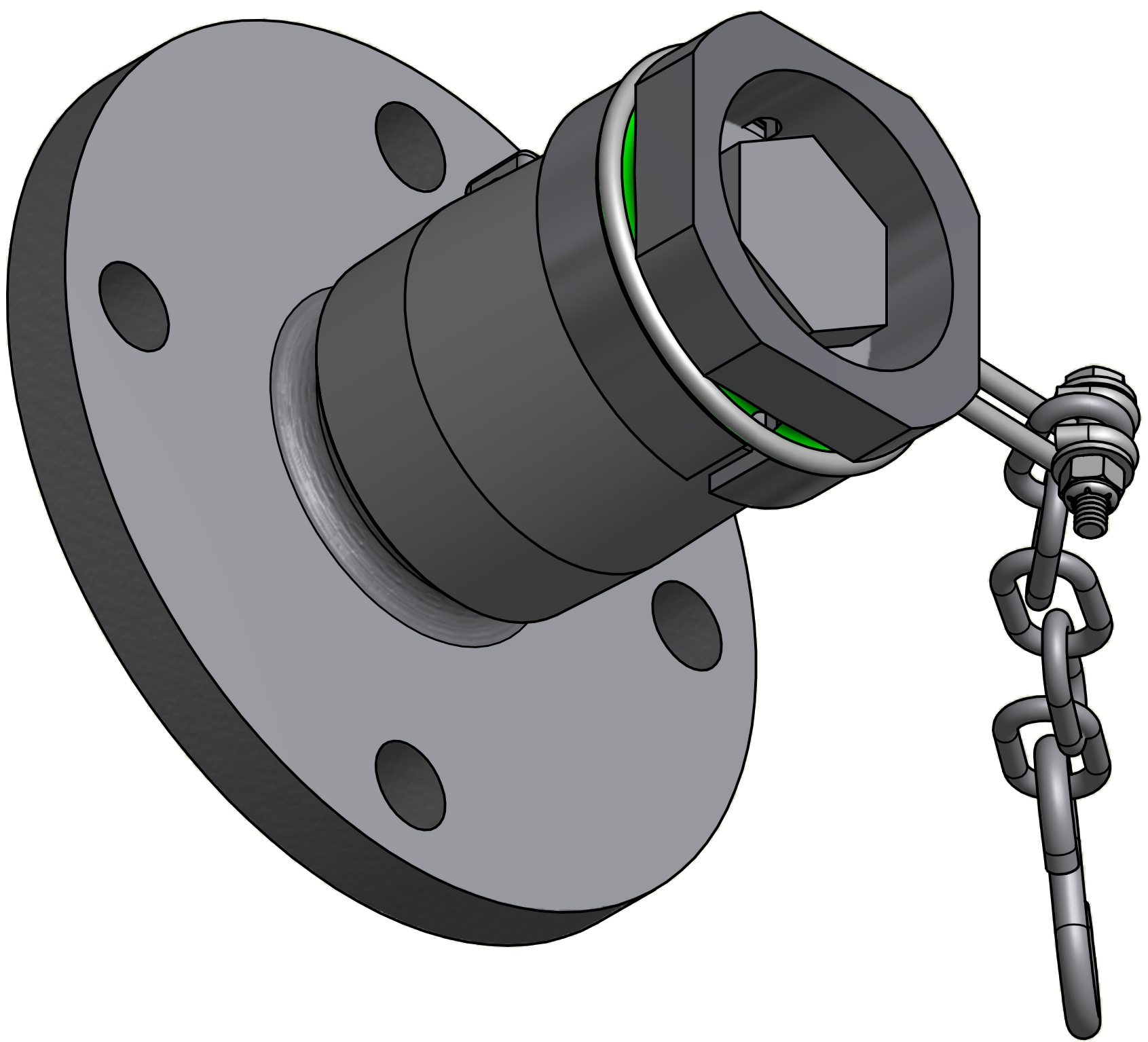

ISOMETRIC VIEW  
SCALE 1 : 1

B	GS	8-22-12	UPDATED ASSEMBLY LEVELS
A	GS	5-31-12	DRAWING ADDED TO NETWORK.
REV	BY	DATE	DESCRIPTION
<div><div><div><div><div></div><div>SALCO PRODUCTS, INC.</div></div></div><div>PART NAME: TOP FITTING ASSEMBLY 2" FLANGED</div><div>MATERIAL: SEE BOM/NOTE</div><div>PROJECT #: 120505SHEET #: 1 OF 1SCALE: 1:2</div><div>DRAWING #: C33155PART #: TE20SDLP07FA</div></div></div>			

UNLESS OTHERWISE SPECIFIED DIMENSIONAL TOLERANCES FRACTIONAL: ±1/16 X.XX: ±.03 X.XXX: ±.015 ANGLE: ±1° DEBURR ALL SHARP EDGES. ALL MACHINED SURFACES TO HAVE A 125 RMS FINISH UNLESS NOTED OTHERWISE.	DRAWN BY:	GS
	CHECKED BY:	CHL
	PROTOTYPE BY:	GS
	PROTOTYPE DATE:	5/7/2012
	APPROVED FOR PRODUCTION BY:	CHL
	PRODUCTION DATE:	5/31/2012
THIRD ANGLE PROJECTION		