

NO.	PART NAME	PART#	REQ'D	MATERIAL
1	COMPRESSION FITTING ELBOW 1/4"	LD25M90	3	BRASS
2	BULKHEAD COUPLING 1/4"	CPLGBH025B	3	BRASS
3	FLAT WASHER 3/4" SAE	WASH34SAE	3	CS Z/P
4	FLAT WASHER 3/4"	WASH3404	3	BLACK NEOPRENE
5	JAM HEX NUT 3/4"-16	JN34FB	3	BRASS
6	PIPE NIPPLE 1/4"	N025CB	3	BRASS
7	QUICK DISCONNECT PLUG 1/4"	LDHCMB	6	BRASS
8	QUICK DISCONNECT COUPLER 1/4"	LDHCFB	6	BRASS
9	COMPRESSION FITTING 1/4"	LD25M	7	BRASS
10	COILED HOSE 1/4"	LDCH12	3	NYLON
11	HEX BUSHING 1/4" X 1/8"	RB025X0125B	3	BRASS
12	PIPE NIPPLE 1/8"	N0125CB	3	BRASS
13	AIR SWITCH BRACKET	LDPTOB	1	ALUMINUM
14	HEX BOLT 1/4"-20X1"	BLT14X1S	4	18-8 SS
15	HEX LOCK NUT 1/4"-20	HCN20S	4	18-8 SS
16	LOAD DIVERTER 3 POSITION SWITCH	LDPTOS3PA	1	VARIOUS
17	HEX BUSHING 3/4"X1/4"	LDHB	1	BRASS
18	LOAD DIVERTER HATCH COVER LABEL	LDDLD	1	VINYL
19	CABLE TIE 3/16"X8"	LAL20T	20	NYLON
20	TUBE 1/4"	LDT	50'	BLACK NYLON
21	TUBE 1/4"	LDTBU	50'	BLUE NYLON
22	TUBE 1/4"	LDTRD	50'	RED NYLON

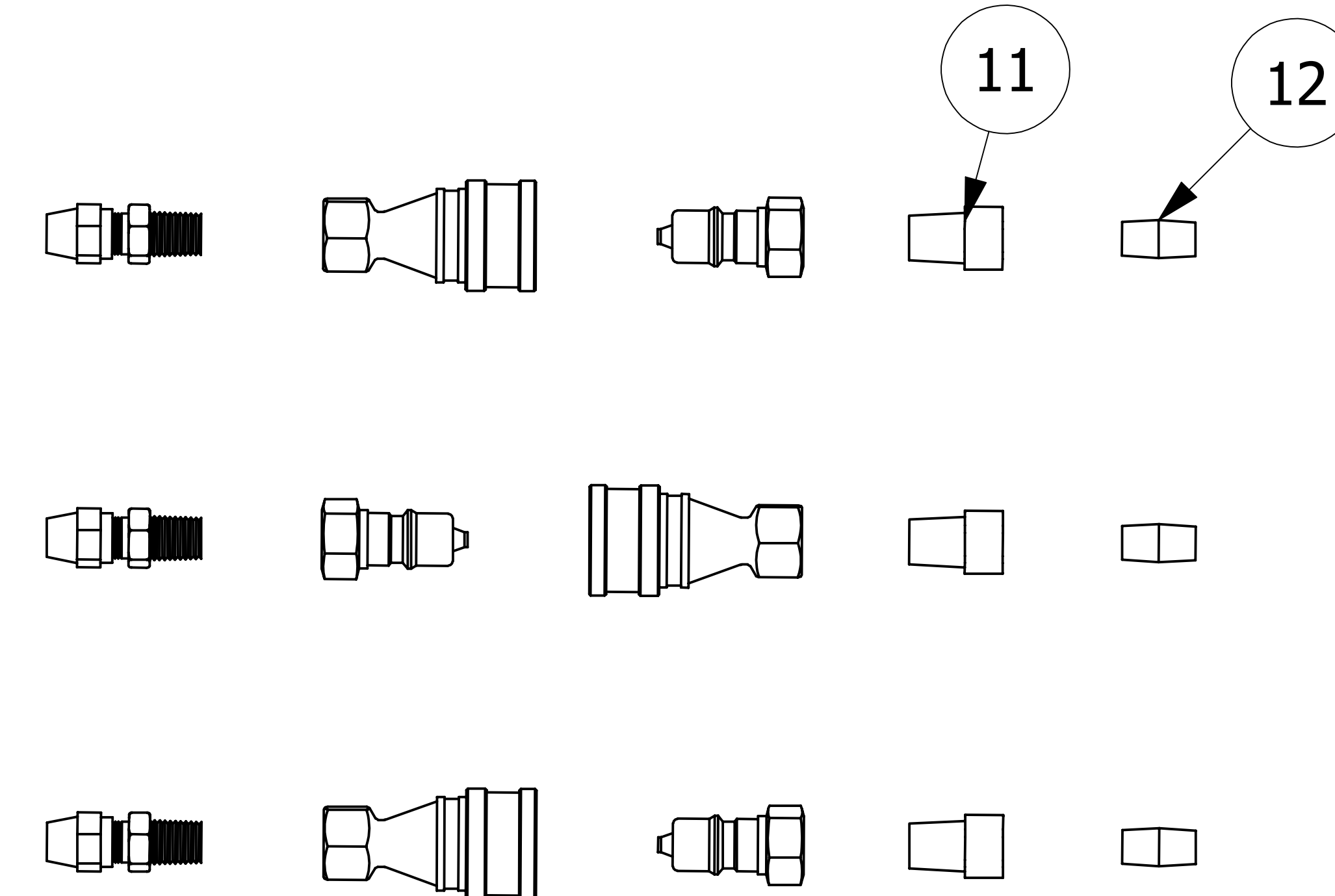
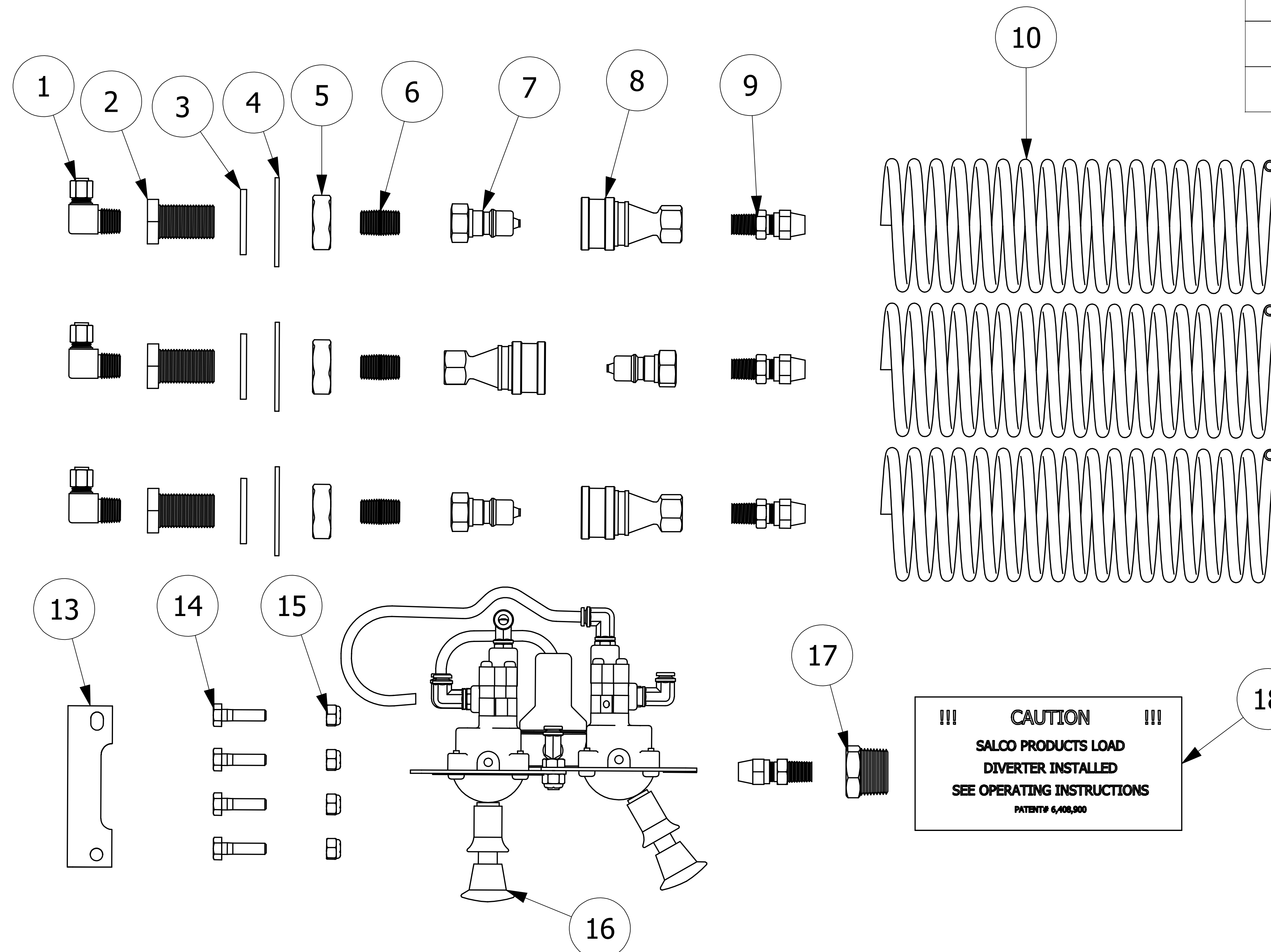
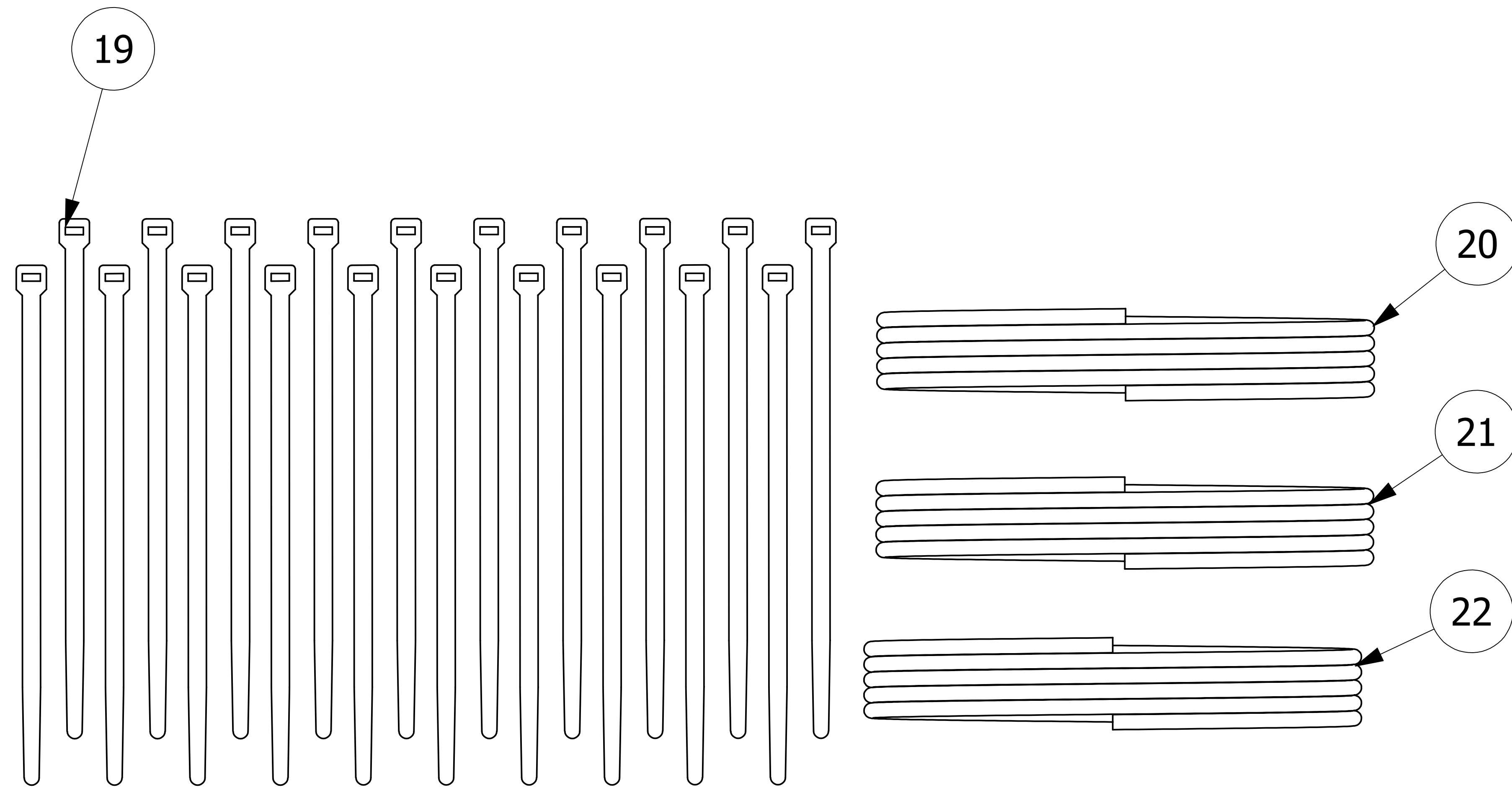

**!!! CAUTION !!!**  
**SALCO PRODUCTS LOAD**  
**DIVERTER INSTALLED**  
**SEE OPERATING INSTRUCTIONS**  
PATENT # 6,408,900

C	WEB	10-4-16	REPLACED 36' OF LDCH WITH 3X LDCH12
B	WEB	1/7/14	UPDATED TO CURRENT DRAFTING STANDARDS
A	PJG	5-5-06	NEW PART ADDED TO SYSTEM
REV	BY	DATE	DESCRIPTION

UNLESS OTHERWISE SPECIFIED DIMENSIONAL TOLERANCES FRACTIONAL: ±1/16 X.XX: ±.03 X.XXX: ±.015 ANGULAR: ±1° DEBURR ALL SHARP EDGES. ALL MACHINED SURFACES TO HAVE A 125 RMS FINISH UNLESS NOTED OTHERWISE. THIRD ANGLE PROJECTION	DRAWN BY: PJG
	CHECKED BY:
	PROTOTYPE BY: PJG
	PROTOTYPE DATE: 12/2/2005
	APPROVED FOR PRODUCTION BY: PJG
	PRODUCTION DATE: 4/19/2006

**SALCO PRODUCTS, INC.**

**LOAD DIVERTER MANUAL 3 POSITION KIT**

**SEE BOM**

PROJECT #: 050114 SHEET #: 1 OF 1 SCALE: 3:4

DRAWING #: **E21296** PART #: **LDM3PTKP2**