

NO.	PART NAME	PART #	REQ'D	MATERIAL
1	CONTROL TUBE	SP111CTU	1	ALUMINUM
2	ROLL PIN 3/32" X 1/2"	RP33215S	8	18-8 SS
3	INSERT FOR SALCO CONTROL TUBE	CTU111LIS3	4	303 SS

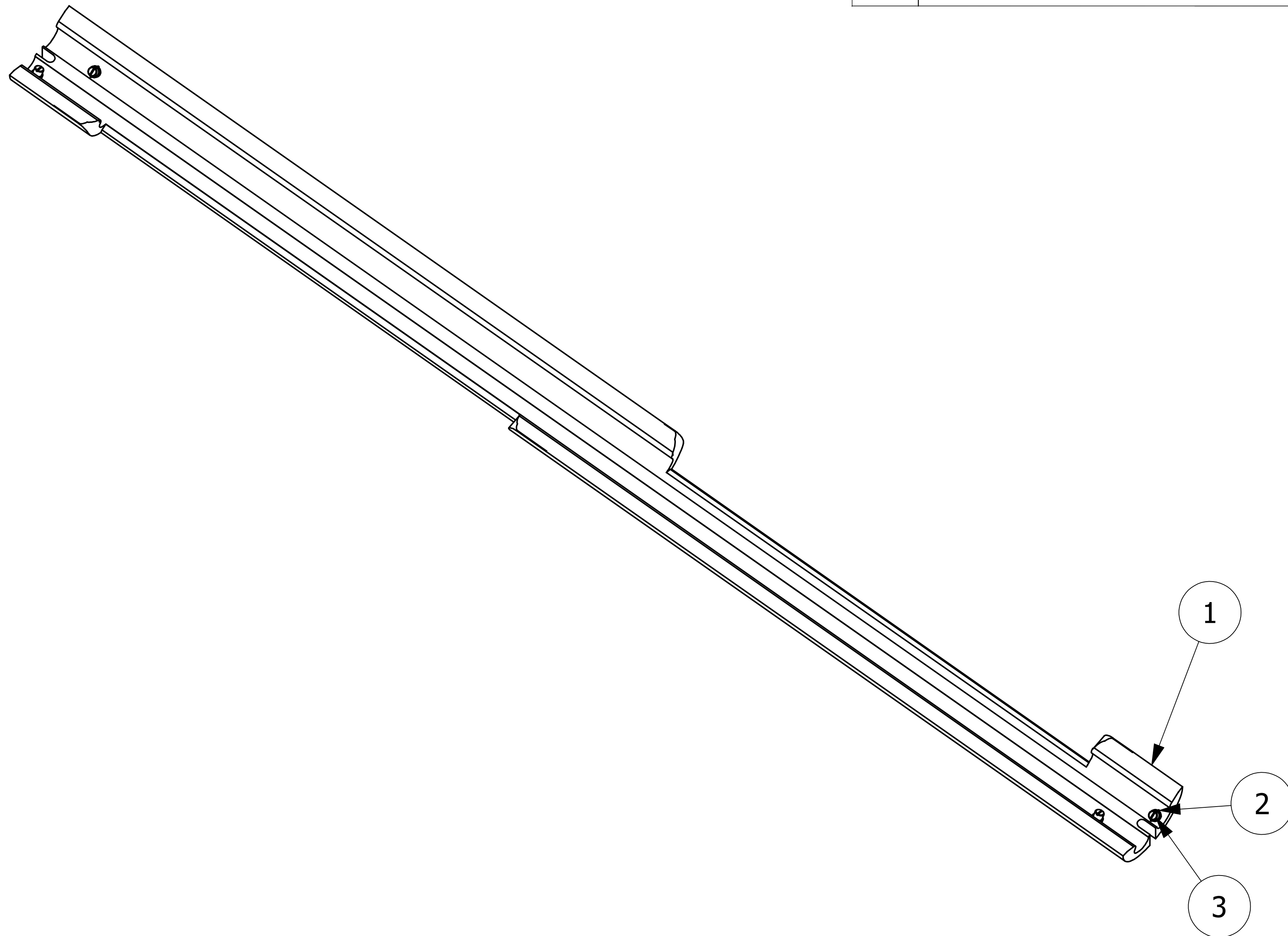

REV	BY	DATE	DESCRIPTION
B	GS	5-14-12	UPDATED TO INVENTOR
A	PJG	9-5-07	REPLACED RP332 WITH RP33215S

UNLESS OTHERWISE SPECIFIED DIMENSIONAL TOLERANCES FRACTIONAL: ±1/16 X.XX: ±.03 X.XXX: ±.015 ANGULAR: ±1° DEBURR ALL SHARP EDGES. ALL MACHINED SURFACES TO HAVE A 125 RMS FINISH UNLESS NOTED OTHERWISE. THIRD ANGLE PROJECTION	DRAWN BY:	AAC
	CHECKED BY:	AAC
	PROTOTYPE BY:	AAC
	PROTOTYPE DATE:	3/6/2001
	APPROVED FOR PRODUCTION BY:	AAC
	PRODUCTION DATE:	3/6/2001

SALCO PRODUCTS, INC.

CONTROL TUBE ASSEMBLY

MATERIAL: **SEE BOM**

PROJECT #: **010306** SHEET #: **1 OF 1** SCALE: **1:4**

DRAWING #: **D15523** PART #: **SP111CTUA**

THIS PRINT, PROPERTY OF SALCO PRODUCTS INC. CONTAINS PROPRIETARY INFORMATION AND MUST NOT BE COPIED, REPRODUCED, OR USED DETRIMENTALLY TO OUR INTEREST.