

2

1

NO.	PART NAME	PART #	REQ'D	MATERIAL
1	HEX BOLT 1/2"-13X2 1/2"	HB70213	16	18-8 SS
2	HEX BOLT 3/8"-16 X 1 1/4"	HB70107	16	18-8 SS
3	FLAT WASHER 1/2"	TSW916	32	18-8 SS
4	FLAT WASHER 3/8"	RP103MW	32	18-8 SS
5	HEX LOCK NUT 1/2"-13	TN20LN	16	CS Z/P
6	HEX LOCK NUT 3/8"-16	EA111N	16	CS Z/P

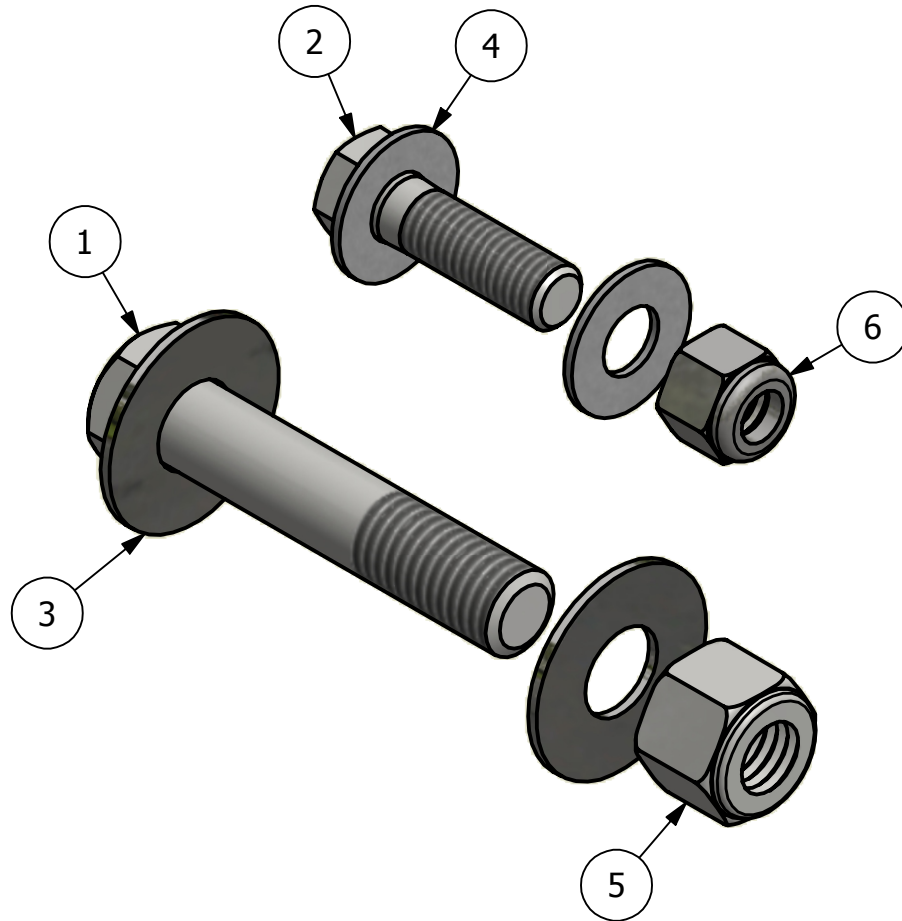

F	JG	3-30-15	UPDATED TITLEBLOCK, HB70107 DESCRIPTION IN BOM WAS 2"
E	REH	4-26-11	REPLACED PRB17CBS W/ HB70213
D	CHL	8-17-04	ADDED THE REQ'D FIELD TO THE BOM
C	CHL	4-21-03	REPLACED 306-007700N W/ HB70107
B	ACC	2-15-02	NUTS WERE 18-8 SS, 306-007700N WAS RP103MS
A	ACC	12-6-01	ADDED 3/8" FASTENERS AND WASHERS
REV	BY	DATE	DESCRIPTION

UNLESS OTHERWISE SPECIFIED
DIMENSIONAL TOLERANCES
FRACTIONAL: $\pm 1/16$
X.XX: $\pm .03$
X.XXX: $\pm .015$
ANGULAR: $\pm 1^\circ$
DEBURR ALL SHARP EDGES.
ALL MACHINED SURFACES TO
HAVE A 125 RMS FINISH
UNLESS NOTED OTHERWISE.

THIRD ANGLE PROJECTION

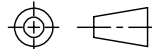

DRAWN BY:	CHL
CHECKED BY:	ACC
PROTOTYPE BY:	CHL
PROTOTYPE DATE:	10/18/2001
APPROVED FOR PRODUCTION BY:	ACC
PRODUCTION DATE:	10/18/2001



SALCO PRODUCTS, INC.

PART NAME:

PD 1 PAD BOLT KIT

MATERIAL: **SEE BOM**

PROJECT #: **010725**

SHEET #: **1 OF 1**

SCALE: **1:1**

DRAWING #:

A16302

PART #:

PD1PADKIT1

2

1