

NO.	PART NAME	PART#	REQ'D	MATERIAL
1	DUAL TORSION SPRING	C35206	1	17-7 SS
2	BUSHING	A35209	2	CS Z/P
3	TOP LOCK NUT 7/8" - 9	LN70804	1	18-8 SS
4	HEX BOLT 7/8" - 9 X 18"	HB11441	1	CS Z/P
5	EYEBOLT 5/8"-11 X 1 1/2"	A35210	2	18-8 SS
6	ANGLE BRACKET	A35211	2	304/316 SS
7	TOP LOCK NUT 5/8" - 11	LN77802	2	316 SS

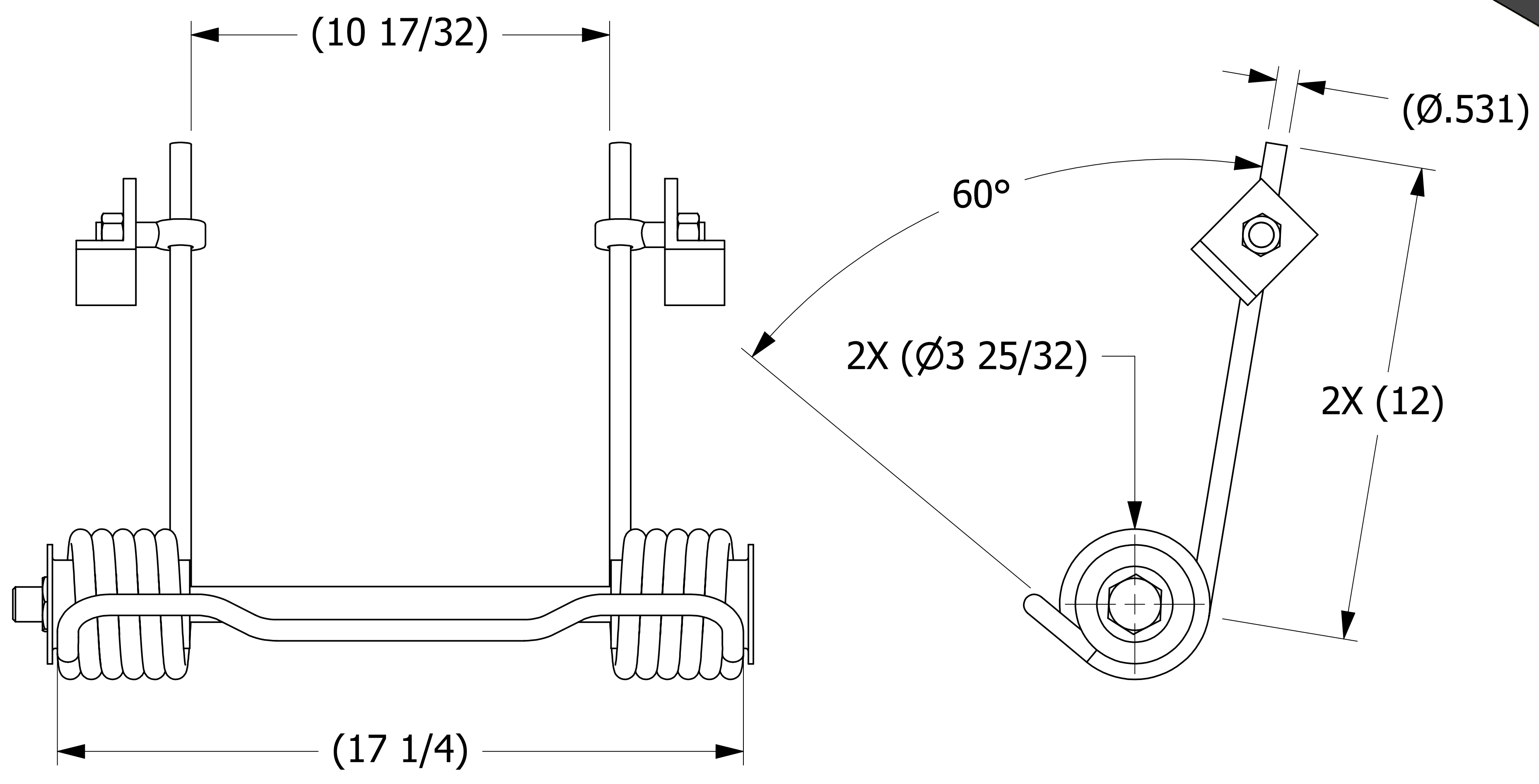
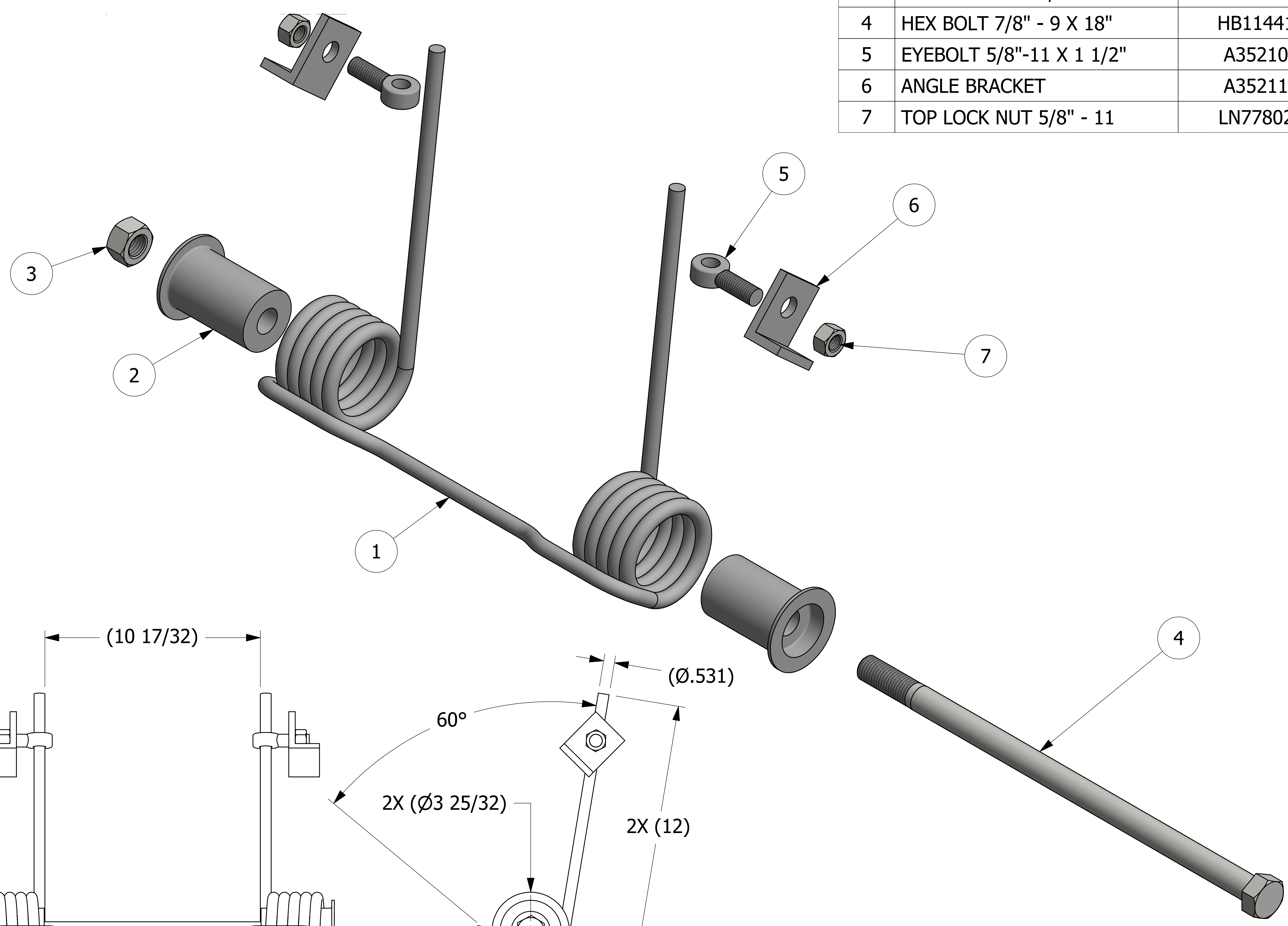

**NOTES:**  
 1. FITS ON ACF 30" HOUSING STYLE COVER.  
 2. APPROX. TORQUE @ 60° DEFLECTION: 325 FT-LBS.

A	VD	08-19-13	RELEASED FOR PRODUCTION.
REV	BY	DATE	DESCRIPTION

UNLESS OTHERWISE SPECIFIED DIMENSIONAL TOLERANCES FRACTIONAL: ±1/16 X.XX: ±.03 X.XXX: ±.015 ANGULAR: ±1° DEBURR ALL SHARP EDGES. ALL MACHINED SURFACES TO HAVE A 125 RMS FINISH UNLESS NOTED OTHERWISE. THIRD ANGLE PROJECTION	DRAWN BY:	VD
	CHECKED BY:	WRB
	PROTOTYPE BY:	VD
	PROTOTYPE DATE:	1/24/2013
	APPROVED FOR PRODUCTION BY:	VD
PRODUCTION DATE:	8/19/2013	

**SALCO PRODUCTS, INC.**

**LIFT ASSIST**

**SEE BOM**

PROJECT #:	121207	SHEET #:	1 OF 1	SCALE:	3:4
DRAWING #:	E35212	PART #:	LAD30ACF2		