

NO.	PART NAME	PART#	REQ'D	MATERIAL
1	ID PLATE 3" X 3/4"	A15152	.5	ALUMINUM
2	DRIVE SCREW TYPE U #2 X 1/8"	DR218	2	18-8 SS
3	FLANGE GASKET	FG5507	1	VITON B
4	SURGE PROTECTOR	HSSPRD33S6	1	316 SS
5	QI RETAINER GASKET	QI261DG7	1	BLACK VITON B
6	QI RUPTURE DISK GASKET	QI261RDG7	1	BLACK VITON B
7	QUICK INSPECT BODY	QI261S6B	1	316 SS
8	RETAINER DISC ASSY QI	QI261S6RDS7A	1	SEE DWG
9	QUICK INSPECT CAP ASSEMBLY	QI261S6TCA	1	316 SS
10	RUPTURE DISC (SOLD SERARATELY)			

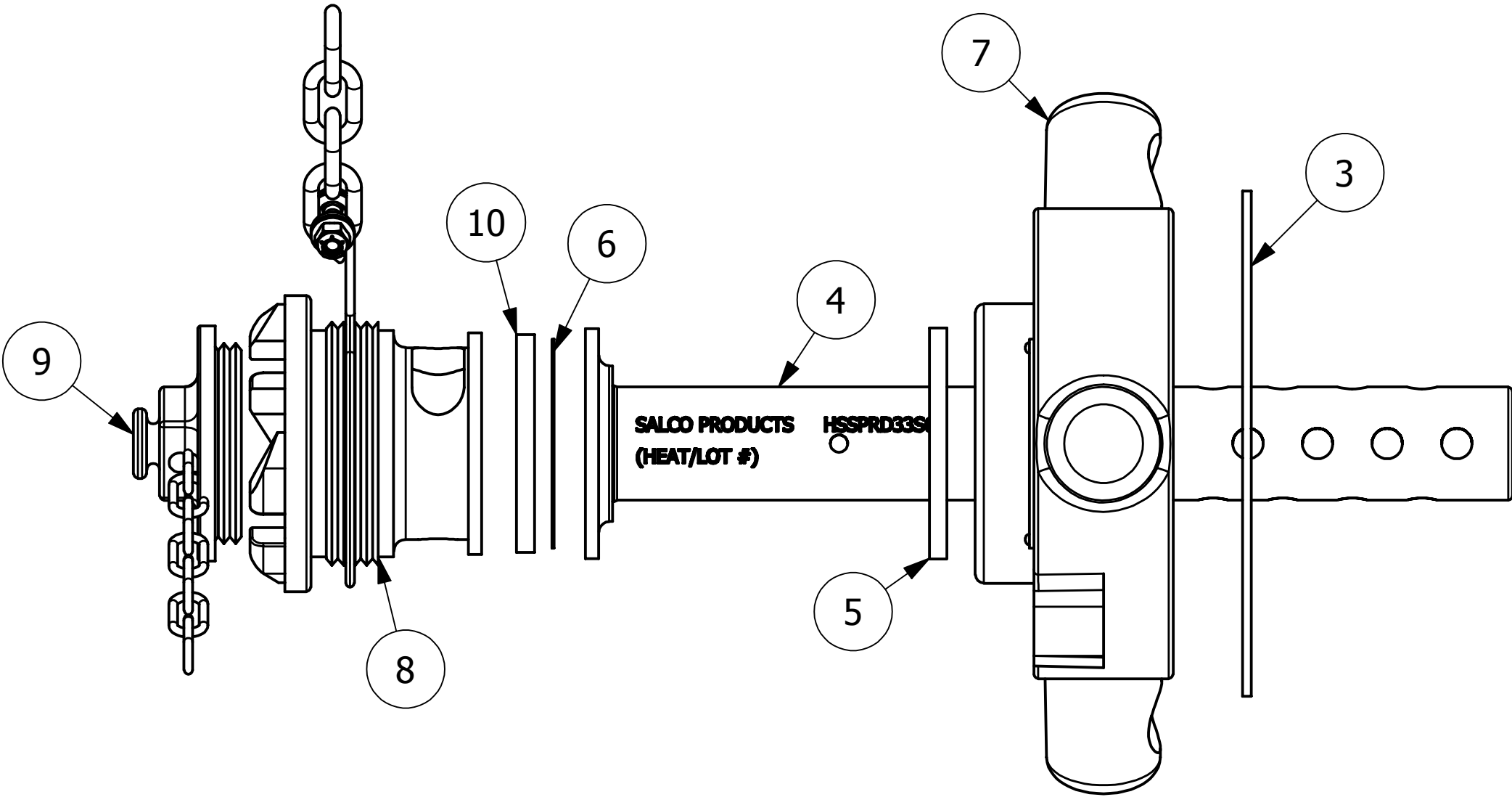

- NOTES:
1. CUSTOMERS RESPONSIBILITY FOR COMPATIBILITY OF COMMODITY.
 2. AAR APPROVAL # PRD-162102.
 3. SEE DOCUMENT QAP5A-1 FOR MARKING PROCEDURE.
 4. FASTEN ID PLATE WITH DRIVE SCREWS.

UNLESS OTHERWISE SPECIFIED
DIMENSIONAL TOLERANCES
FRACTIONAL: $\pm 1/16$
X.XX: $\pm .03$
X.XXX: $\pm .015$
ANGLE: $\pm 1^\circ$
DEBURR ALL SHARP EDGES.
ALL MACHINED SURFACES TO
HAVE A 125 RMS FINISH UNLESS
NOTED OTHERWISE.

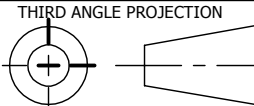

DRAWN BY:	REH
CHECKED BY:	VD
PROTOTYPE BY:	REH
PROTOTYPE DATE:	3/1/2011
APPROVED FOR PRODUCTION BY:	VD
PRODUCTION DATE:	8/10/2011

B	JG	2-8-17	AAR APPROVAL # WAS SRD-063000; UPDATED VIEWS, NOTES; ADDED A15152, DR218
A	SMA	8-10-11	NEW DRAWING ADDED TO SYSTEM
REV	BY	DATE	DESCRIPTION
SALCO PRODUCTS, INC.			
PART NAME: QUICK INSPECT VENT SAFETY ASSEMBLY			
MATERIAL: SEE BOM			
PROJECT #: 110301		SHEET #: 1 OF 1	SCALE: 1:2
DRAWING #: C30311		PART #: QI261S607A2	